



14 x 10 SILVERTON PERGOLA

Model # 1906525

Owner's Manual & Assembly Instructions

MANUFACTURED BY:

Backyard Discovery
3305 Airport Drive
Pittsburg, KS 66762
800-856-4445

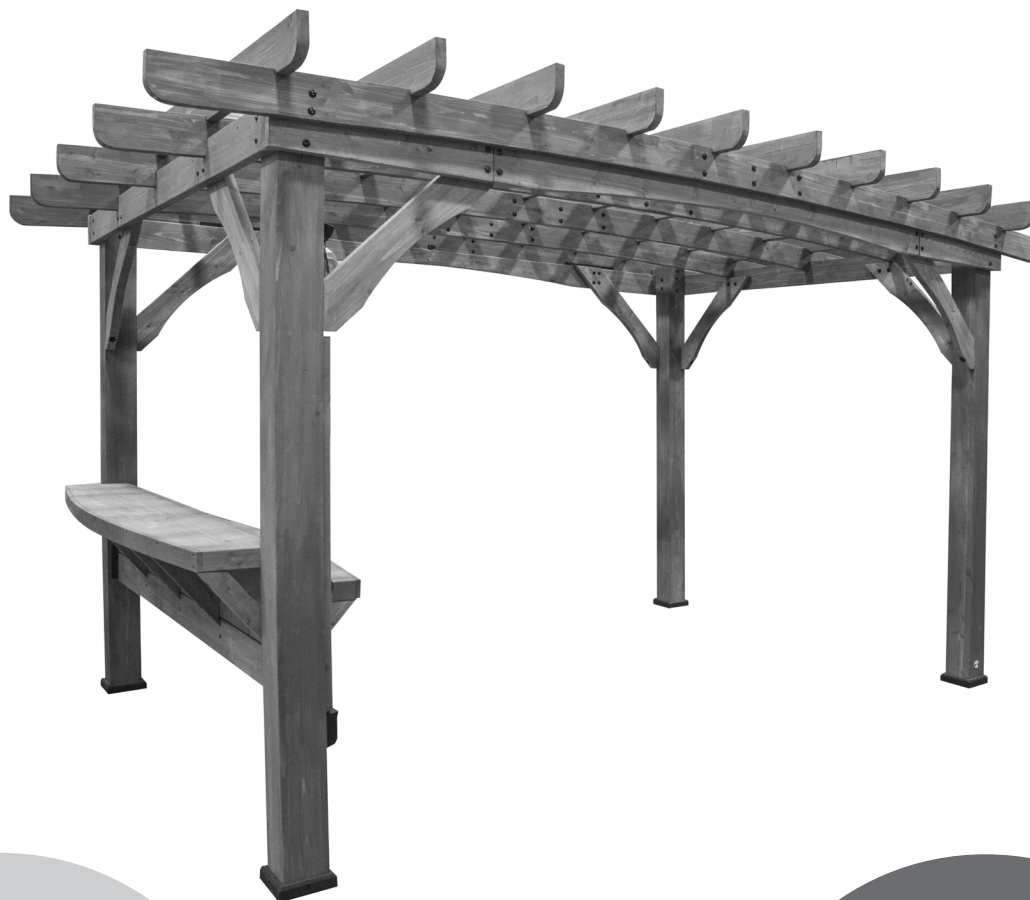

INSTALLATION SERVICES AVAILABLE!*

Need a helping hand?

Let our team of professionals handle the installation for you!

GOCONFIGURE
888-888-5424

*Installation services are only available
to U.S. customers.

average 2 person assembly time



assembly time may vary based on skill level

Before you begin >>>

**FOR QUICK &
EASY ASSEMBLY**
FIND 3D INSTRUCTIONS
FOR THIS PRODUCT IN

BILT.

DOWNLOAD THE FREE APP



For the most up to date assembly manual,
to register your set, or to order replacement parts please visit

www.backyarddiscovery.com

**SAVE THIS ASSEMBLY MANUAL FOR FUTURE REFERENCE IN THE
EVENT THAT YOU NEED TO ORDER REPLACEMENT PARTS.**

Para obtener instrucciones en español, visite www.backyarddiscovery.com



INSTALLATION SERVICES AVAILABLE!*

Need a helping hand?

Let our team of professionals handle the installation for you!

GOCONFIGURE
888-888-5424

**Installation services are only available
to U.S. customers.*

With Go Configure, we bring you 18 years of experience right to your doorstep. We service a wide array of indoor and outdoor recreation products that most consumers don't have the time or ability to deliver & install themselves.

We do the heavy lifting, so you don't have to!

-
- 18+ Years of Experience Servicing Big Box Retailers and Direct Consumers
 - Highly Skilled, Specialized, Courteous, Professional Service Technicians
 - Over 140,000 Installations Annually
 - White Glove Service

- Satisfaction Guarantee
 - Flexible Appointments, including weekends
 - Coverage across the nation
- Visit www.goconfigure.com for more info!**
-

**Installation services are only available to U.S. customers.*



The store where you made your purchase
does not stock parts for this item.
If you have assembly questions or you are missing or
have damaged parts, please call

1-800-856-4445
or visit www.backyarddiscovery.com

Please have the following information ready when you make your call:

- Model Number of the product located on the front of the assembly manual
 - Description of the part from the parts list
-
- Read entire assembly manual, paying special attention to the important tips and safety information.
 - Ensure there are no missing pieces by first separating and identifying all parts.
 - Make sure to check packing material for small parts that may have fallen out during shipment.
 - Structures are not intended for public use. The Company does not warranty any of its residential structures subjected to commercial use.
 - This manual contains helpful information concerning assembly preparation, installation procedure and required maintenance.
 - Always keep safety in mind as your structure is being built.
 - Keep these instructions for future reference.



Please read entire booklet completely before beginning the assembly process

Please retain these instructions and your receipt for future reference. Keep them in a safe place where you can refer to them as needed. In order to provide you with the most efficient service, it is required that you provide us with the part numbers when ordering parts.

For Your Records:

Please take time and fill out the information below. This information will be needed for warranty issues.

Where Purchased: _____
 Date of Purchase: _____
 Installation Date: _____
 Installed by: _____
 Tracking Number: _____

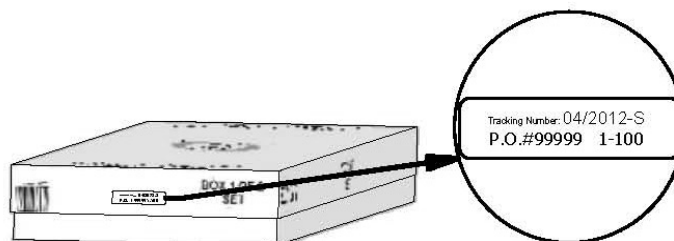

Tracking Number Reference Label

Tracking ID number on the carton and on the bottom of the vertical ID plate are included for tracking purposes associated with warranty claims.

This Limited Warranty by Backyard Discovery applies to products manufactured under the Backyard Discovery brand or its other brands including but not limited to Backyard Botanical, Adventure Playsets, and Leisure Time Products.

Backyard Discovery warrants that this product is free from defect in materials and workmanship for a period of one (1) year from the original date of purchase. This one (1) year warranty covers all parts including wood, hardware, and accessories. All wood carries a five (5) year pro-rated warranty against rot and decay. Refer to the schedule below for charges associated with replacement of parts under this Limited Warranty. In addition, Backyard Discovery will replace any parts within the first 30 days from date of purchase found to be missing from or damaged in the original packaging.

This warranty applies to the original owner and registrant and is non-transferable. Regular maintenance is required to assure maximum life and performance of this product. Failure by the owner to maintain the product according to the maintenance requirements may void this warranty. Maintenance guidelines are provided in the Owner's Manual.

This Limited Warranty does not cover:

- Labor for any inspection
- Labor for replacement of any defective item(s)
- Incidental or consequential damages
- Cosmetic defects which do not affect performance or integrity of a part or the entire product
- Vandalism, improper use, failure due to loading or use beyond the capacities stated in the applicable Assembly Manual.
- Acts of nature including but not limited to wind, storms, hail, floods, excessive water exposure
- Improper installation including but not limited to installation on uneven, unlevel, or soft ground
- Minor twisting, warping, checking, or any other natural occurring properties of wood that do not affect performance or integrity

Backyard Discovery products have been designed for safety and quality. Any modifications made to the original product could damage the structural integrity of the unit leading to failure and possible injury. Modification voids any and all warranties and Backyard Discovery assumes no liability for any modified products or consequences resulting from failure of a modified product.

This product is warranted for RESIDENTIAL USE ONLY. Under no circumstance should a Backyard Discovery product be used in public settings. Such use may lead to product failure and potential injury. Any and all public use will void this warranty. Backyard Discovery disclaims all other representations and warranties of any kind, express or implied.

Pro Rated Part Replacement Schedule

Product Age

All Parts

0-30 days from date of purchase
 31 days to 1 year

Wood Rot and Decay Only

1 year
 2 year
 3 year
 4 year
 5 year
 Over 5 years

Customer Pays

\$0 and free shipping
 \$0 + S&H

\$0 and free shipping
 20% + S&H
 40% + S&H
 60% + S&H
 80% + S&H
 100% + S&H



WARNING

IT IS IMPORTANT TO CHECK AND TIGHTEN ALL HARDWARE AT THE BEGINNING AND DURING THE SEASON AS THEY MAY LOOSEN DUE TO WOOD EXPANSION AND CONTRACTION.

- **DO NOT climb or walk on the roof for any reason**
- **Requires two or more people to assemble safely**
- **Check for underground utilities before digging or driving stakes into the ground.**
- **Check carefully for overhead lines and ensure there is at least 6ft (2m) clearance from any overhead electrical wires.**
- **Permanent structures may require a building permit. As the purchaser and or installer of this product you are advised to consult local planning, zoning and building inspection departments for guidance on applicable building codes and/or zoning requirements.**
- Wood is NOT flame retardant and will burn. Grills, fire pits and chimineas are a fire hazard if place too close to your structure.
- Wear gloves to avoid injury during installation.
- During installation, follow all safety warnings provided with your tools and use safety glasses.
- Check all nuts and bolts twice monthly during the usage season and tighten as required.(But not so tight that you crack the wood) It is particularly important that this procedure be followed at the beginning of each season.
- Oil all metallic moving parts monthly during the usage period.
- Check all coverings for bolts and sharp edges twice monthly during usage season to be certain they are in place. Replace when necessary. It is especially important to do this at the beginning of each new season.
- For rusted areas on metallic members such as hinges, brackets, etc. sand and repaint, using a non lead-based paint meeting the requirements of Title 16 CRF Part 1303.
- Inspect wood parts monthly. The grain of the wood sometimes will lift in the dry season causing splinters to appear. Light sanding may be necessary to maintain a safe environment. Treating your Product with protection (sealant) after sanding will help prevent severe checking/splitting and other weather damage.
- We have applied a waterborne translucent stain to your unit. This is done for color only. Once or twice a year, depending on your climate conditions, you must apply some type of protection (sealant) to the wood of your unit. Prior to the application of sealant, lightly sand any "rough" spots on your set. Please note this is a requirement of your warranty.

OWNERS SHALL BE RESPONSIBLE FOR MAINTAINING THE LEGIBILITY OF THE WARNING LABELS



Your Backyard Discovery structure is designed and constructed of quality materials. As with all outdoor products it will weather and wear. To maximize the enjoyment, safety and life of your structure it is important that you properly maintain it.

About Our Wood

Backyard Discovery uses 100% Cedar (C. Lanceolata) wood. Although we take great care in selecting the best quality lumber available, wood is still a product of nature and susceptible to weathering which can change the appearance of your set.

What causes weathering? Does it affect the strength of my product?

One of the main reasons for weathering is the effects of water (moisture); the moisture content of the wood at the surface is different than the interior of the wood. As the climate changes, moisture moves in or out of the wood, causing tension which can result in checking and or warping. You can expect the following due to weathering. These changes will not affect the strength of the product:

1. Checking is surface cracks in the wood along the grain. A post (4" x 4") will experience more checking than a board (1" x 4") because the surface and interior moisture content will vary more widely than in thinner wood.

2. Warping results from any distortion (twisting, cupping) from the original plane of the board and often happens from rapid wetting and drying of the wood.

3. Fading happens as a natural change in the wood color as it is exposed to sun-light and will turn grey over time.

How can I reduce the amount of weathering to wood product?

1. Your wood product is coated with a water-based stain. Sunlight will break down the coating, so we recommend applying a water repellent or stain on a yearly basis (see your local stain and paint supplier for a recommended product). You must apply some type of protection (sealant) to the wood of your product. **Please note this is a requirement of your warranty.** Most weathering is just the normal result of nature and will not affect safety. However if you are concerned that a part has experienced a severe weathering problem please call our customer service department for further assistance.

2. Inspect wood parts monthly. The grain of the wood sometimes will lift in the dry season causing splinters to appear. Light sanding may be necessary to maintain a safe environment. Treating your Product with protection (sealant) after sanding will help prevent severe checking/ splitting and other weather damage.



Protrusion Hazard

Incorrect

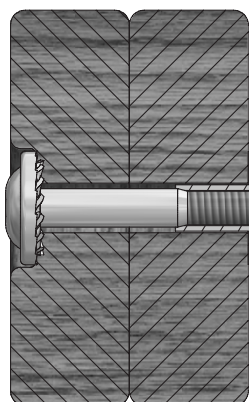

If you see exposed threads and your bolt protrudes beyond the T-Nut you may have over tightened the bolt or used incorrect hardware. If you've overtightened, remove the bolt and add washers to eliminate the protrusion.

Correct

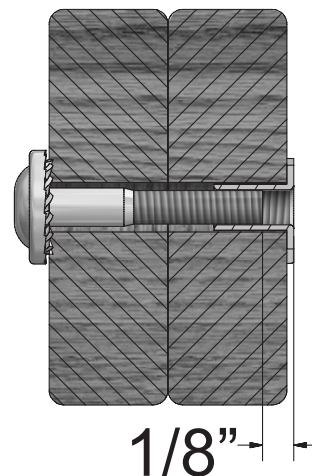

Proper Hardware Assembly

Bolt and T-Nut Assembly

Tap T-nut into the provided hole. Insert your bolt through the lock washer and insert into the provided hole opposite from the T-Nut. Turn clockwise to thread into T-nut. Do not completely tighten until instructed.

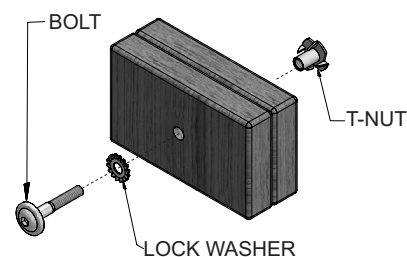

Bolt and Barrel Nut Assembly

Insert barrel nut through the lock washer and press the pair through the provided hole. Insert your bolt through the second lock washer and insert the pair into the provided hole opposite from the barrel nut. Turn clockwise to thread into the barrel nut. Do not completely tighten until instructed.

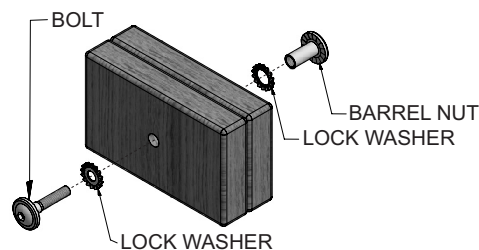

Lag Assembly

Normally there will be a pre-drilled pilot hole on assemblies that require a Lag Screw. If there is no pilot hole, line up the two boards as they are to be attached and use the factory drilled hole as a guide to drill another pilot hole into the adjoining board. This will keep the wood from splitting. Only a lock washer is required for steps with Lag Screws.

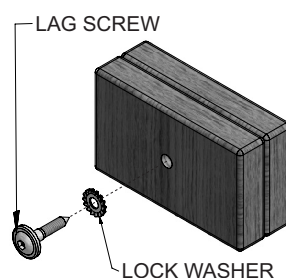



ASSEMBLY TIP:

Keep an eye out for these boxes which will contain helpful pictures and information making the assembly process as quick and painless as possible.

Sorting Wood

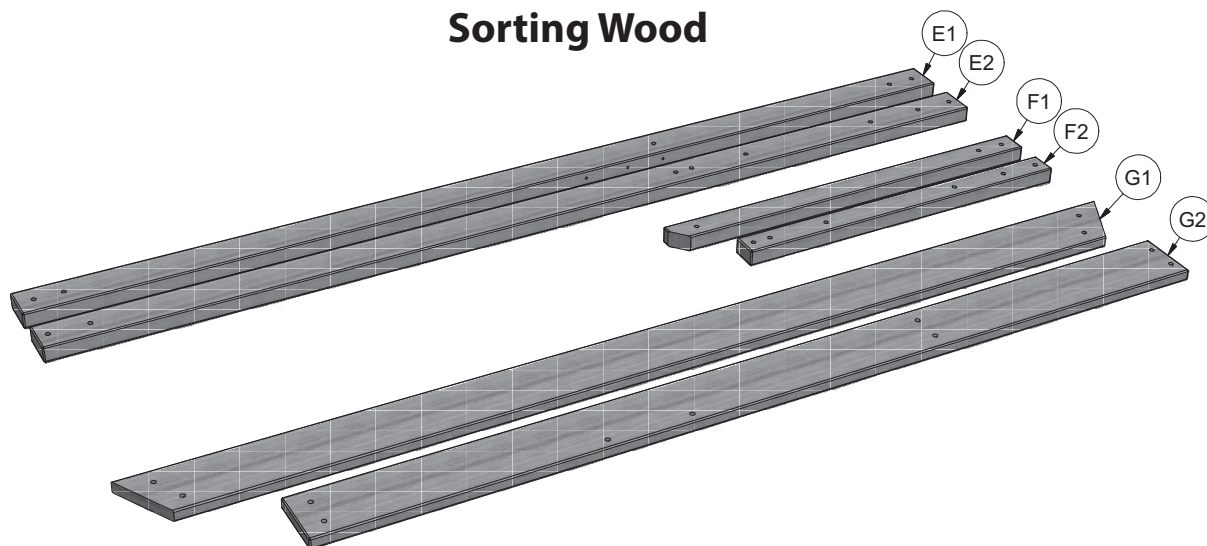

When removing the wood from the boxes we recommend arranging them by part number before you begin assembly. This will allow for faster assembly and easily identify any parts that may be missing or damaged.

Sorting Hardware

NUT BARREL
H100545



SCREW
H100695

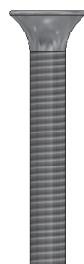

T-NUT
H100699

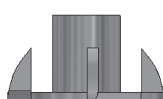

WASHER FLAT
H100706

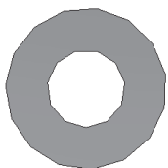

BOLT HEX
H100716

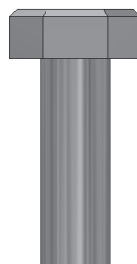

BOLT
H100718



SCREW PWH
H100742



To help with assembly we recommend sorting your hardware bags with the seven digit alpha-numeric number printed on the bags or by hardware type (i.e. bolts, nuts, etc.). Organizing your hardware will make assembly easier.

Hardware Identification

Hardware bags are printed with a seven digit alpha-numeric part number. During assembly you only need to reference the last three digits of the part number as noted in each step. This will make finding the correct hardware easier.

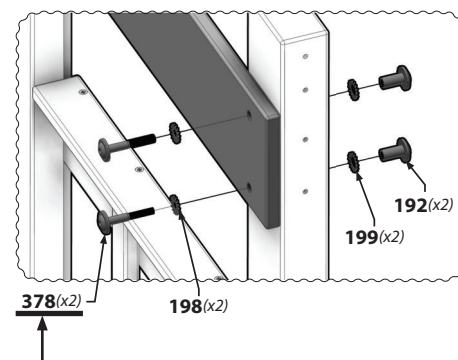
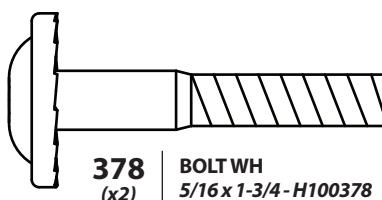



(Level 24")

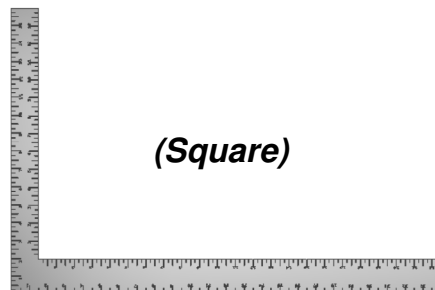

(Square)



(Tape Measure)



(Phillips Screw Driver)



(Rubber Mallet - Optional)

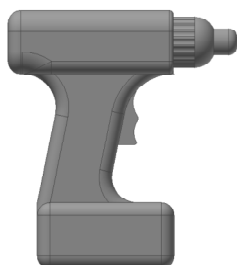

(Cordless Drill or Electric Drill)



(Drill Attachments: Phillips Head, 1/4" & 5/16" Socket Drivers)



(3/16" Concrete Drill Bit)



(An Adult w/ an Adult Helper)



(Ladder)(2)



(Claw Hammer)



It is critically important that you start with square and level footings, concrete pad or deck to attach your structure

- Pay close attention to the items needed for each step. Make sure you are using the correct hardware for each step. Using incorrect hardware may result in improper assembly.
- Remember to double check for underground utilities and overhead electrical lines

Post mounts are provided with your structure which allows you to permanently install your structure to a pre-existing or new wood or concrete surface.

- The hardware to attach the post mounts to the structure is included.
- The hardware to mount the structure permanently to a concrete surface is included.
- The hardware to mount the structure permanently to a wood deck is NOT included and will need to be purchased separately. You must ensure there is ample structural support under the deck before permanently attaching.

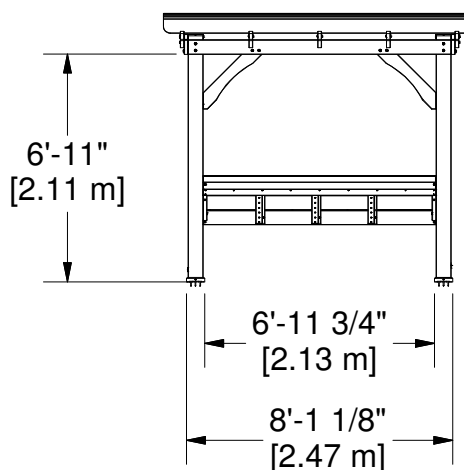
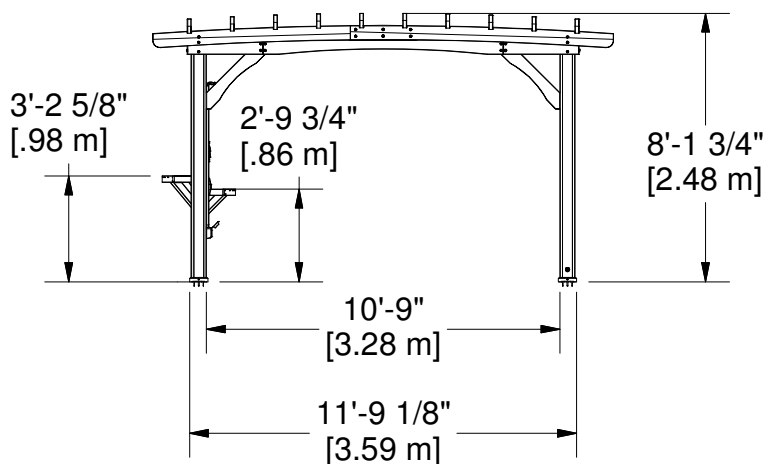
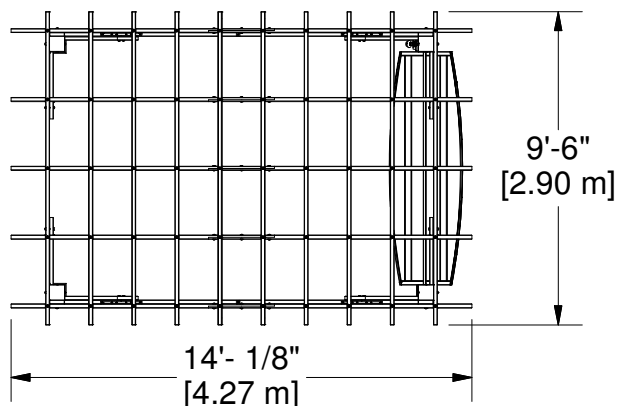
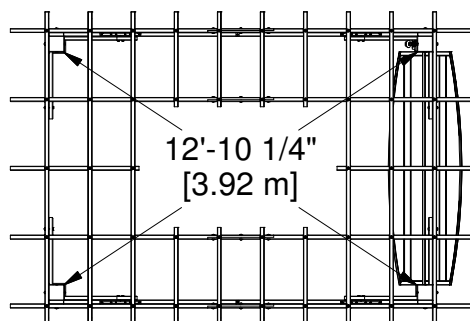

Important Note:

In the event the INK STAMP identifier is not easy to read or is missing from a wood component, match the unique geometric shape and dimensions of the wood component found in a specific assembly step to the PARTS IDENTIFICATION section when required. This will aid in identifying the part for assembly and (or) customer service issues.

Parts Identification

Wood Components

(NOT TO SCALE)

- (10) **D1 - JOIST - W4L11729**
1 3/8"x5 1/4"x114" (36x134x2895)

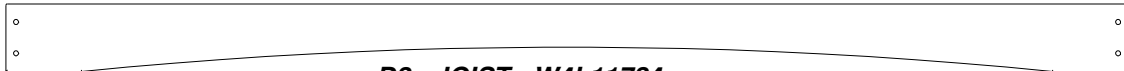

- (2) **D2 - JOIST - W4L11724**
1 3/8"x5 1/4"x87 3/4" (36x134x2228)



- (4) **D3 - JOIST - W4L11723**
1 3/8"x5 1/4"x27 1/2" (36x134x700)



- (2) **D4 - JOIST - W4L11722**
1 3/8"x5 1/4"x96" (36x134x2438)



- (4) **D5 - SHORT ANGLE BRACE - W4L11727**
1 7/16"x5 1/4"x33 5/8" (36x134x854)



- (4) **D6 - LONG ANGLE BRACE - W4L11726**
1 3/8"x5 1/4"x36 3/4" (36x134x933)

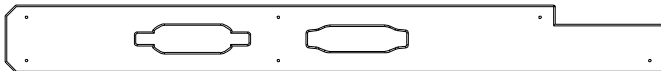

- (1) **D7 - CORD COVER - W4L12268**
1"x5 1/4"x51 5/8" (24x134x1310)



- (2) **F3 - TABLE BRACE - W4L12249**
1 3/8"x2 3/8"x12 13/16" (36x60x325)



- (4) **F1 - SPACER - W4L11730**
1 3/8"x2"x5 1/2" (36x50x140)



- (1) **F2 - TABLE BRACE - W4L12246**
1 3/8"x2 3/8"x11 7/8" (36x60x303)



- (1) **F4 - TABLE BRACE - W4L12325**
1 3/8"x2 3/8"x11 7/8" (36x60x303)



- (3) **G1 - TABLE BRACE - W4L12247**
1"x5 1/4"x16 5/8" (24x134x423)

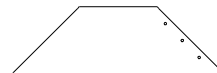

- (3) **G2 - TABLE BRACE - W4L12248**
1"x5 1/4"x16 5/8" (24x134x423)



- (4) **Z1 - JOIST - W4L11725**
1 3/8"x6 1/4"x96 1/8" (36x157x2443)

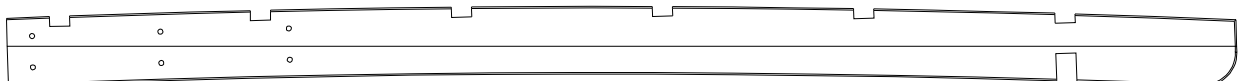

- (6) **Z2 - JOIST - W4L11728**
1 3/8"x6 1/4"x96 1/8" (36x157x2443)

Important Note:

In the event the INK STAMP identifier is not easy to read or is missing from a wood component, match the unique geometric shape and dimensions of the wood component found in a specific assembly step to the PARTS IDENTIFICATION section when required. This will aid in identifying the part for assembly and (or) customer service issues.

Parts Identification

Wood Components

(NOT TO SCALE)

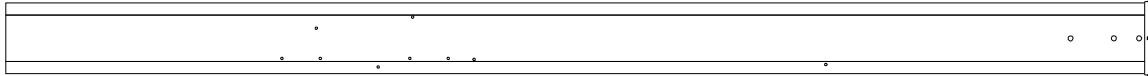

(1) ***PT1 - PERGOLA POST - W2A02730***
5 1/2"x5 1/2"x89 9/16"(140x140x2275)

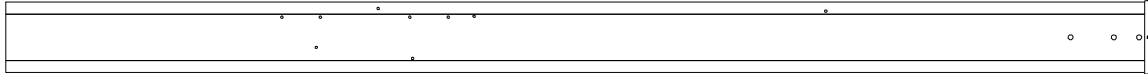

(1) ***PT2 - PERGOLA POST - W2A02561***
5 1/2"x5 1/2"x89 9/16"(140x140x2275)

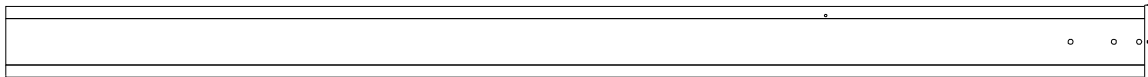

(1) ***PT3 - PERGOLA POST - W2A02731***
5 1/2"x5 1/2"x89 9/16"(140x140x2275)

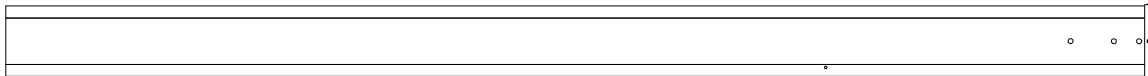

(1) ***PT4 - PERGOLA POST - W2A02562***
5 1/2"x5 1/2"x89 9/16"(140x140x2275)

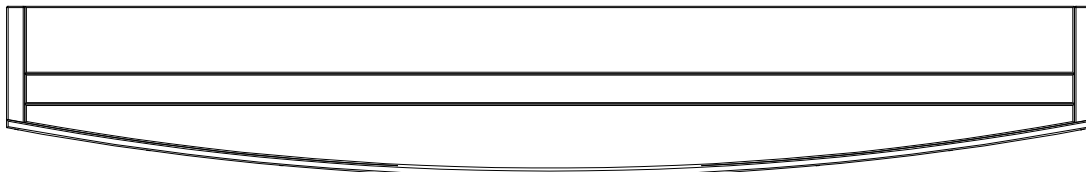

(1) ***TT1 - INSIDE TABLE TOP ASSEMBLY - W2A02564***
2 3/8"x13 3/8"x84 7/8" (60x340x2156)

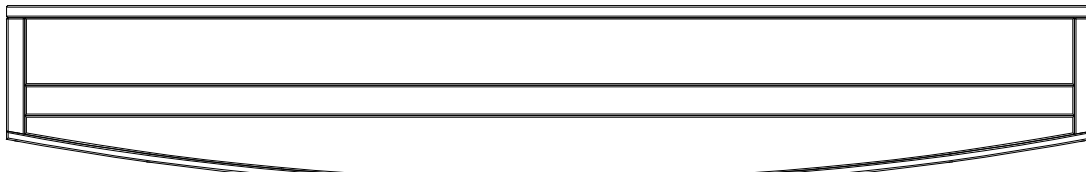

(1) ***TT2 - OUTER TABLE TOP ASSEMBLY - W2A02563***
2 3/8"x14 5/16"x84 7/8" (60x364x2156)

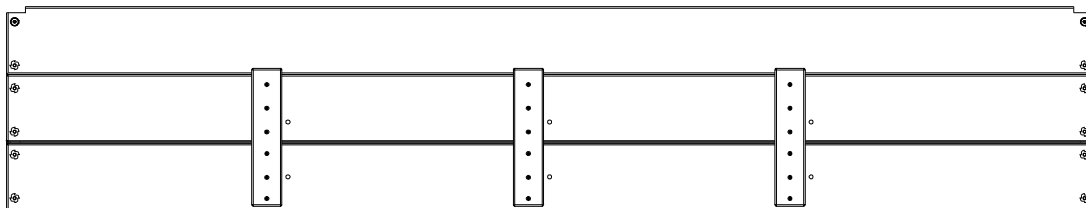

(1) ***WP1 - WALL PANEL - W2A02565***
2 1/2"x15 15/16"x84 7/8" (65x405x2156)

Important Note:

Backyard Discovery recommends taking all the hardware out of the box and arranging them by type before you begin assembly. This will allow for faster assembly and easy identification of any hardware that may be missing or damaged so they can be replaced before assembly.

Parts Identification

Hardware



(17) - CONCRETE ANCHOR 1/4"x2" - H100120

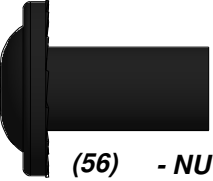

(56) - NUT BARREL WH 5/16x7/8 BLK - H100192

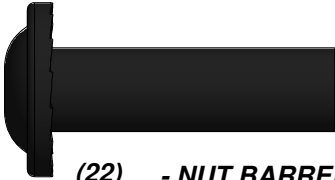

(22) - NUT BARREL WH 5/16x1-1/2 BLK - H100193



(9) - SCREW PFH 8X2-1/2 BLK - H100201



(46) - SCREW PFH 8X1-1/2 BLK - H100200



(44) - SCREW PWH 8x1-1/4 BLK - H100536



(9) - SCREW PWH 8x3/4 BLK - H100392

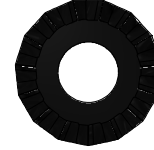

(136) - WASHER LOCK EXT 8x19 BLK - H100198



(78) - WASHER LOCK EXT 12x19 BLK - H100199

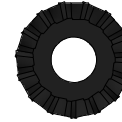

(19) - WASHER LOCK EXT 6x15 BLK - H100405



(7) - T-NUT 1/4 BLK - H100398



(7) - BOLT WH 1/4x2-1/4 BLK - H100567

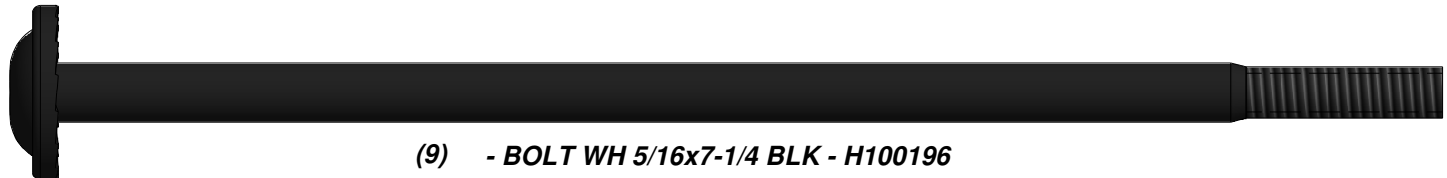

(9) - BOLT WH 5/16x7-1/4 BLK - H100196

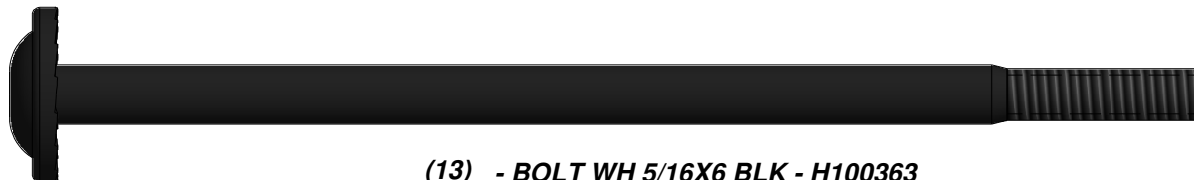

(13) - BOLT WH 5/16X6 BLK - H100363



(26) - BOLT WH 5/16x2-1/4 BLK - H100205

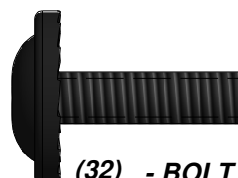

(32) - BOLT WH 5/16x1 BLK - H100468

Important Note:

Backyard Discovery recommends taking all the hardware out of the box and arranging them by type before you begin assembly. This will allow for faster assembly and easy identification of any hardware that may be missing or damaged so they can be replaced before assembly.

Parts Identification *Hardware*

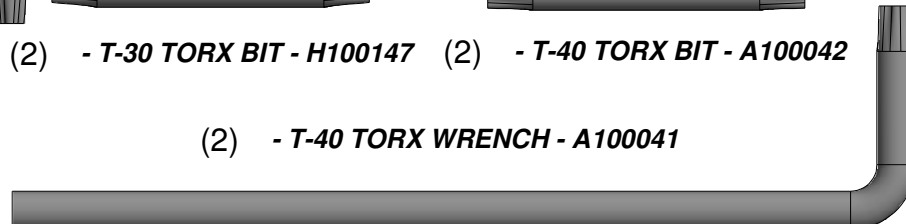
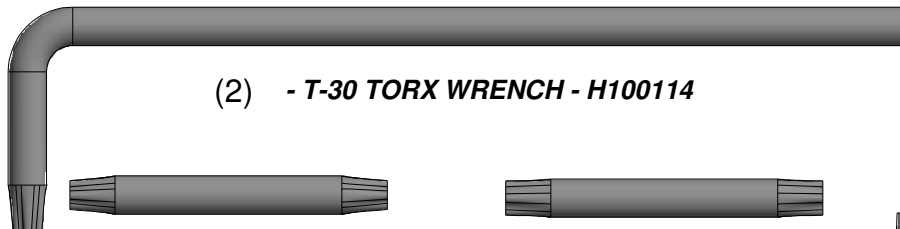

Parts Identification

Accessories
(NOT TO SCALE)

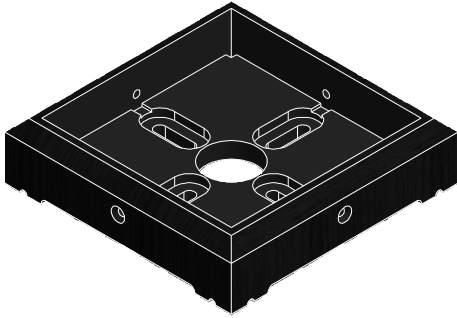

(4) **HT - FOOT 142 SQUARE POST - A100029**



(1) **- BYD ID TAG (SMALL) WITHOUT AGES - A100241**

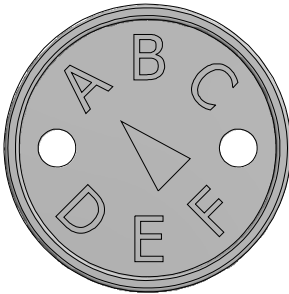

(1) **- "A" REVISION TAG - A100314**



(1) **STAIN MARKER - BW-2UV - A6P00173**



(1) **PERGOLA ELECTRICAL KIT - A6P00265 - PATENT PENDING**

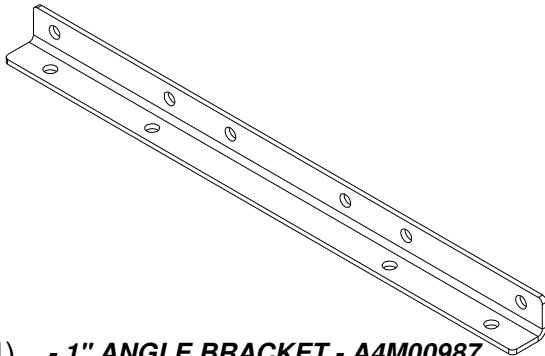

(4) **- 1" ANGLE BRACKET - A4M00987**

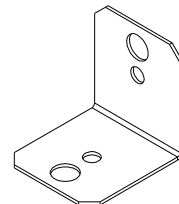

(2) **- 90° L-BRACKET - BLK - A4M00555**



(4) **Z1 - JOIST - W4L11725**
1 3/8"x6 1/4"x96 1/8" (36x157x2443)

STEP 1

COMPLETE THIS STEP TWICE

TIP:

FOR EASE OF ASSEMBLY WE RECOMMEND
 USING SAW HORSES FOR STEPS 1 THROUGH 5

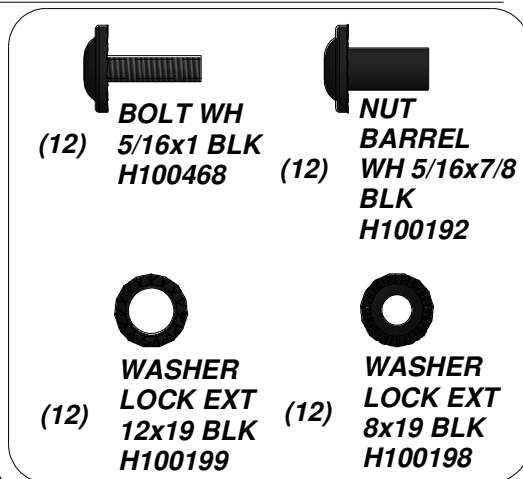
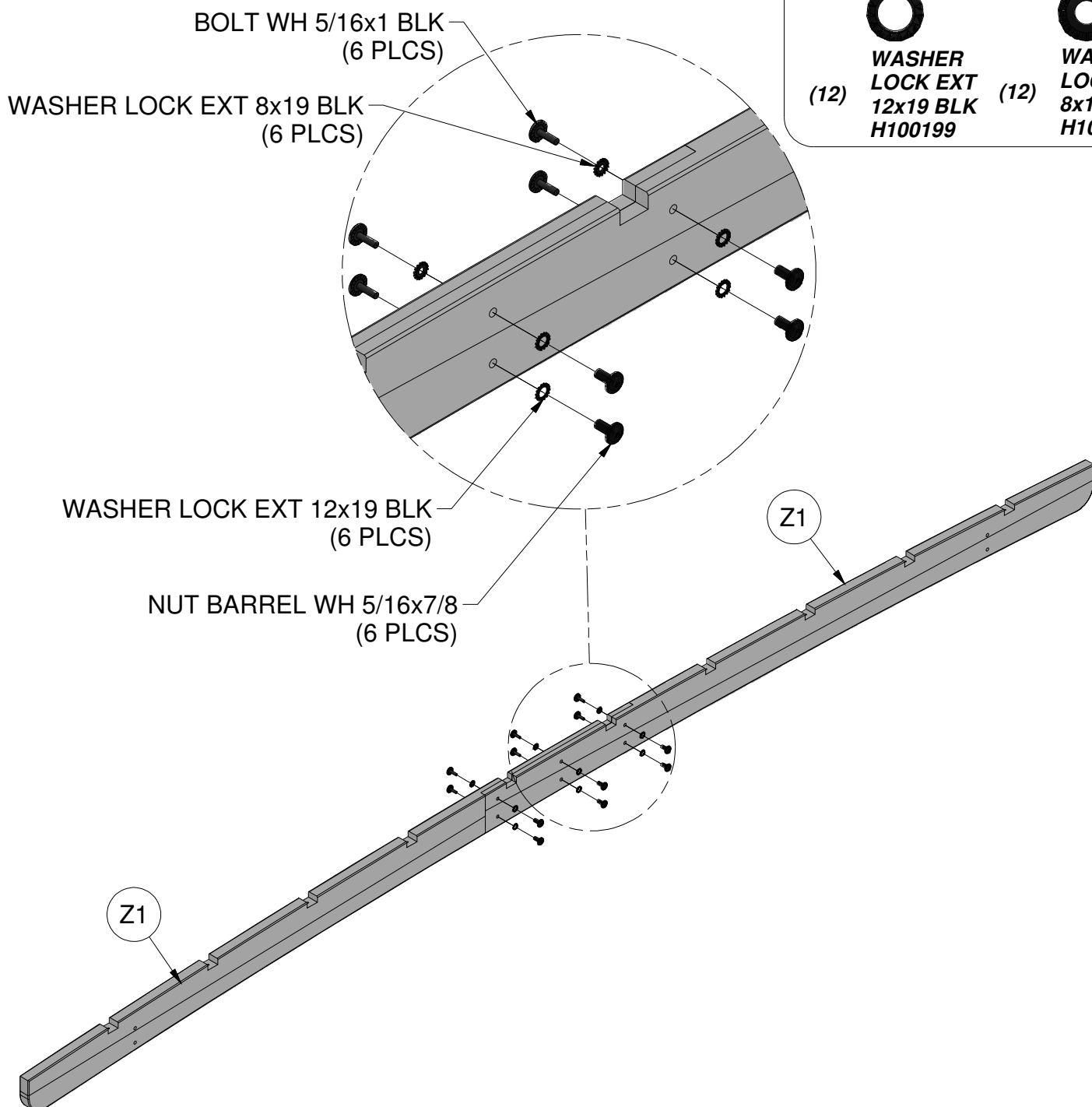

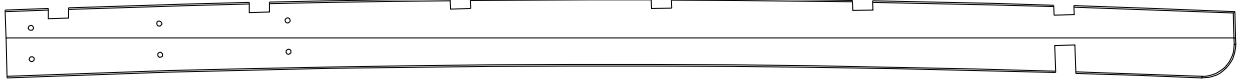

(6) **Z2 - JOIST - W4L11728**
1 3/8"x6 1/4"x96 1/8" (36x157x2443)

STEP 2

COMPLETE THIS STEP THREE TIMES

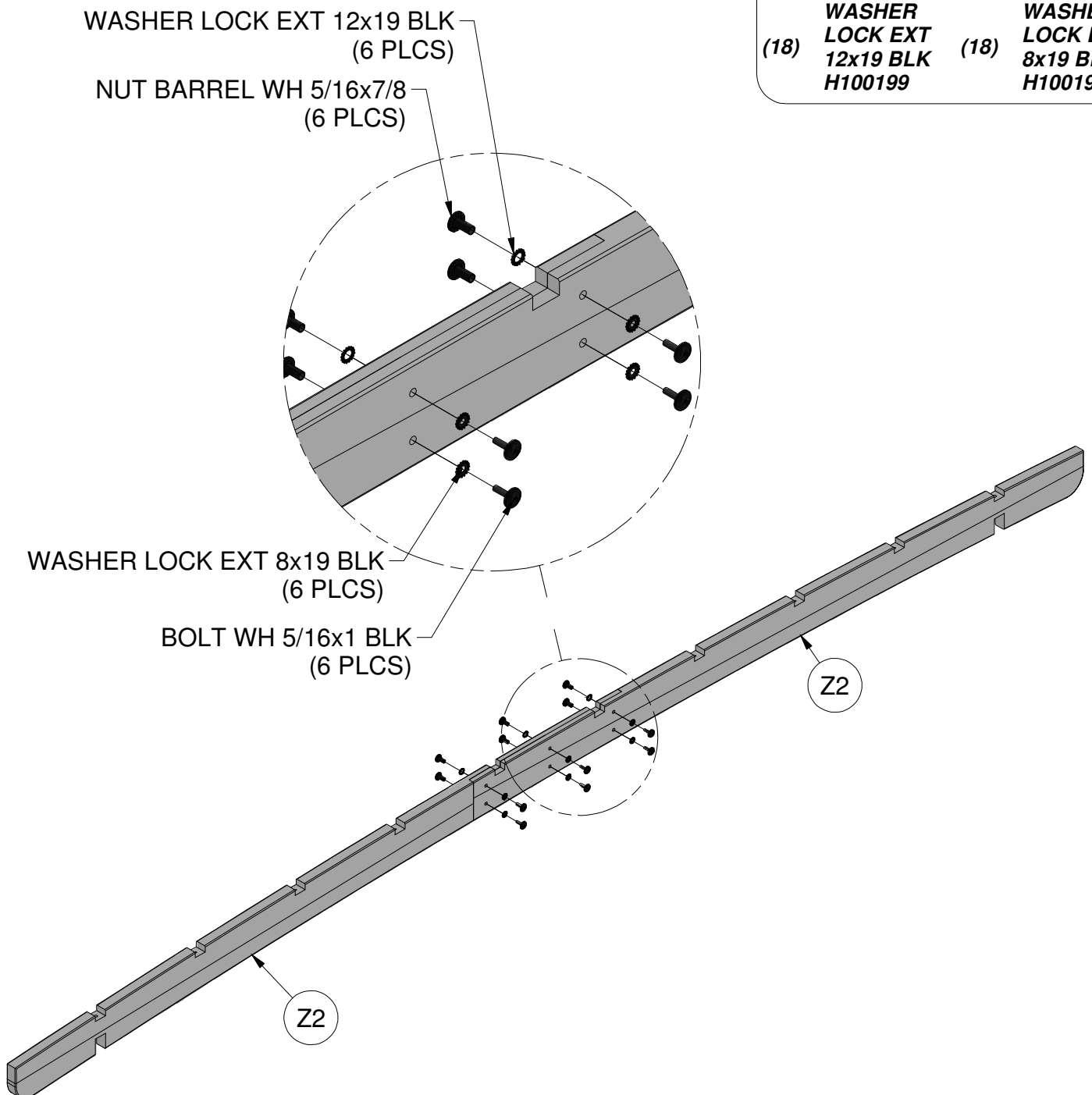
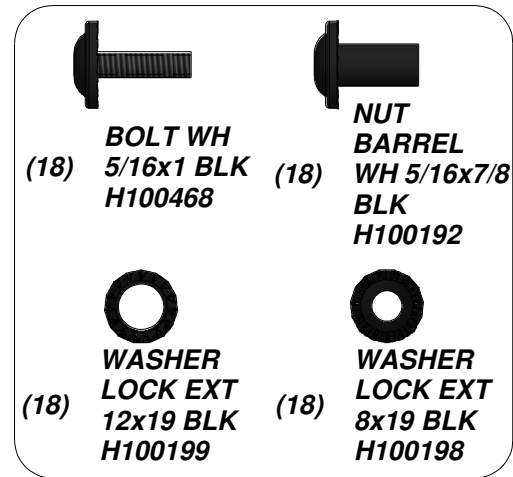

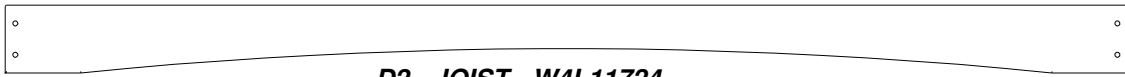

(2) **D2 - JOIST - W4L11724**
1 3/8"x5 1/4"x87 3/4" (36x134x2228)



(4) **D3 - JOIST - W4L11723**
1 3/8"x5 1/4"x27 1/2" (36x134x700)



(4) **D6 - LONG ANGLE BRACE - W4L11726**
1 3/8"x5 1/4"x36 3/4" (36x134x933)

STEP 3

COMPLETE THIS STEP TWICE

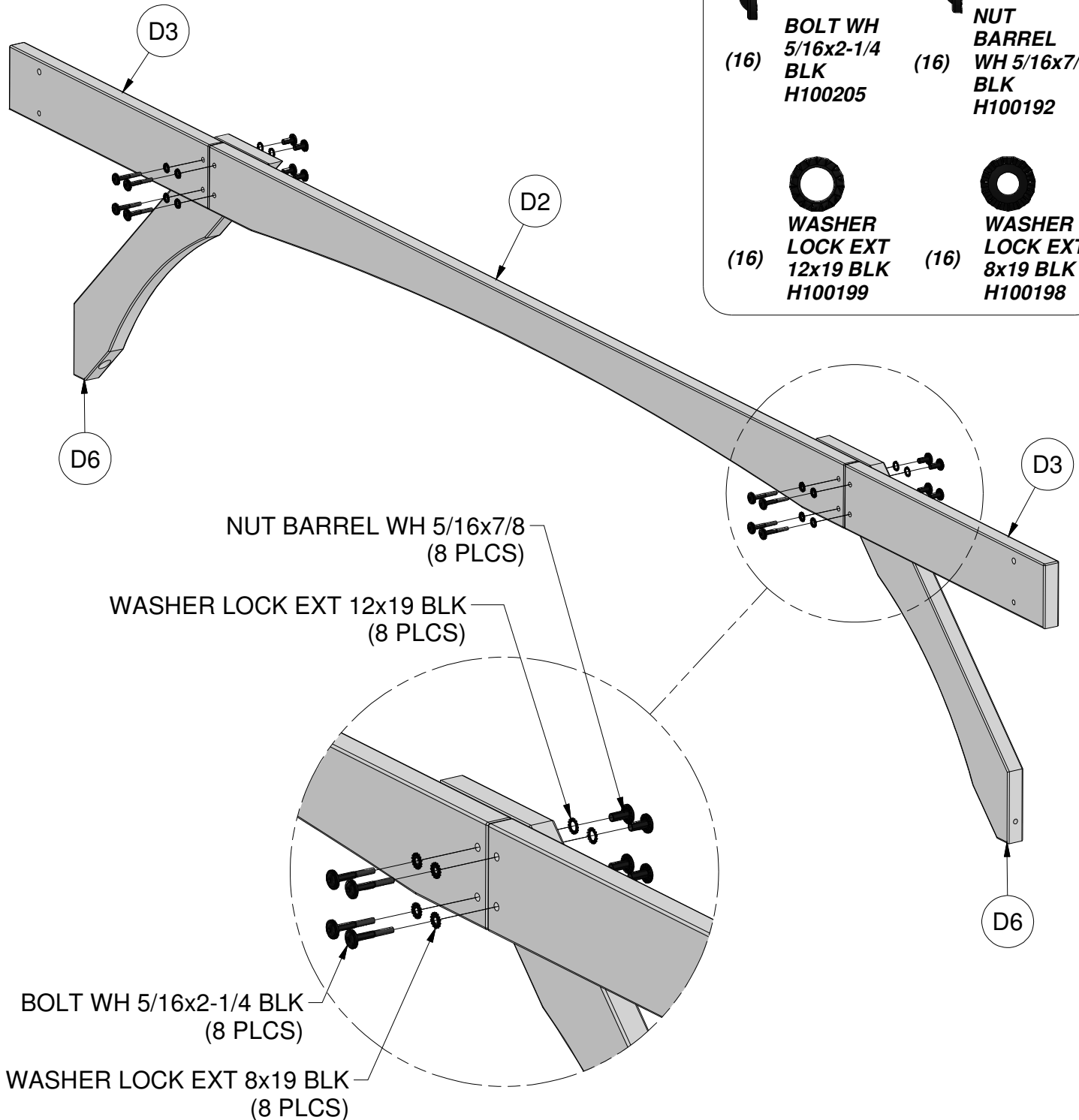
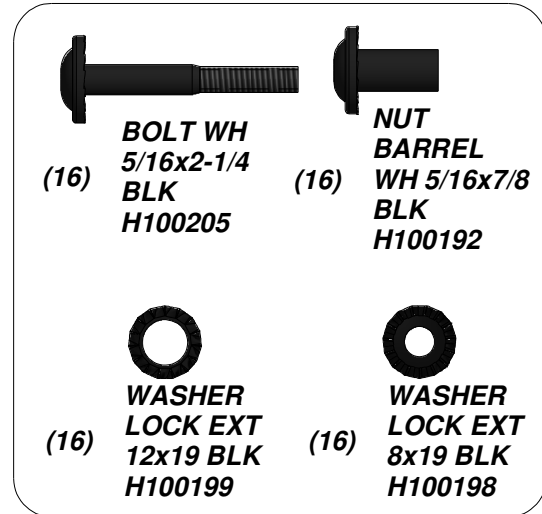

(2) **D5 - SHORT ANGLE BRACE - W4L11727**
 1 7/16"x5 1/4"x33 5/8" (36x134x854)

(1) **PT1 - PERGOLA POST - W2A02730**
 5 1/2"x5 1/2"x89 9/16" (140x140x2275)

(1) **D4 - JOIST - W4L11722**
 1 3/8"x5 1/4"x96" (36x134x2438)

(1) **PT2 - PERGOLA POST - W2A02561**
 5 1/2"x5 1/2"x89 9/16" (140x140x2275)

STEP 4

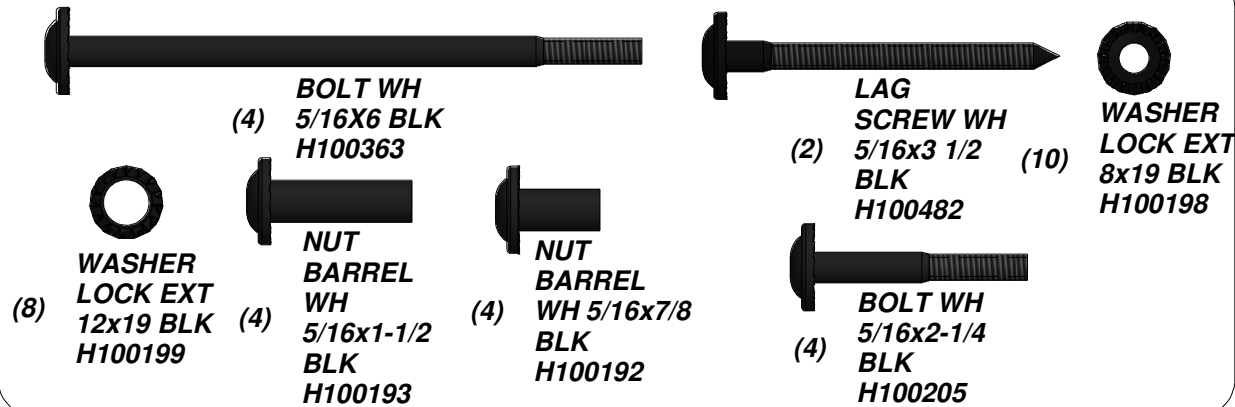

WASHER LOCK EXT 8x19 BLK
 (4 PLCS)

BOLT WH 5/16X6 BLK
 (4 PLCS)

NUT BARREL WH 5/16x1-1/2 BLK
 (4 PLCS)

WASHER LOCK EXT 12x19 BLK
 (4 PLCS)

NUT BARREL WH 5/16x7/8
 (4 PLCS)

WASHER LOCK EXT 12x19 BLK
 (4 PLCS)

NOTE HOLES ON TOP OF D4

NOTE HOLES ON THE
 INSIDE OF PT1 & PT2

BOLT WH 5/16x2-1/4 BLK
 (4 PLCS)
 WASHER LOCK EXT 8x19 BLK
 (4 PLCS)

WASHER LOCK EXT 8x19 BLK
 (2 PLCS)
 LAG SCREW WH 5/16x3-1/2 BLK
 (2 PLCS)

- (2) **D5 - SHORT ANGLE BRACE - W4L11727**
1 7/16"x5 1/4"x33 5/8" (36x134x854)

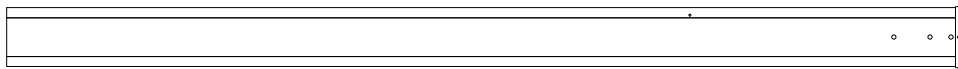

- (1) **D4 - JOIST - W4L11722**
1 3/8"x5 1/4"x96" (36x134x2438)

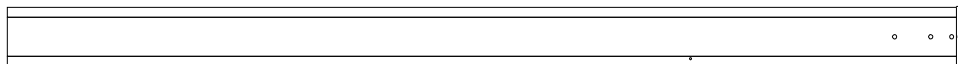

- (1) **PT3 - PERGOLA POST - W2A02731**
5 1/2"x5 1/2"x89 9/16" (140x140x2275)

- (1) **PT4 - PERGOLA POST - W2A02562**
5 1/2"x5 1/2"x89 9/16" (140x140x2275)

STEP 5

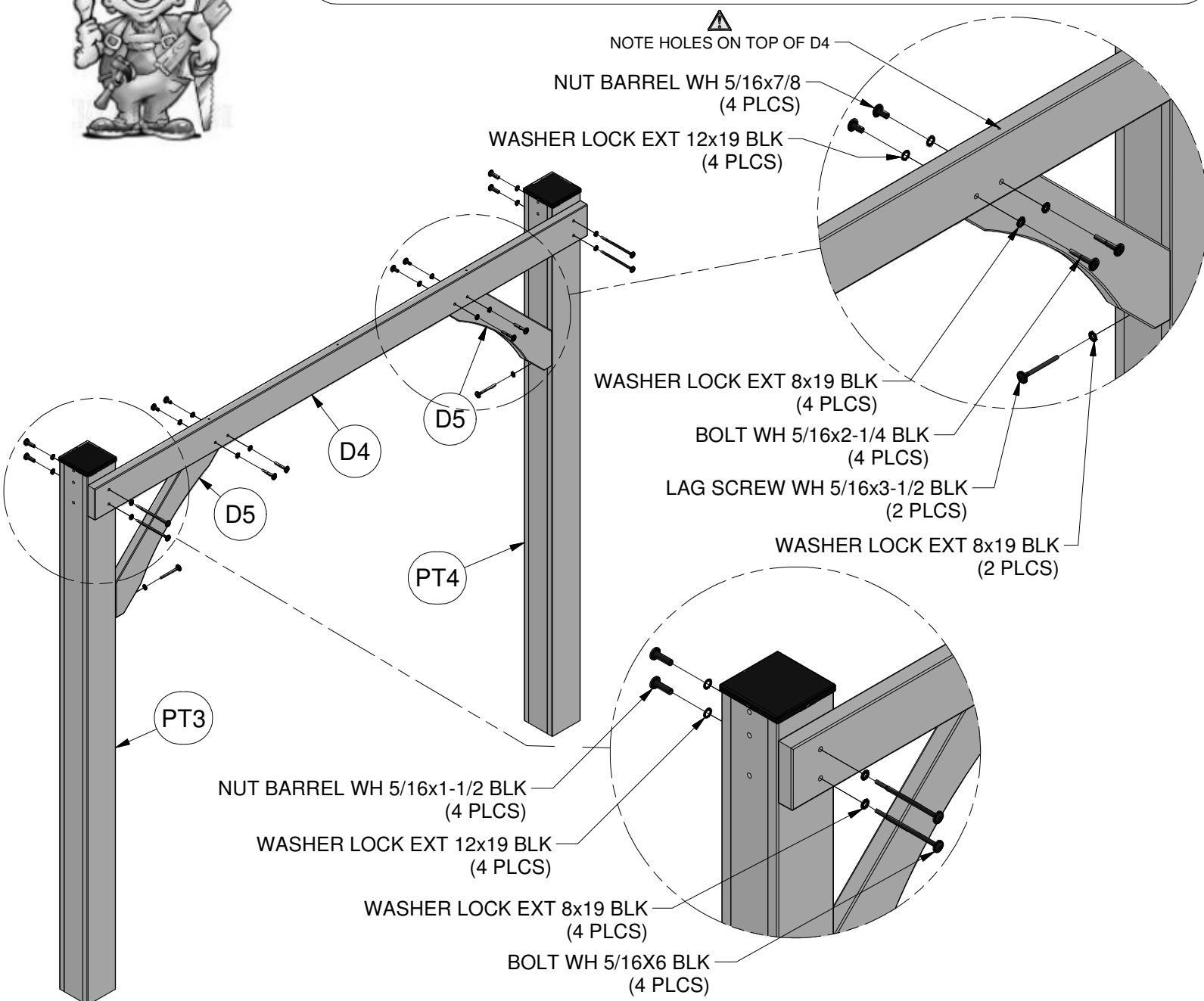
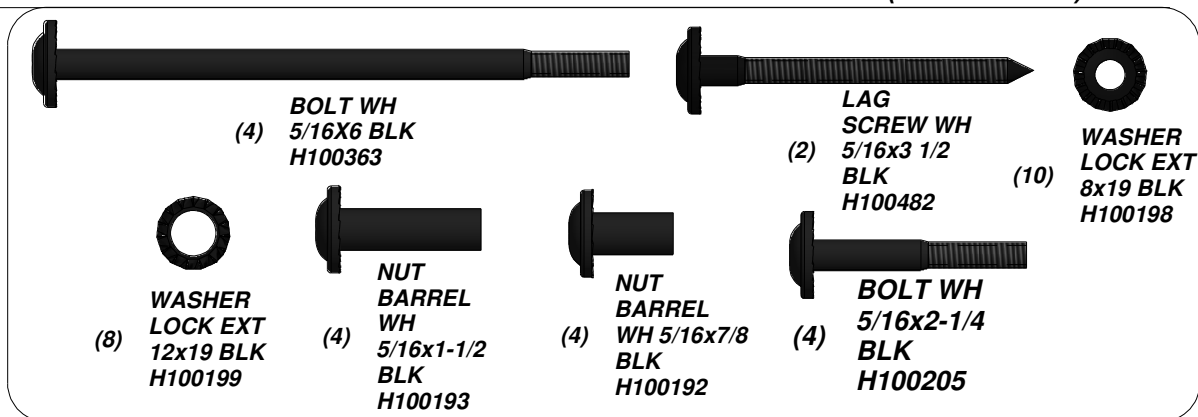

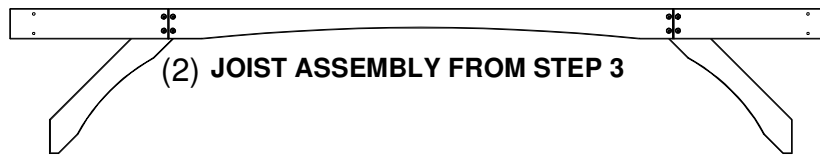

STEP 6

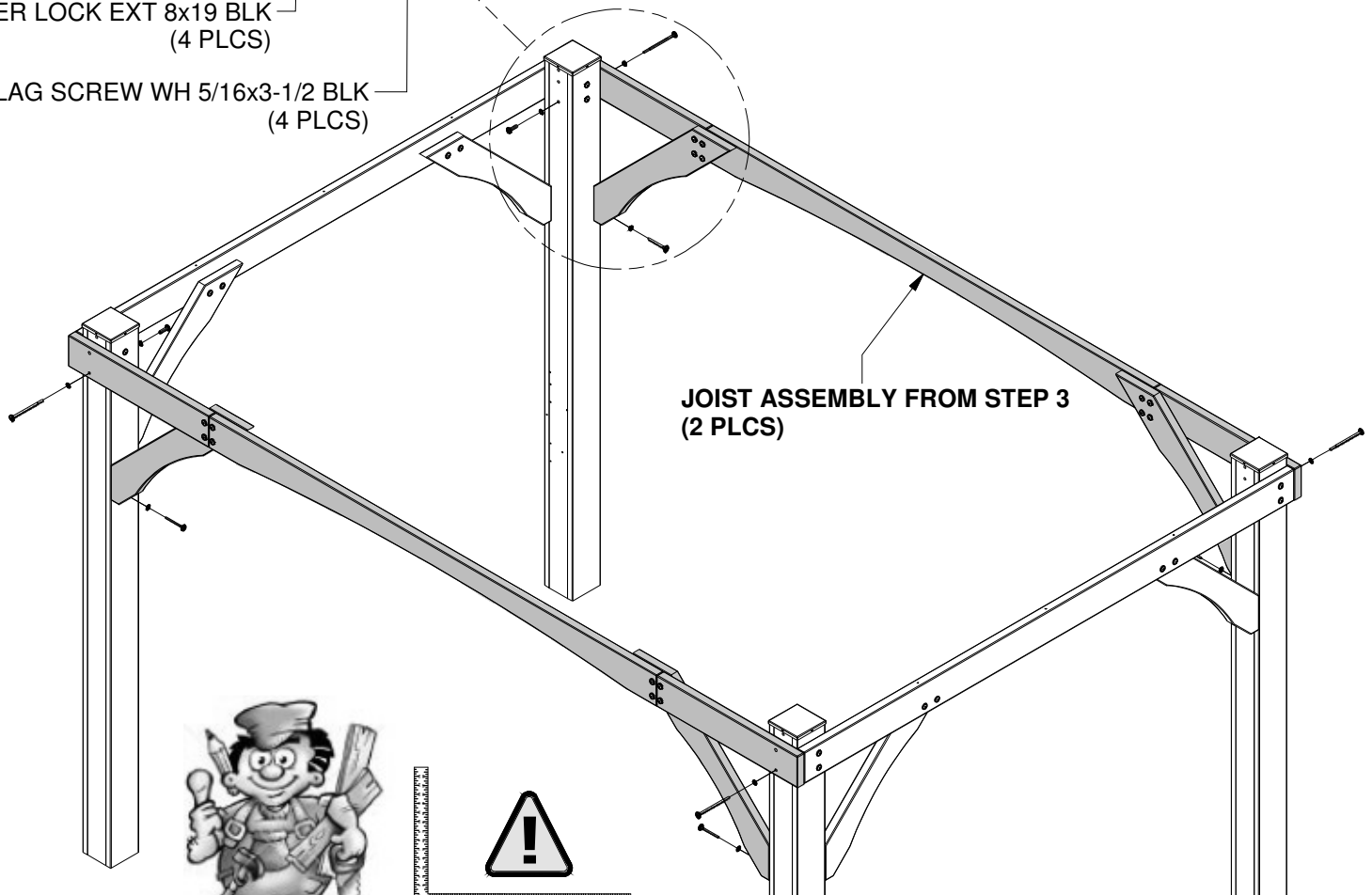
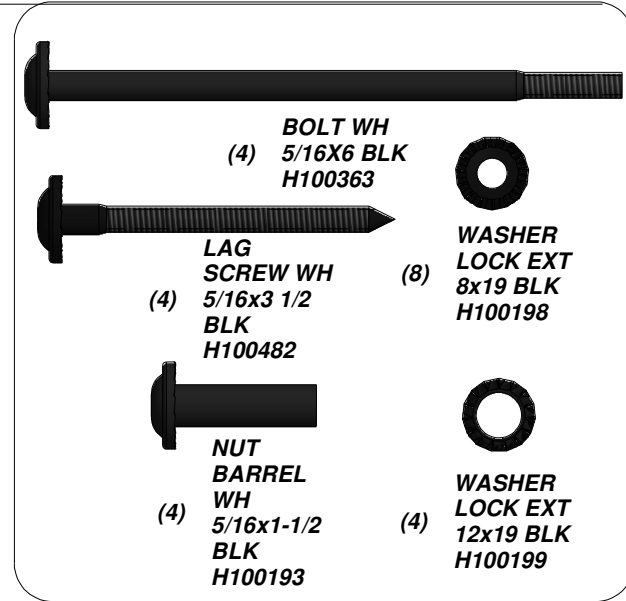
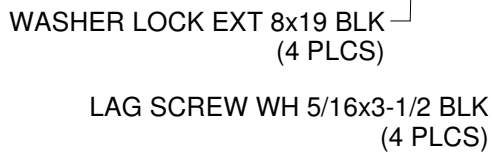
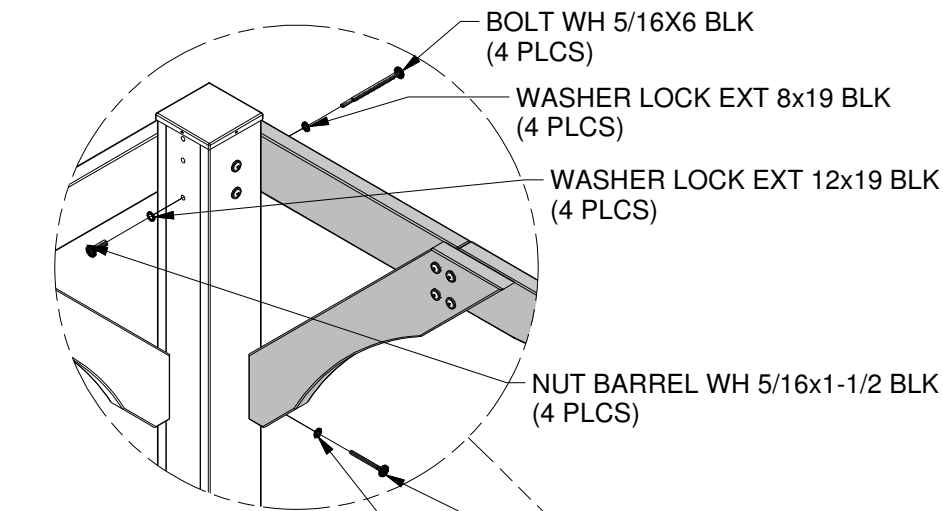

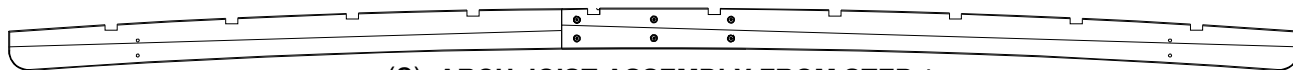

(2) ARCH JOIST ASSEMBLY FROM STEP 1



(4) **F1 - SPACER - W4L11730**
1 3/8"x2"x5 1/2" (36x50x140)

STEP 7

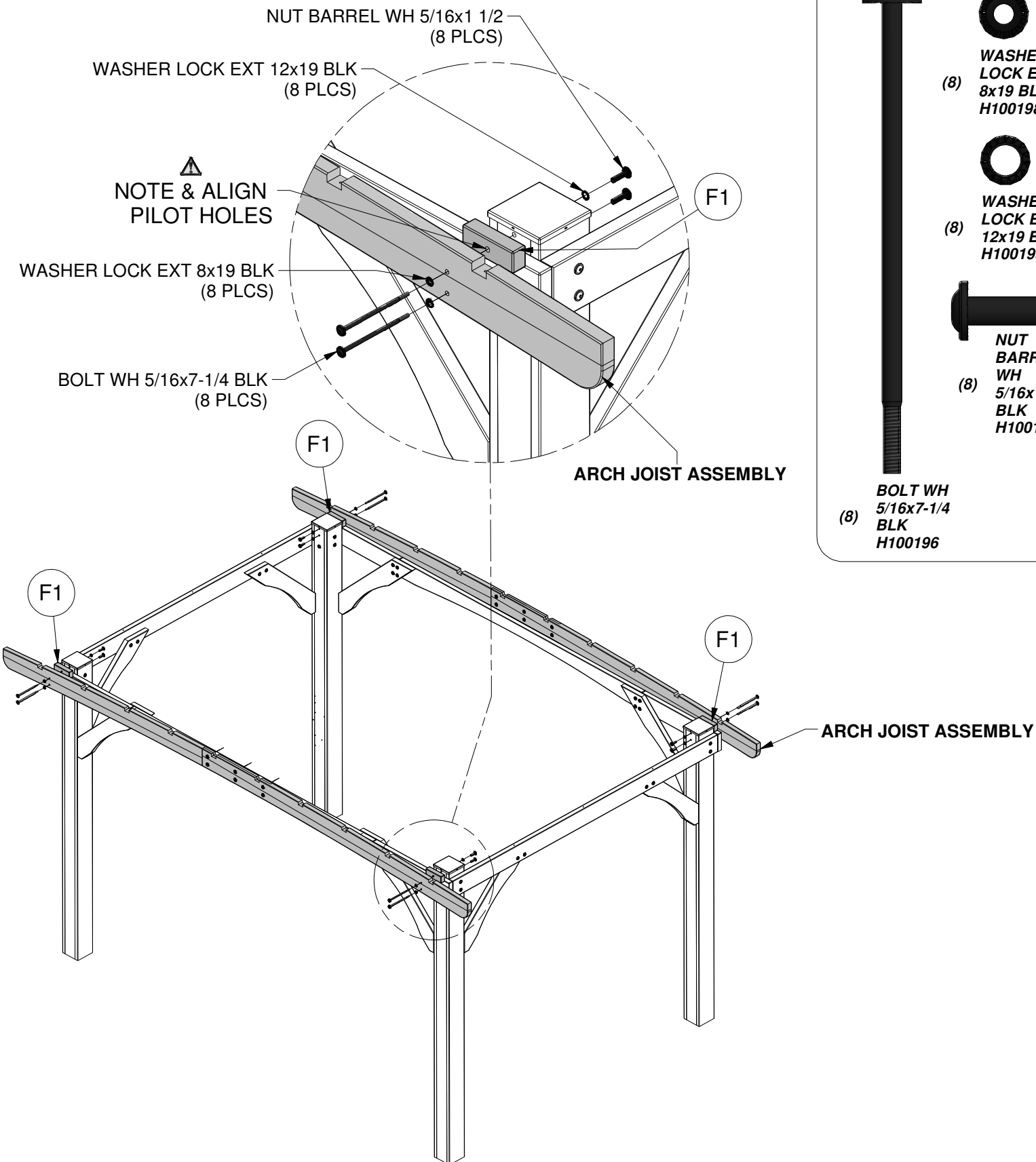

(8) **BOLT WH**
5/16x7-1/4
BLK
H100196



(8) **WASHER
LOCK EXT**
8x19 BLK
H100198



(8) **WASHER
LOCK EXT**
12x19 BLK
H100199



(8) **NUT
BARREL**
WH
5/16x1-1/2
BLK
H100193

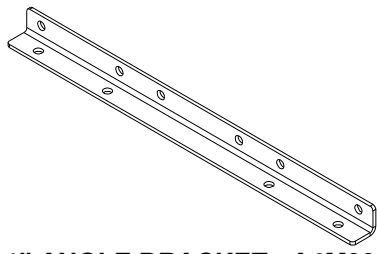

(4) - 1" ANGLE BRACKET - A4M00987

STEP 8

SCREW
(40) PWH 8x1-1/4
BLK
H100536

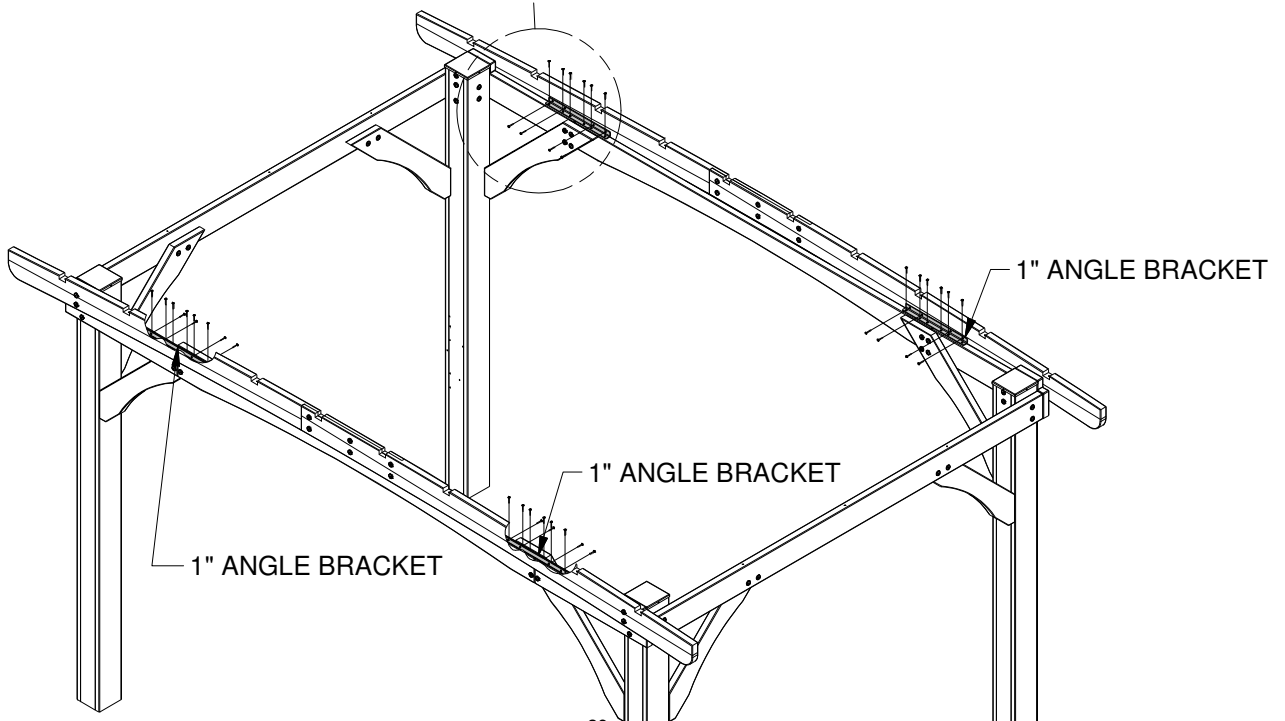
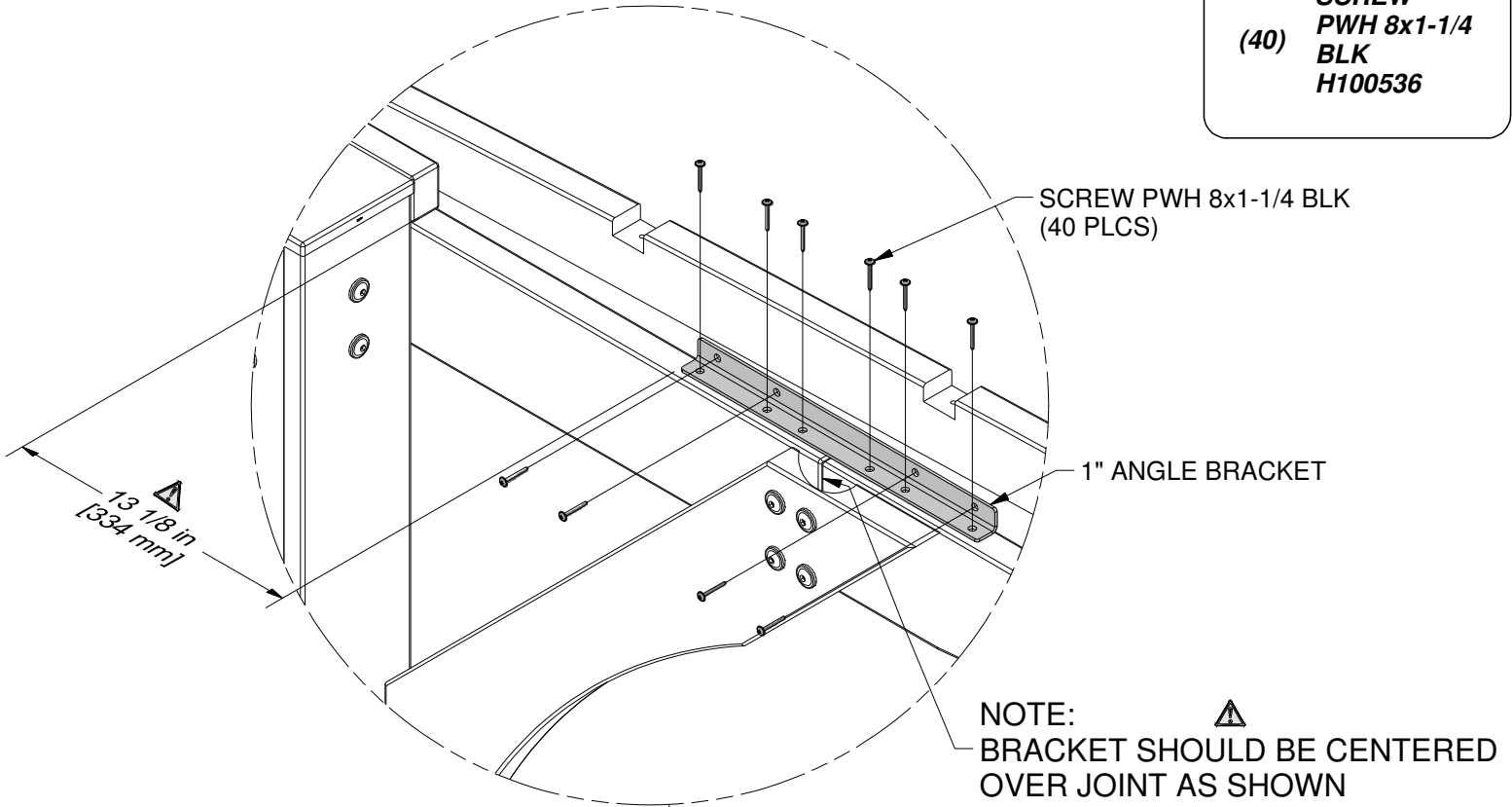



(3) CENTER ARCH JOIST ASSEMBLY FROM STEP 2

STEP 9

⚠
NOTE PILOT HOLES.
ALIGN PILOT HOLES AND
MOVE ON TO STEP 10

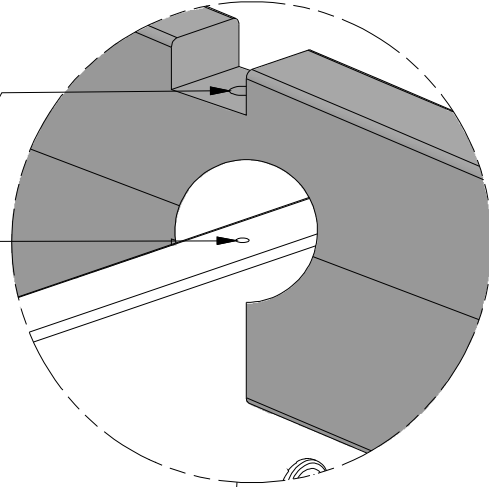

**CENTER ARCH JOIST ASSEMBLY
(3 PLCS)**

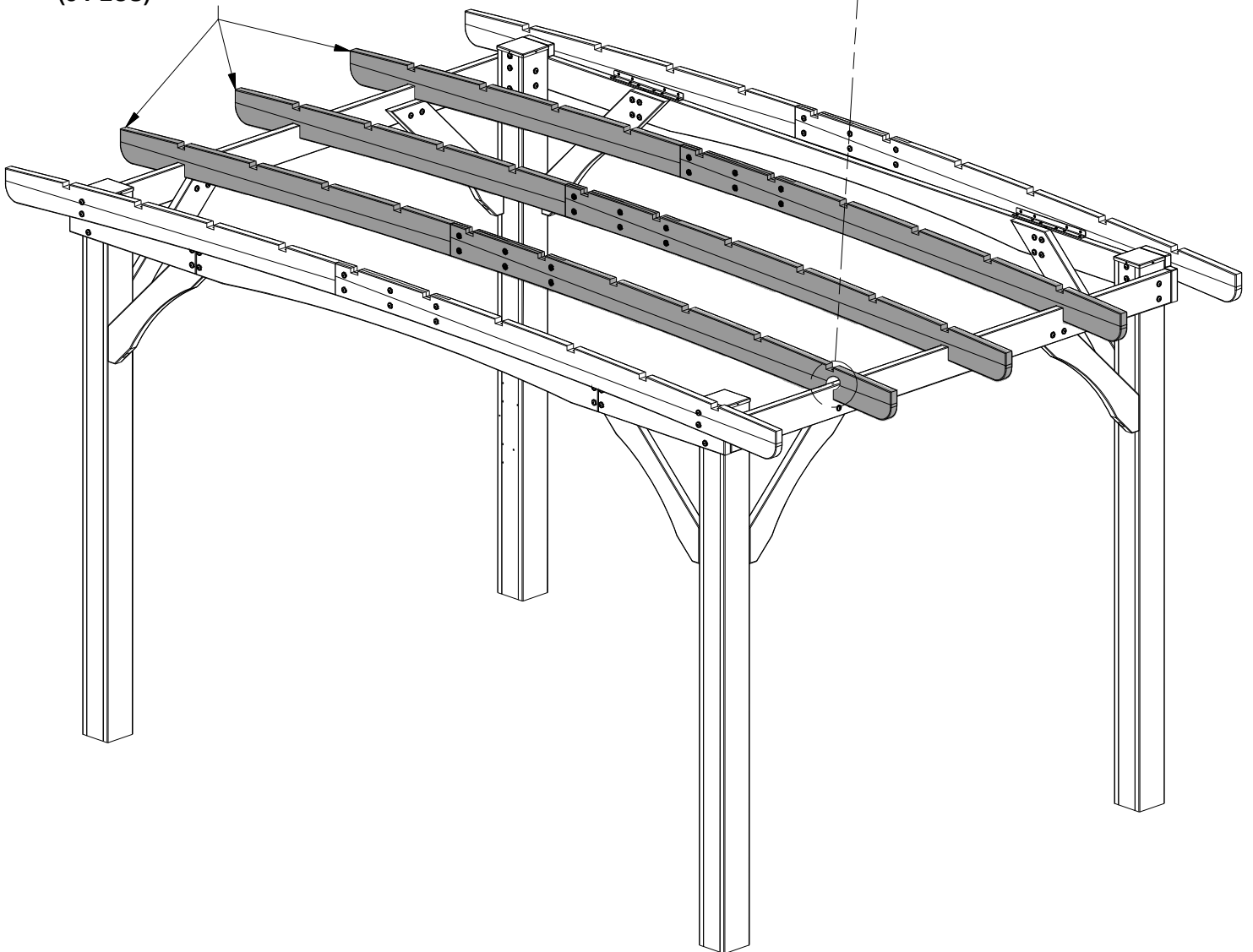

(10) **D1 - JOIST - W4L11729**
1 3/8"x5 1/4"x114" (36x134x2895)

STEP 10

WASHER LOCK EXT 8x19 BLK
(50 PLCS)

LAG SCREW WH 5/16x5-1/2 BLK
(44 PLCS)

LAG SCREW WH 5/16x8 BLK
(3 PLCS)

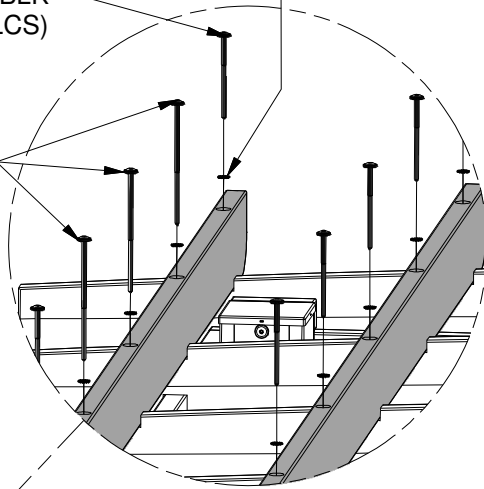

LAG
SCREW WH
5/16x5-1/2
BLK
H100204



LAG
SCREW WH
5/16x8 BLK
H100766



WASHER
LOCK EXT
8x19 BLK
H100198

LAG SCREW WH 5/16x8 BLK
(3 PLCS)

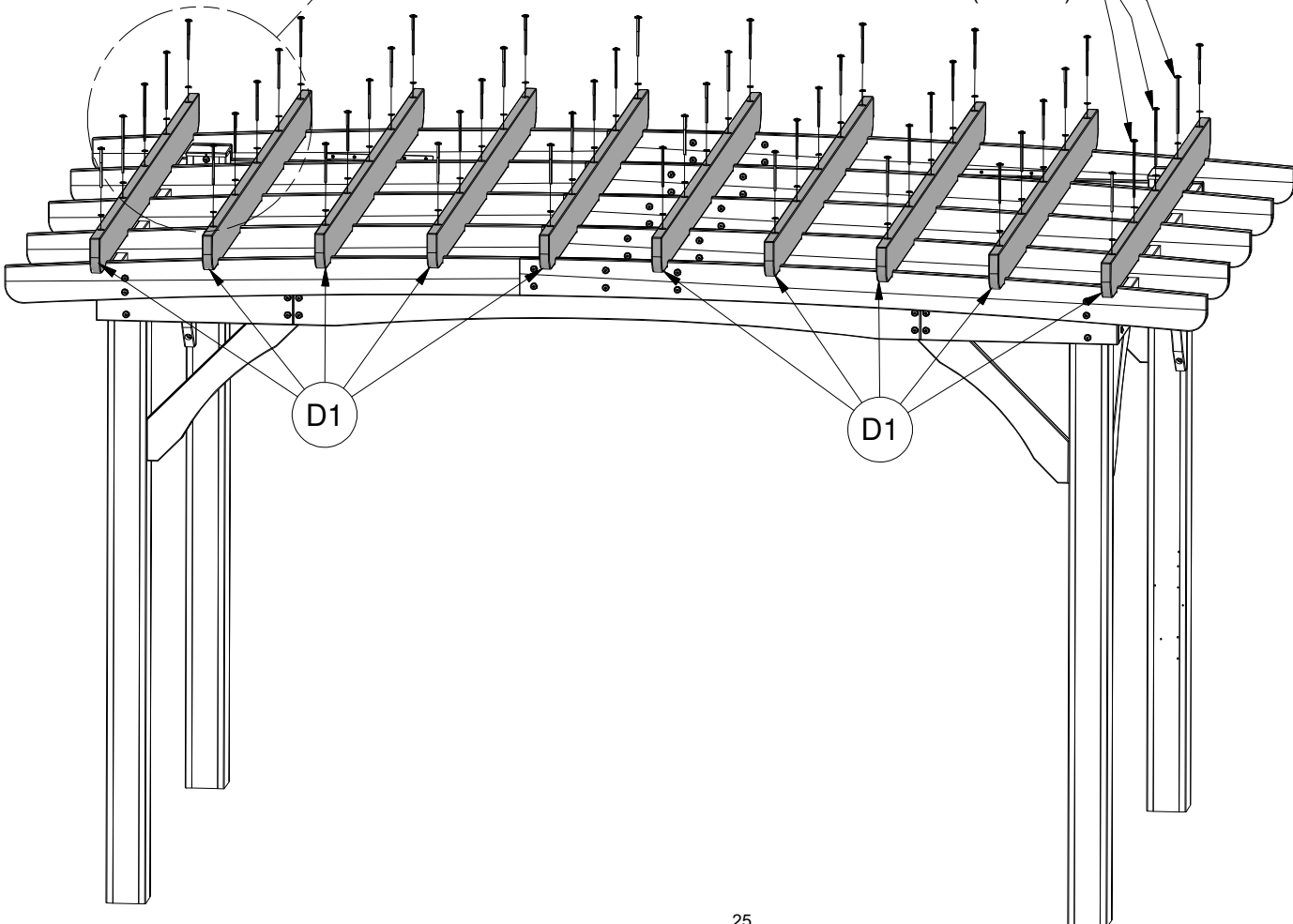

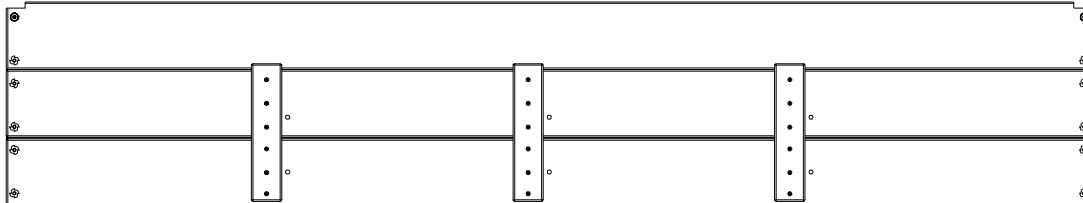

(1) **WP1 - WALL PANEL - W2A02565**
 2 1/2"x15 15/16"x84 7/8" (65x405x2156)

STEP 11

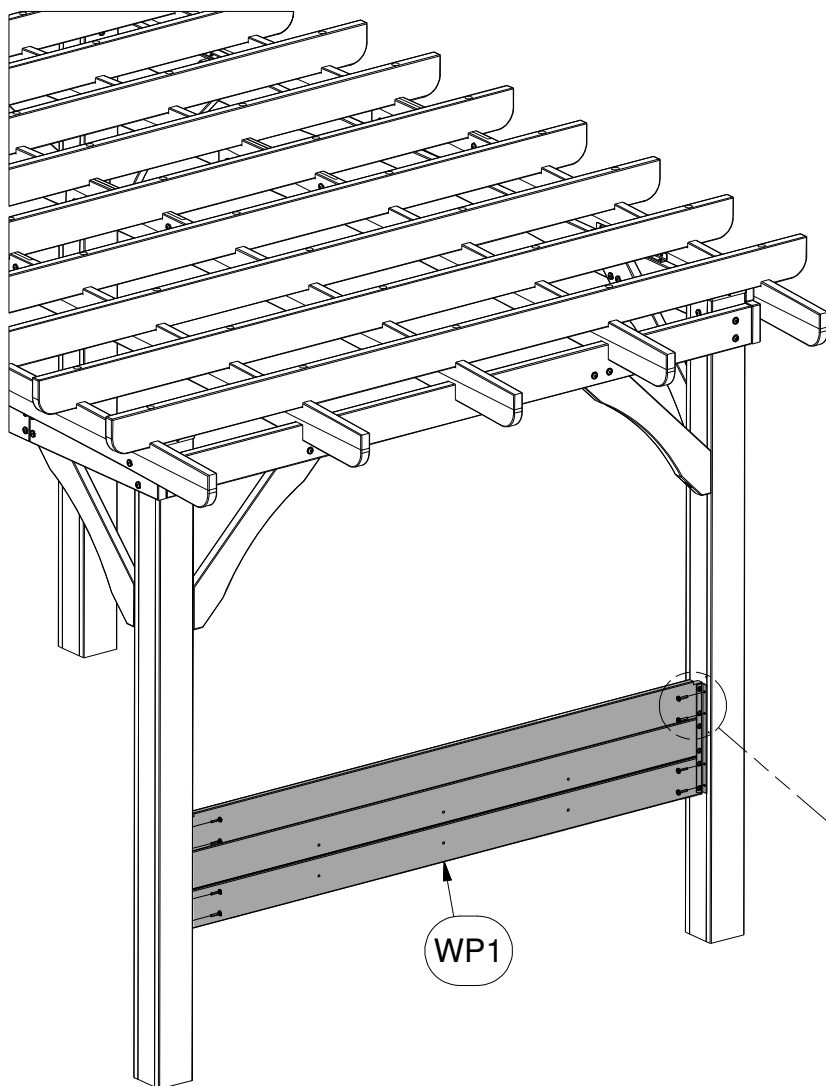

LINE UP PILOT HOLES IN PANEL WITH
 PILOT HOLES IN POST AND ATTACH.

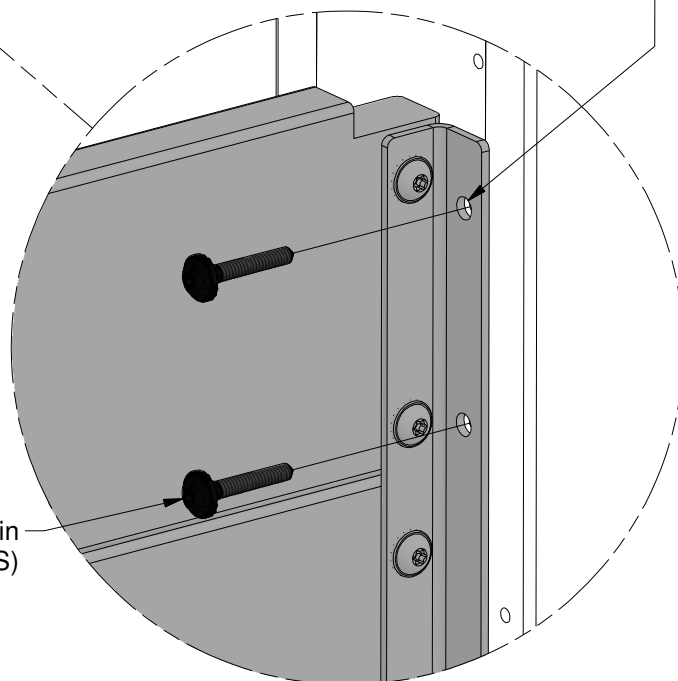

LAG SCREW WH 1/4x1-1/2 in
 (8 PLCS)



- (1) **F2 - TABLE BRACE - W4L12246**
1 3/8"x2 3/8"x11 7/8" (36x60x303)



- (1) **F4 - TABLE BRACE - W4L12325**
1 3/8"x2 3/8"x11 7/8" (36x60x303)

STEP 12

 **NOTE PILOT HOLE.**

WASHER LOCK EXT 6x15 BLK
(2 PLCS)

LAG SCREW WH 1/4x2-1/2 BLK
(2 PLCS)

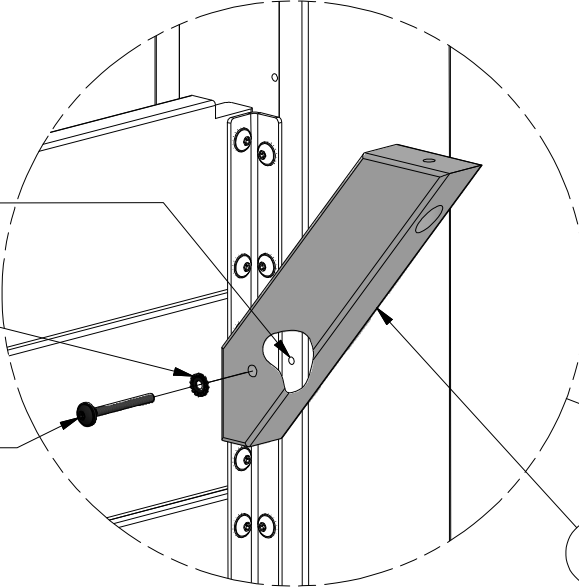

LAG
SCREW WH
(2) 1/4x2-1/2
BLK
H100456



WASHER
LOCK EXT
(2) 6x15 BLK
H100405

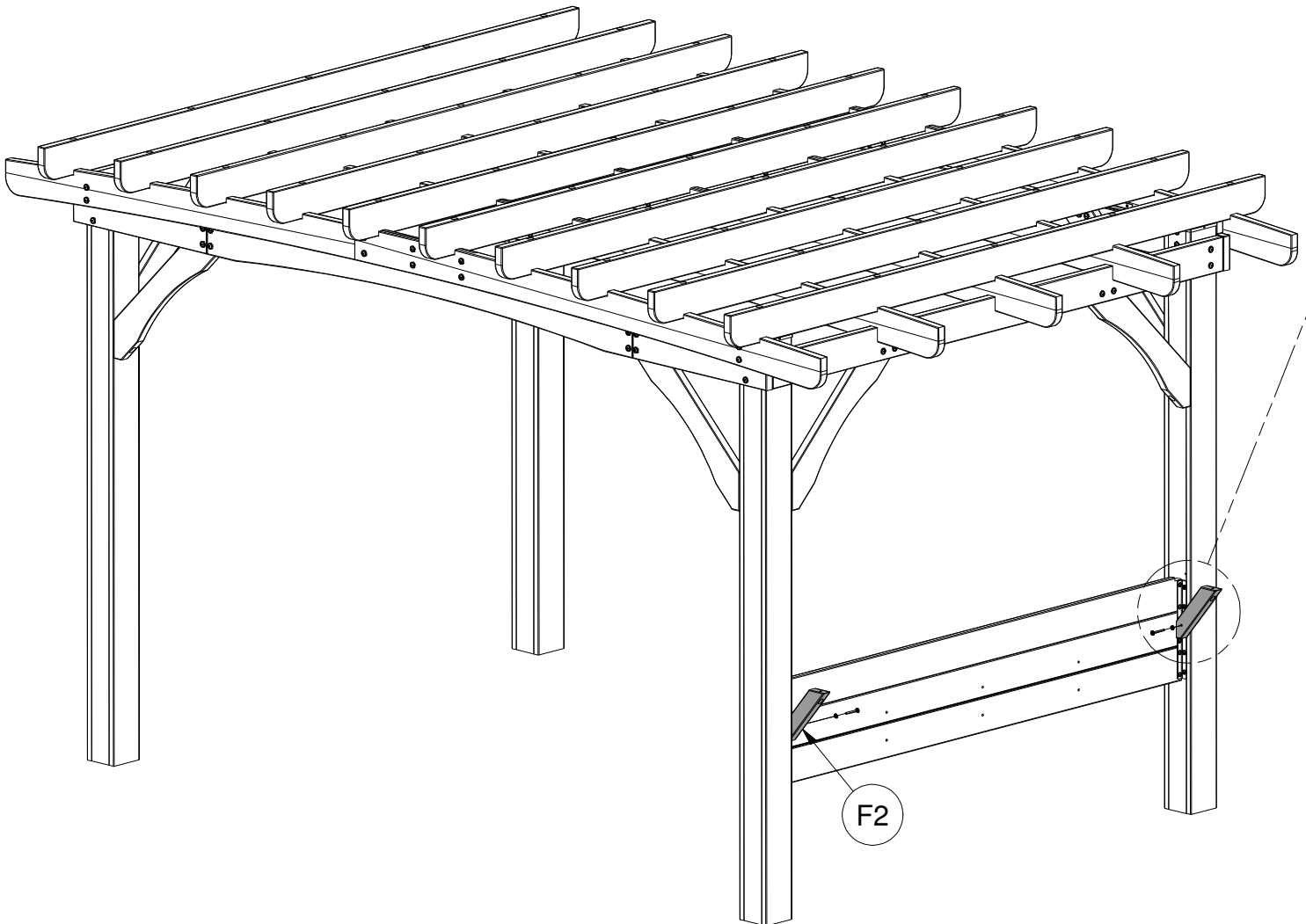

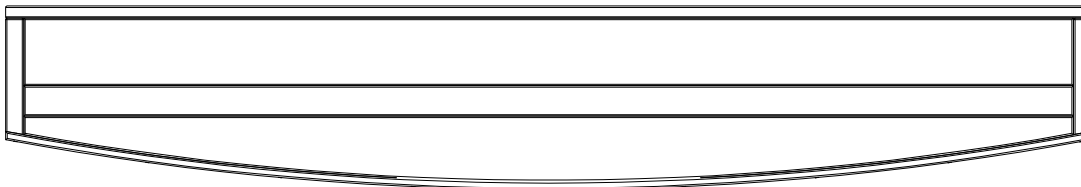

(1) **TT2 - OUTER TABLE TOP ASSEMBLY - W2A02563**
 2 3/8"x14 5/16"x84 7/8" (60x364x2156)

STEP 13

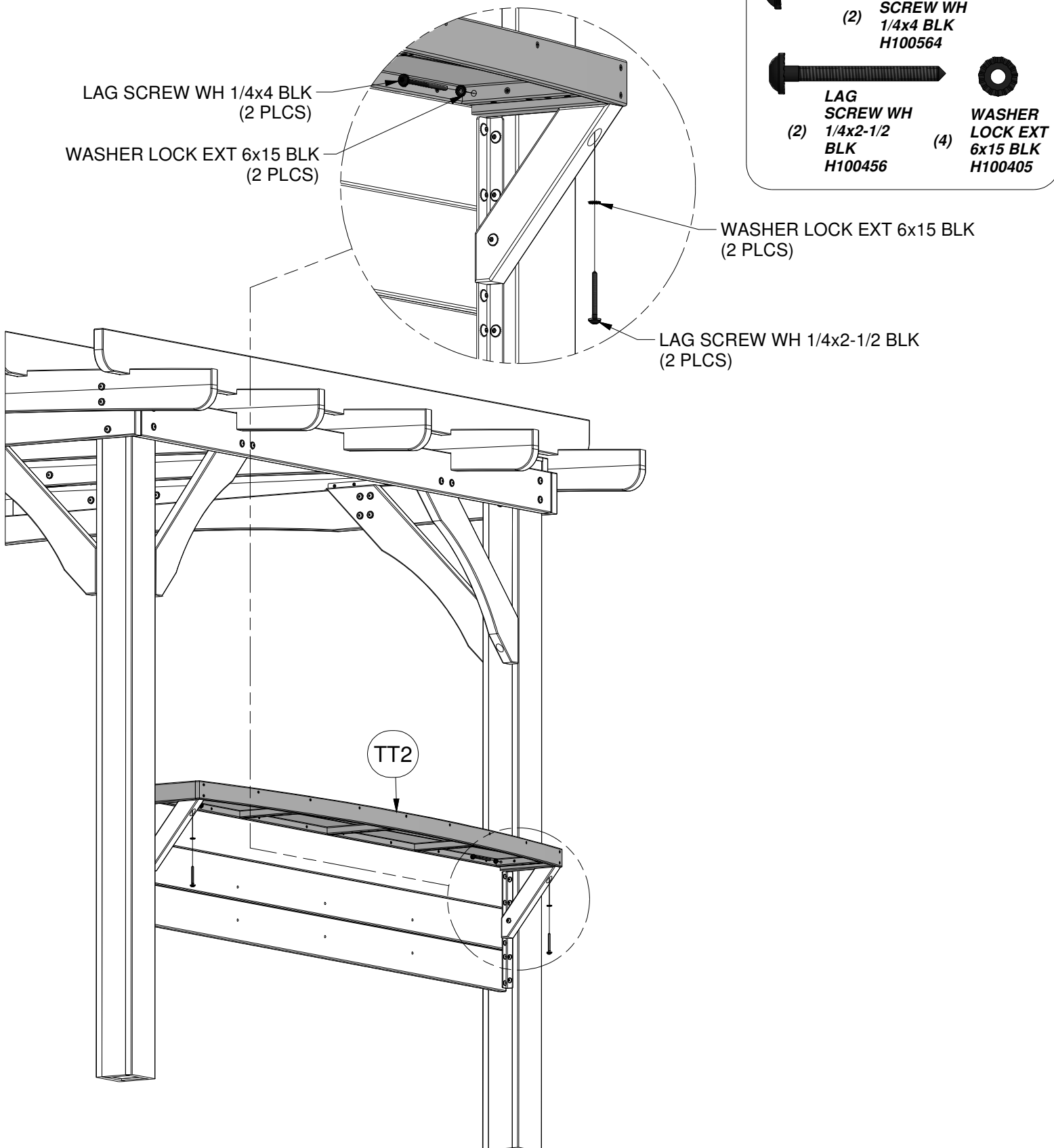

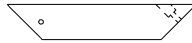

- (2) **F3 - TABLE BRACE - W4L12249**
1 3/8"x2 3/8"x12 13/16" (36x60x325)

STEP 14

NOTE  PILOT HOLE.

LAG SCREW WH 1/4x2-1/2 BLK
(2 PLCS)

WASHER LOCK EXT 6x15 BLK
(2 PLCS)

F3



**LAG
SCREW WH**
(2) 1/4x2-1/2
BLK
H100456



(2) **WASHER
LOCK EXT**
6x15 BLK
H100405

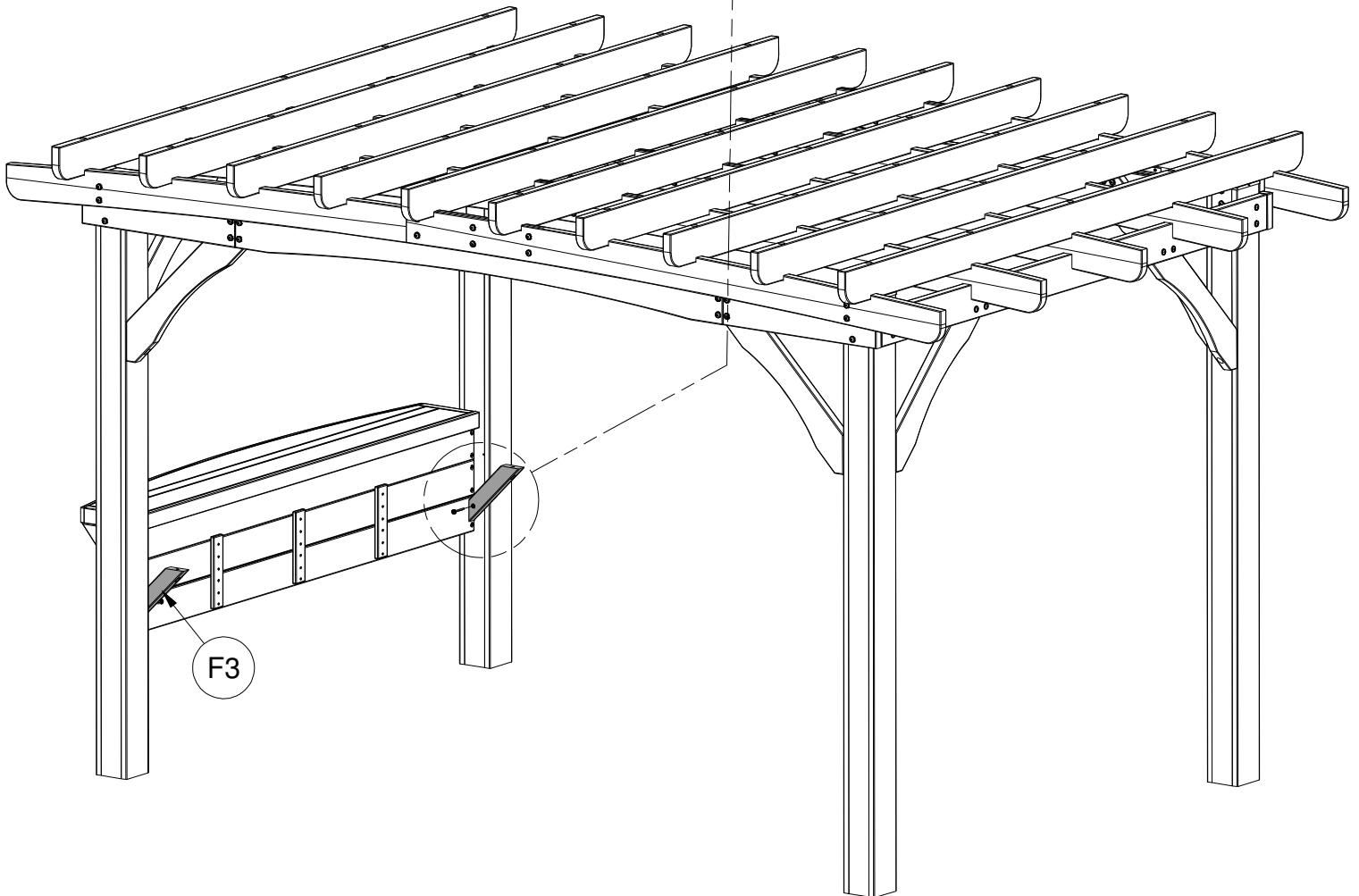

F3



(1) **TT1 - INSIDE TABLE TOP ASSEMBLY - W2A02564**
 2 3/8"x13 3/8"x84 7/8" (60x340x2156)

STEP 15

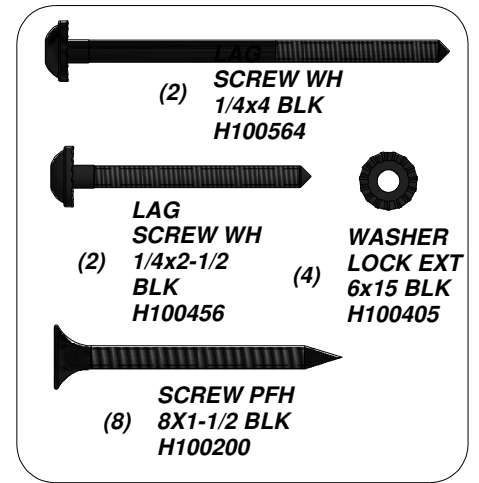
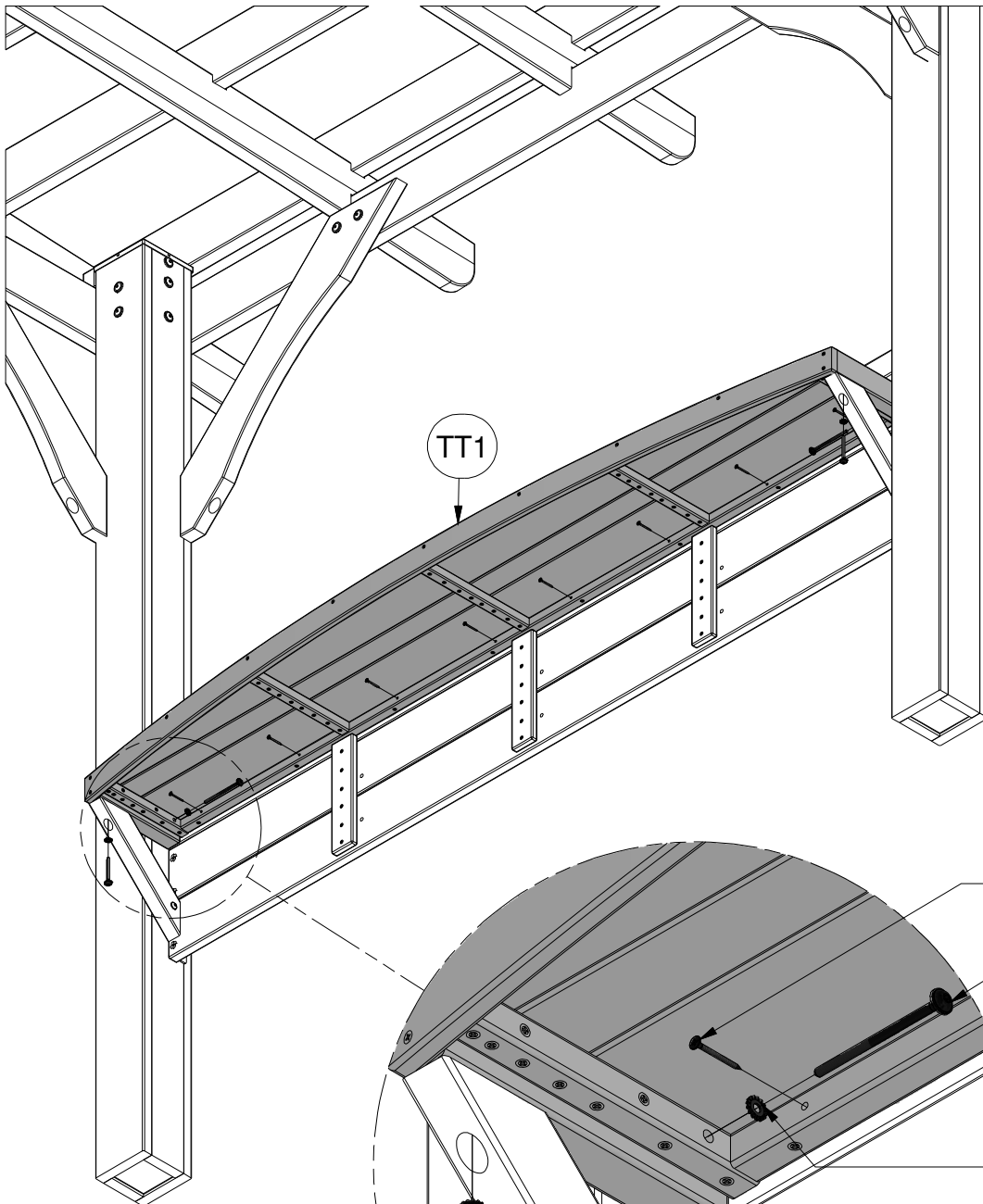

WASHER LOCK EXT 6x15 BLK
 (2 PLCS)

LAG SCREW WH 1/4x2-1/2 BLK
 (2 PLCS)

SCREW PFH 8X1-1/2 BLK
 (8 PLCS)

LAG SCREW WH 1/4x4 BLK
 (2 PLCS)

WASHER LOCK EXT 6x15 BLK
 (2 PLCS)



(3) **G1 - TABLE BRACE - W4L12247**
1"x5 1/4"x16 5/8" (24x134x423)

STEP 16

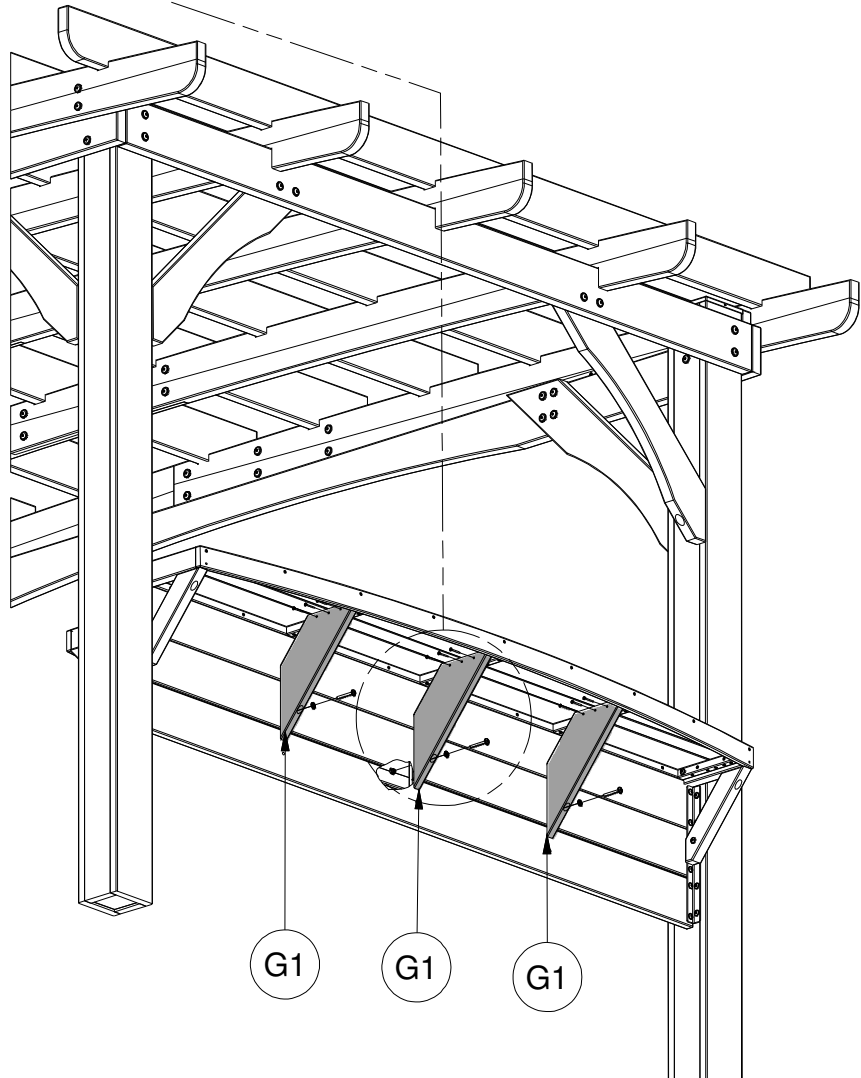
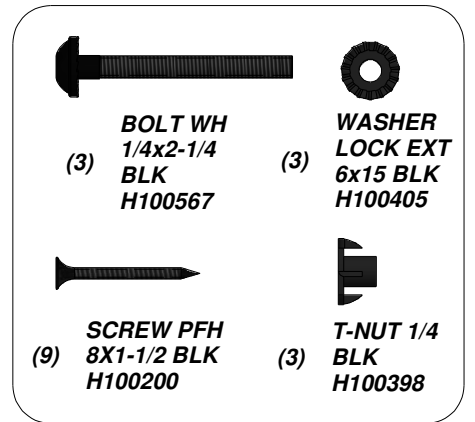
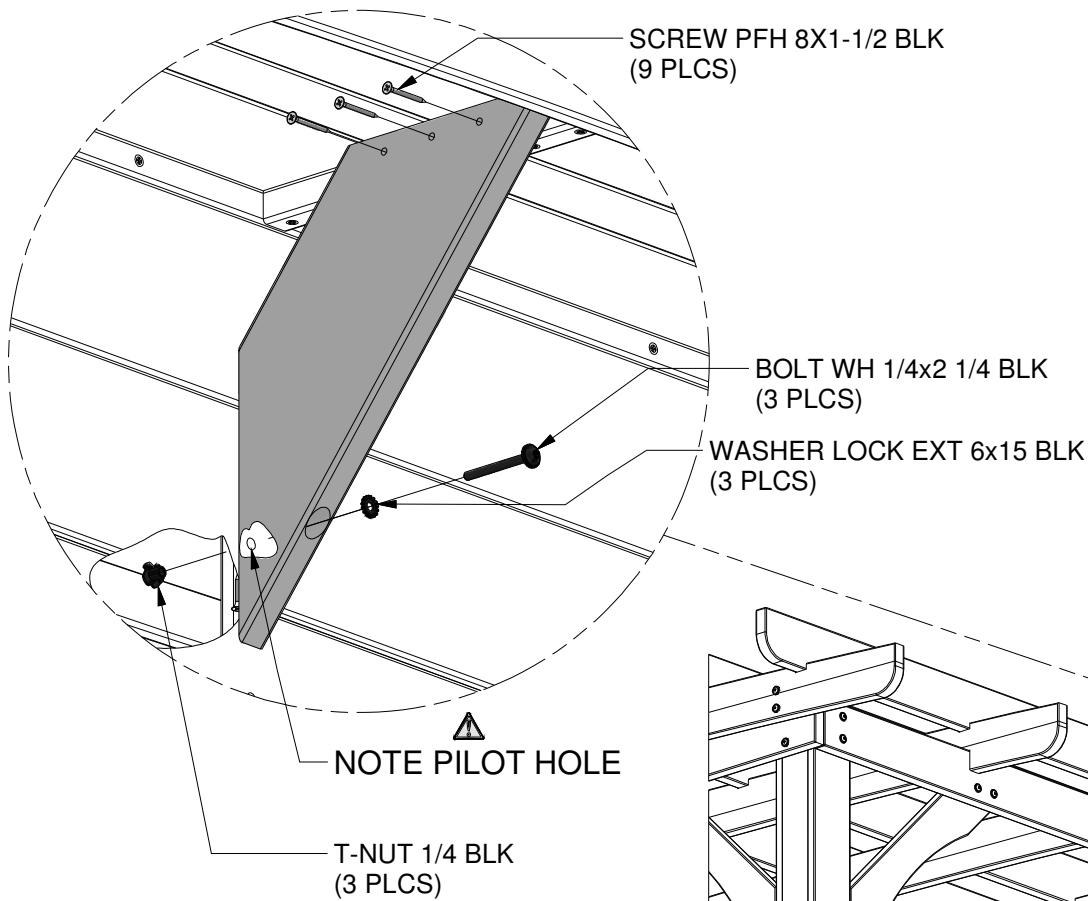



(3) **G2 - TABLE BRACE - W4L12248**
1"x5 1/4"x16 5/8" (24x134x423)

STEP 17

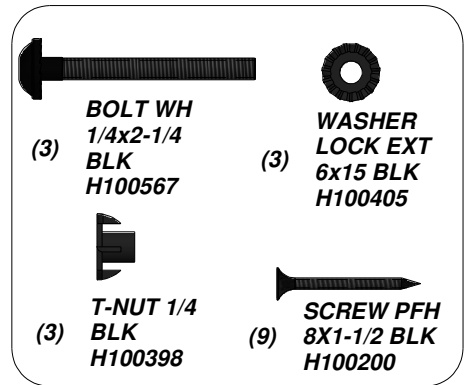
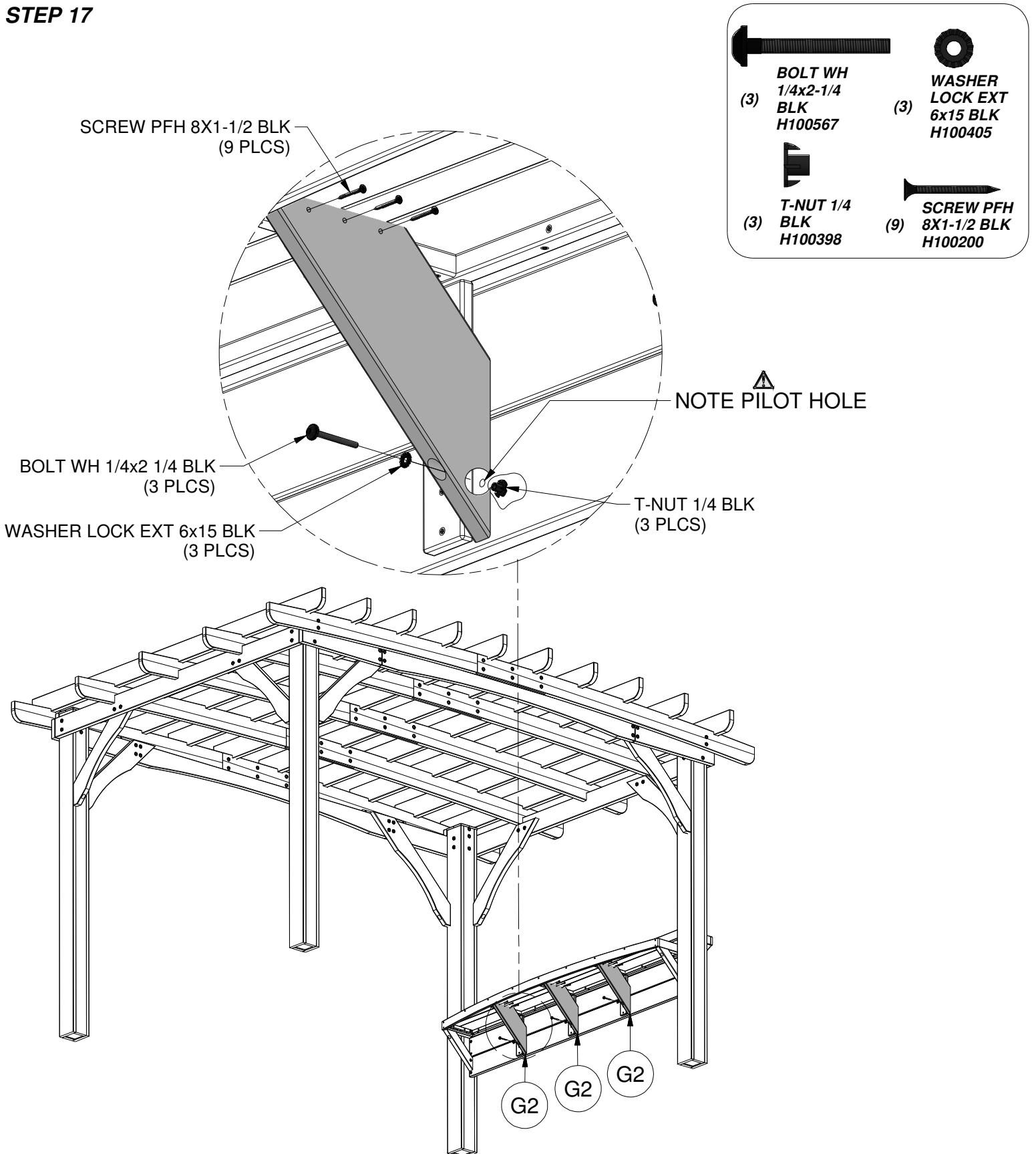

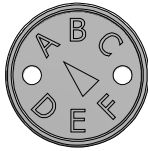

(1) - "A" REVISION TAG - A100314

(1) - BYD ID TAG (SMALL) WITHOUT AGES - A100241

STEP 18

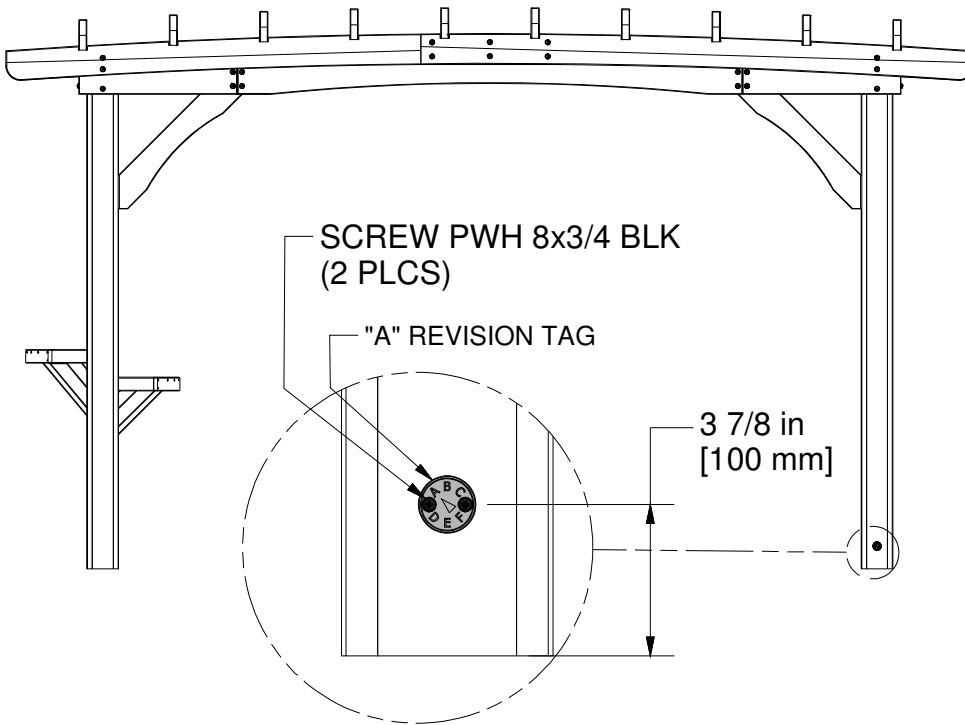

SCREW
PWH 8x3/4
BLK
H100392

LEFT SIDE

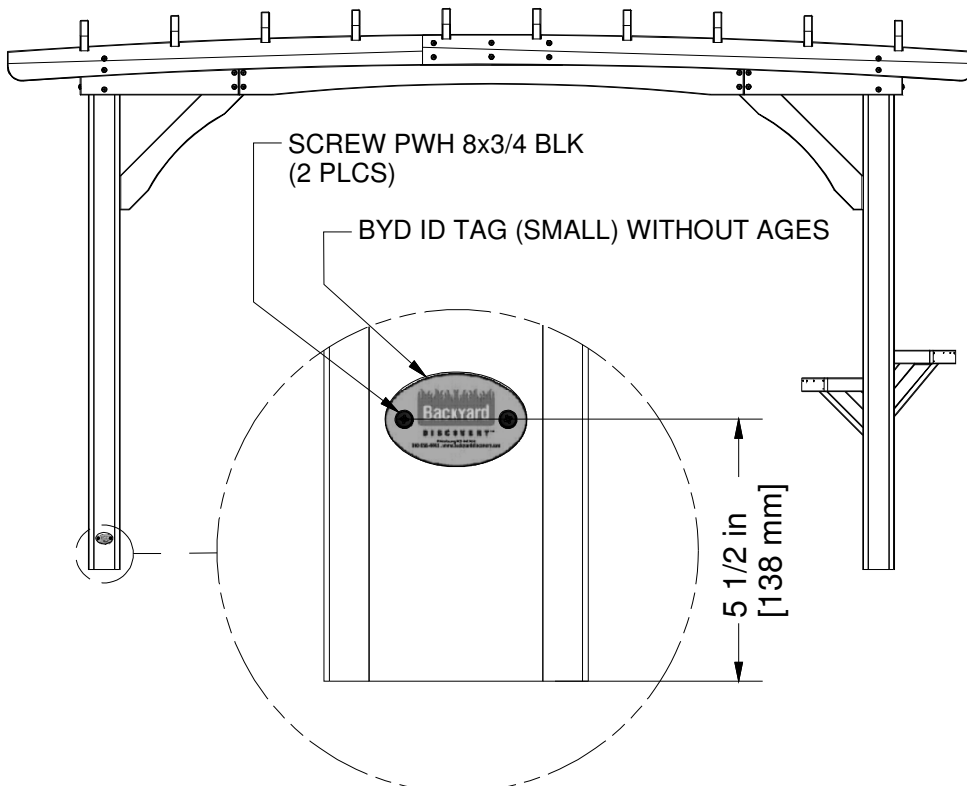

RIGHT SIDE

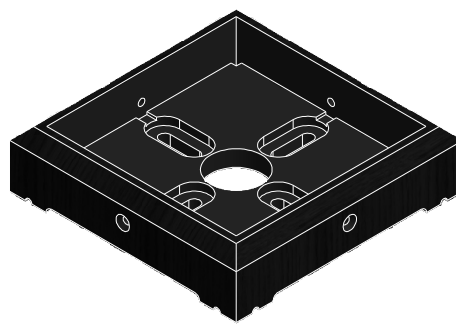



(4) *HT - FOOT 142 SQUARE POST - A100029*

STEP 19

DECIDE WHERE TO PLACE THE PERGOLA. NOTE THIS MOUNTING PROCEDURE IS MEANT TO BE USED ON CONCRETE ONLY.

PLACE THE PERGOLA EXACTLY WHERE IT WILL BE ANCHORED WHEN COMPLETED AND SLIDE A FOOT UNDER EACH POST.

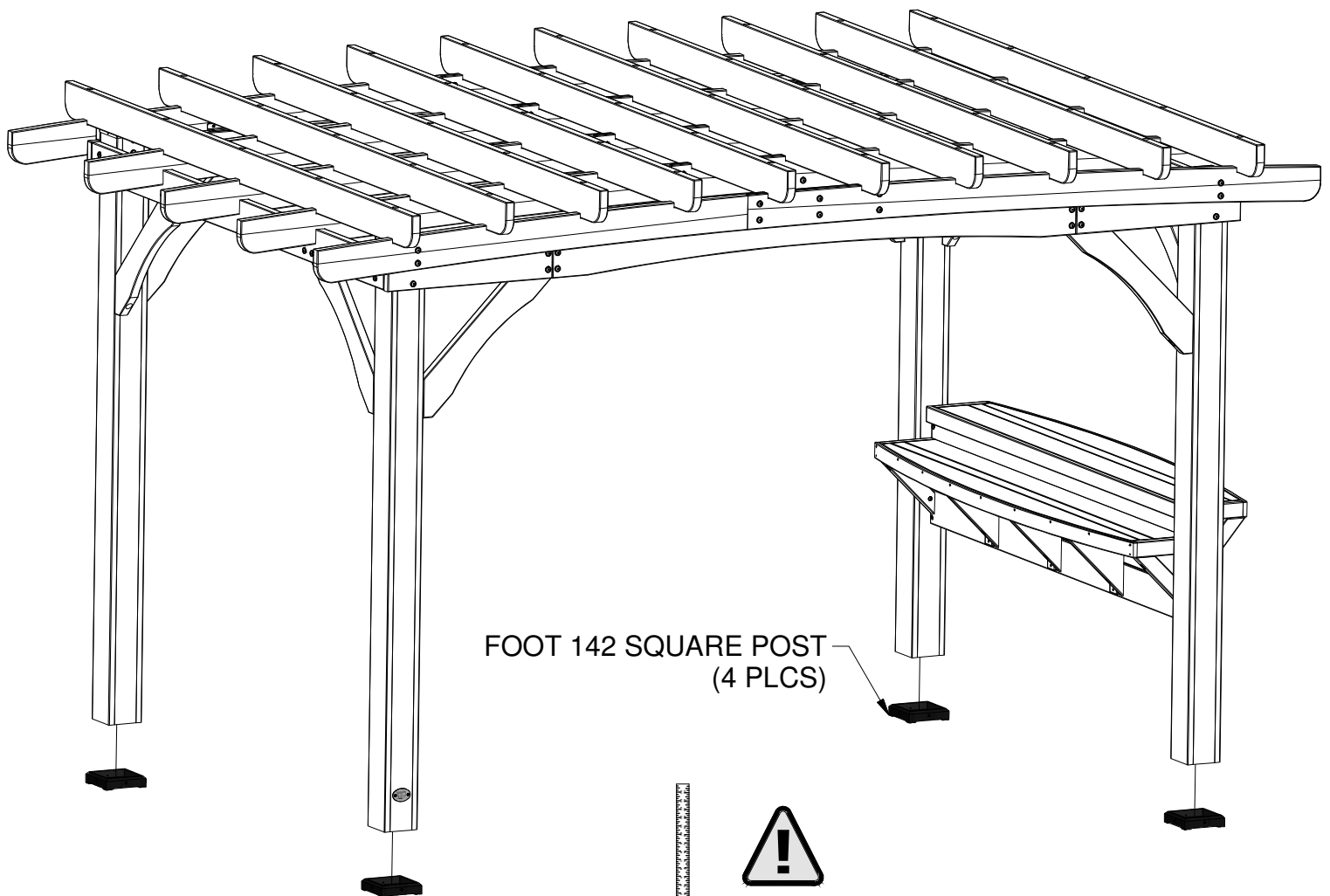

**SQUARE POSTS AND TIGHTEN
ALL BOLTS AND SCREWS AT
THIS TIME.**

STEP 20

USE CHALK TO TRACE AROUND THE EDGES OF EACH FOOT.

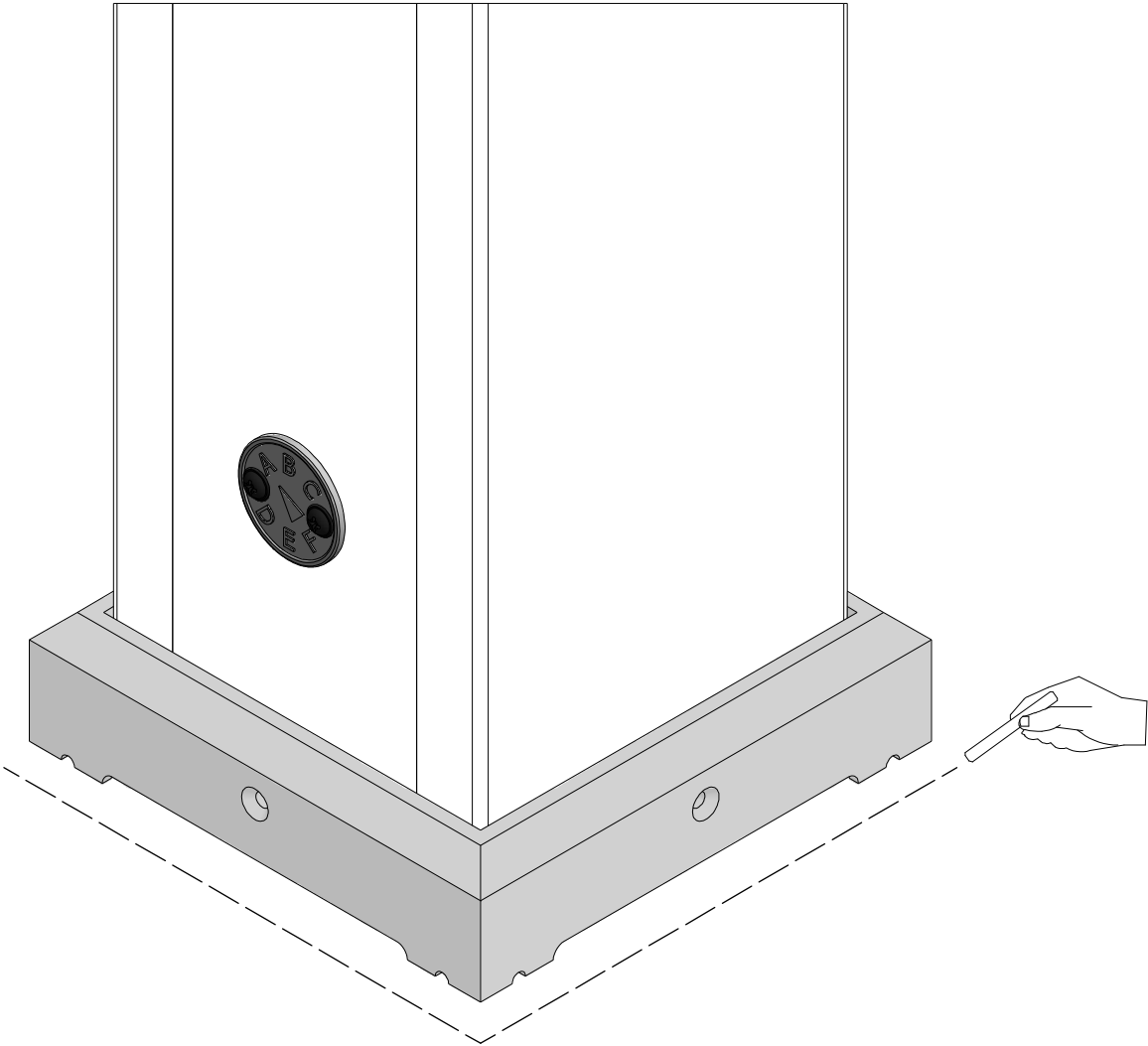

STEP 21

MOVE THE PERGOLA ASIDE. PLACE EACH FOOT INSIDE OF THE LINES DRAWN IN THE PREVIOUS STEP. USING A 3/16" CONCRETE DRILL BIT, PILOT DRILL ATTACHMENT HOLES INTO THE CONCRETE PAD.

NEXT, USE THE 1/4"x2" CONCRETE ANCHORS TO ATTACH EACH FOOT TO THE CONCRETE SURFACE.

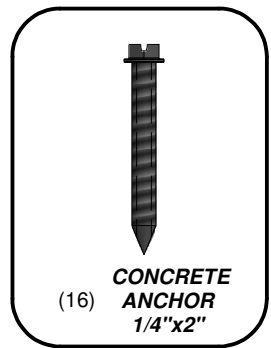

CONCRETE ANCHOR 1/4"x2"
(16 PLCS)

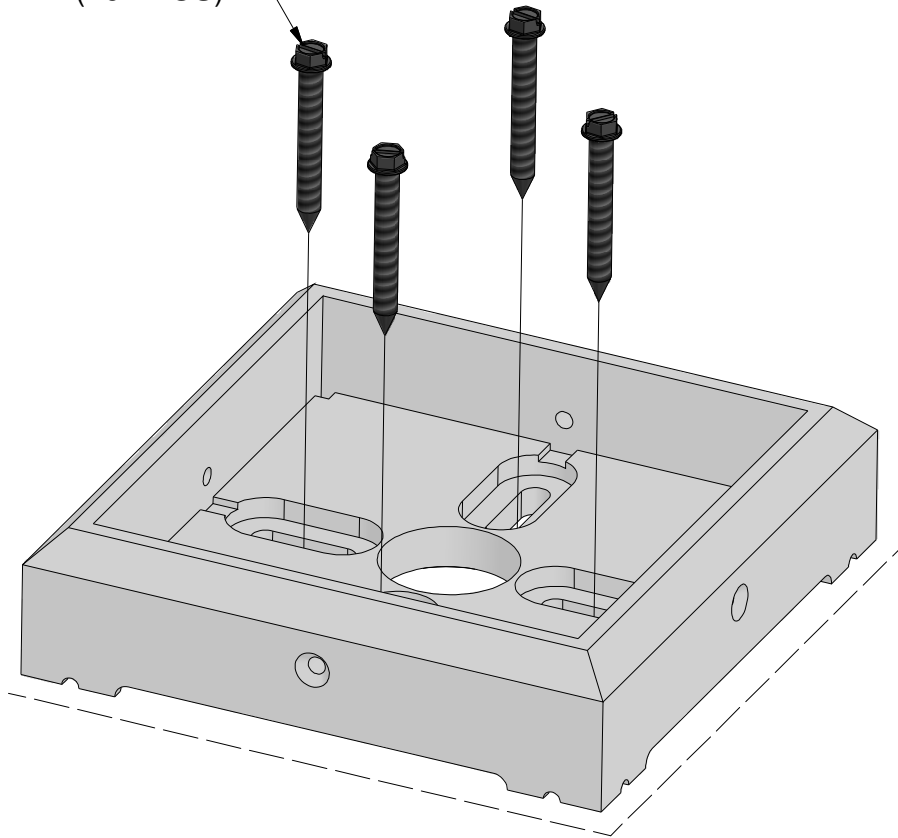

STEP 22

MOVE THE PERGOLA BACK IN TO PLACE, SETTING EACH POST INSIDE A FOOT AND MOUNT.



**SCREW PFH
(16) 8X1-1/2 BLK
H100200**

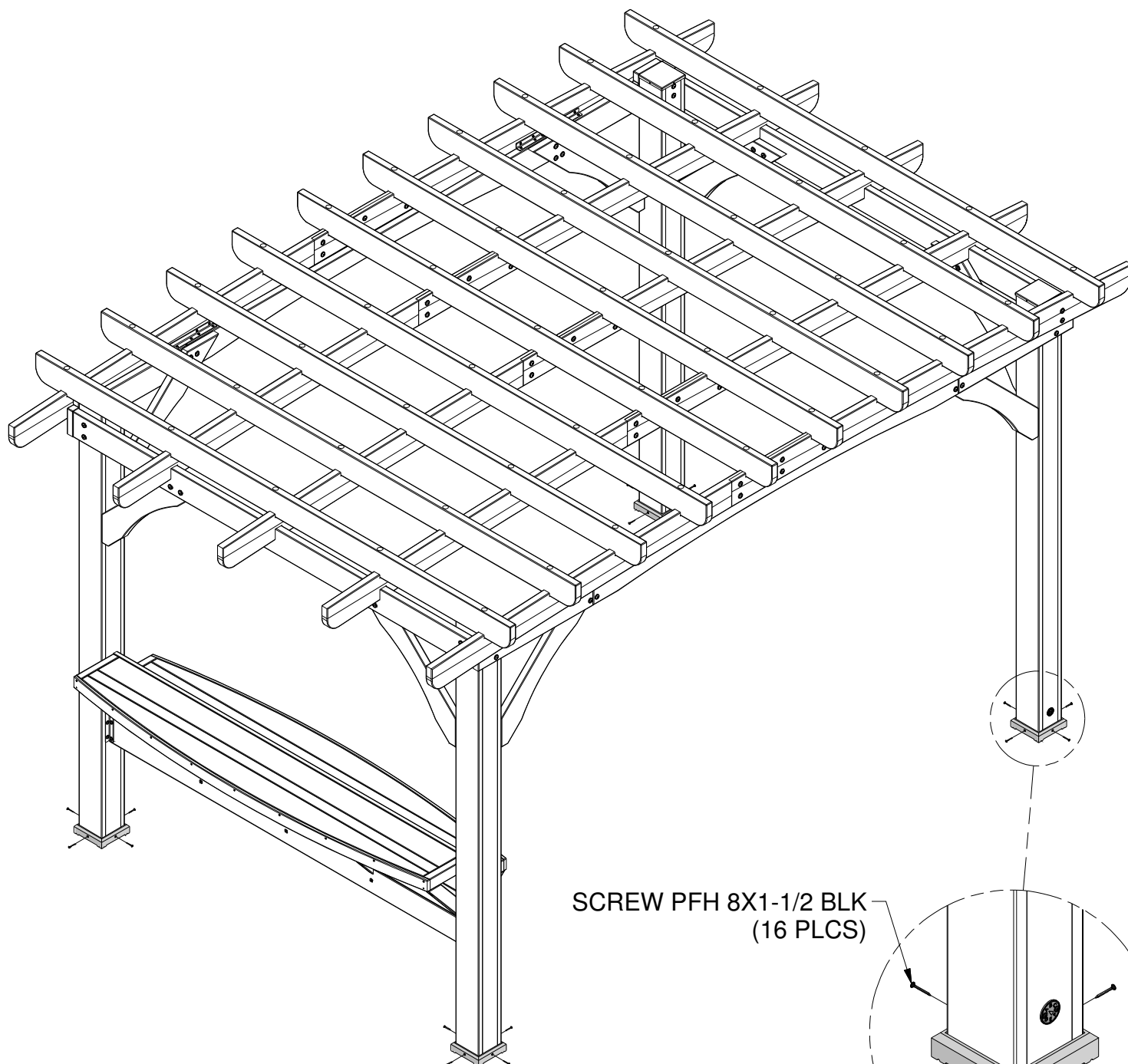

**SCREW PFH 8X1-1/2 BLK
(16 PLCS)**

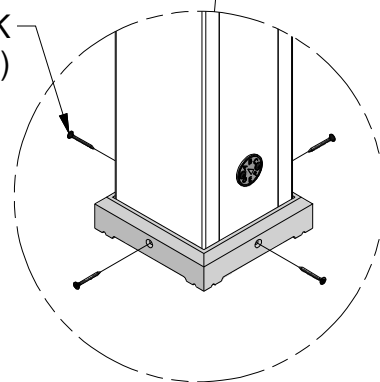

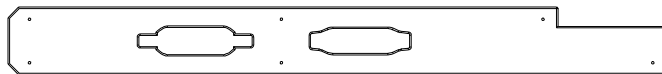

- (1) **D7 - CORD COVER - W4L12268**
1"x5 1/4"x51 5/8" (24x134x1310)

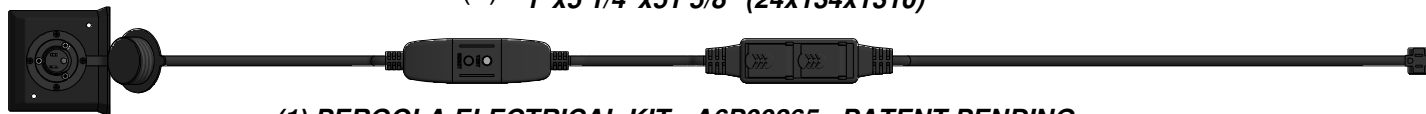

(1) PERGOLA ELECTRICAL KIT - A6P00265 - PATENT PENDING

STEP 23

PRESS THE ELECTRICAL CORD ASSEMBLY INTO THE CUT OUTS ON THE **D7** CORD COVER, AS SHOWN.

SCREW PFH
(8) 8X2-1/2 BLK
H100201

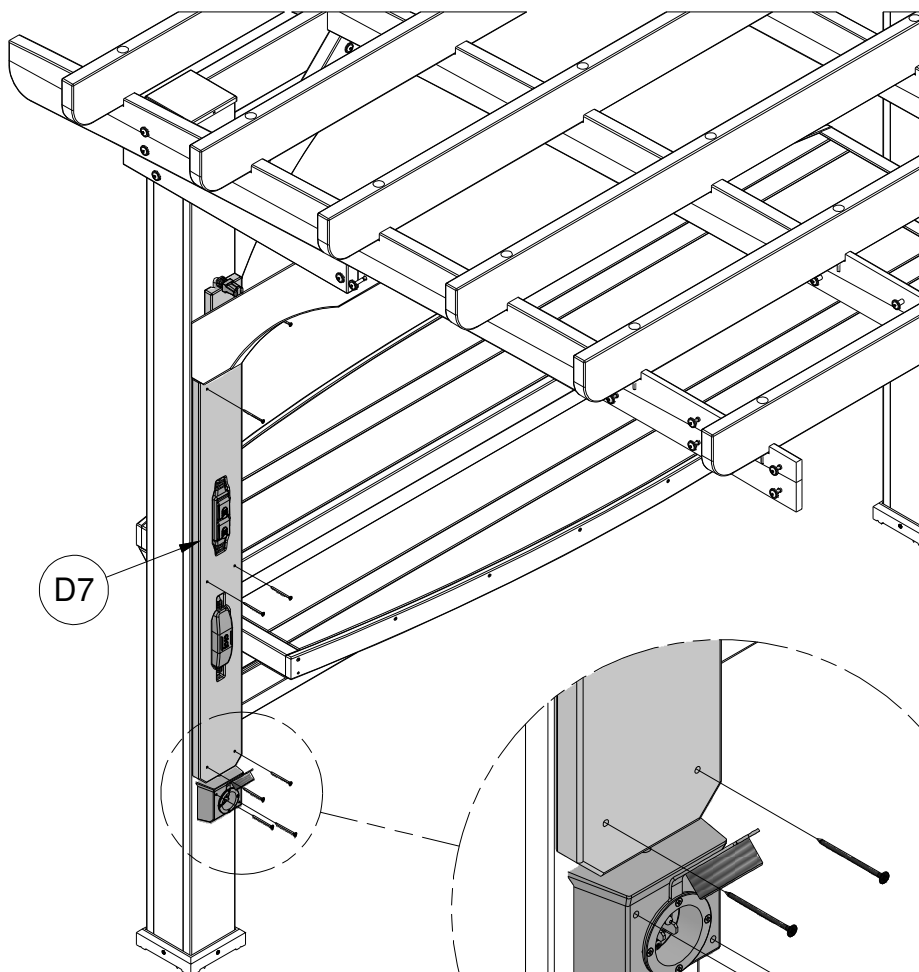
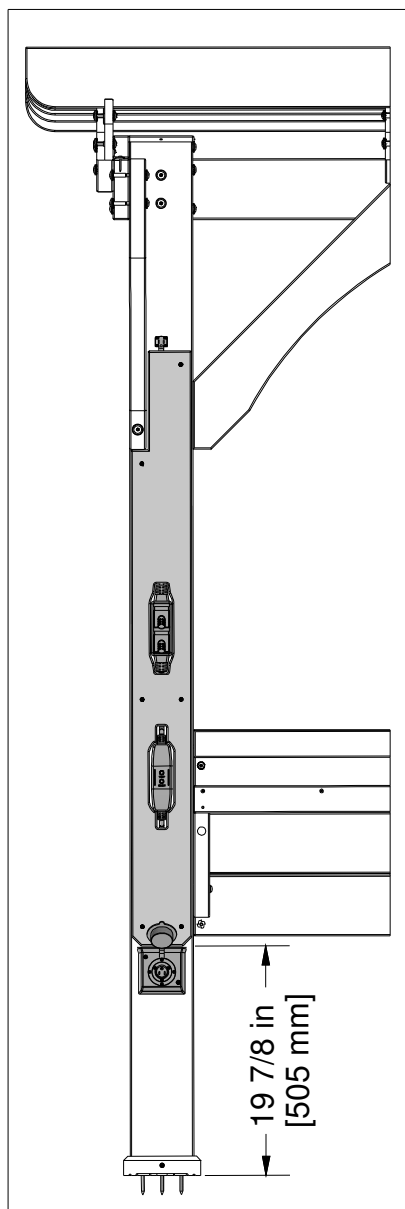
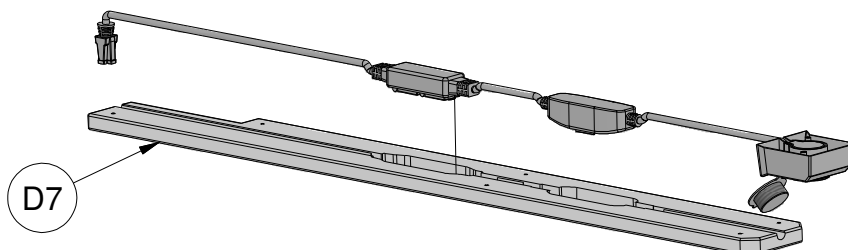

SCREW PFH 8X2-1/2 BLK
(8 PLCS)

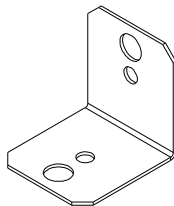

(2) - 90° L-BRACKET - BLK - A4M00555

STEP 24

PLACE L-BRACKETS NEXT TO THE CENTER BOLT AND MOUNT AS SHOWN.



(4) **SCREW**
PWH 8x3/4
BLK
H100392

