



MANUFACTURED BY:
Backyard Discovery
3305 Airport Drive, Pittsburg, KS 66762
800-856-4445

Basepoint Business Centre: Rivermead Drive, Westlea, Swindon SN5 7EX Phone: 0800-118-2476
J.P. Coenstraat 7, The Hague, 2595 WP, Netherlands Phone: 0800-567-8990

BIG BRUTUS

Swing Set

Model # 1952050D

The assembly manual must be retained
since it contains important information



WARNING

Adult Assembly Required.

Not suitable for children under 36 months due to small parts.

FOR DOMESTIC USE ONLY. INTENDED FOR OUTDOOR USE.



Please visit www.backyarddiscovery.com

For the most up to date assembly manual, to register your set, or to order replacement parts

Para obtener instrucciones en español, visite www.backyarddiscovery.com



**INSTALLATION
SERVICES
AVAILABLE!**
See inside for details

Made in China
INS-1952050D-A-BIG BRUTUS-ENG 05-12-23

Owner's Manual - Basic Setup Dimensions & Assembly Notes

Place the set on level ground, not less than 6'-7" [2 m] from any structure or obstruction such as a fence, garage, house, overhanging branches, laundry lines, or electrical wires.

- While assembling unit, take time before and after each phase to make sure fort is level. If fort is not level, assembly will be difficult and improper assembly may result. Extra care must be taken to insure the fort is square.
- The safe play area refers to a zone extending 6'-7" (2 m) beyond the play product on all sides, including the space above the play product.

SAFE PLAY AREA DIAGRAM

Ground Dimensions

9'-7" [2.9 m] x 13'-2 3/4" [4.0 m]

Safe Play Area

22'-8 1/2" [6.9 m] x 26'-4 1/4" [8.0 m]
x 15'-10 1/2" [4.8 m]

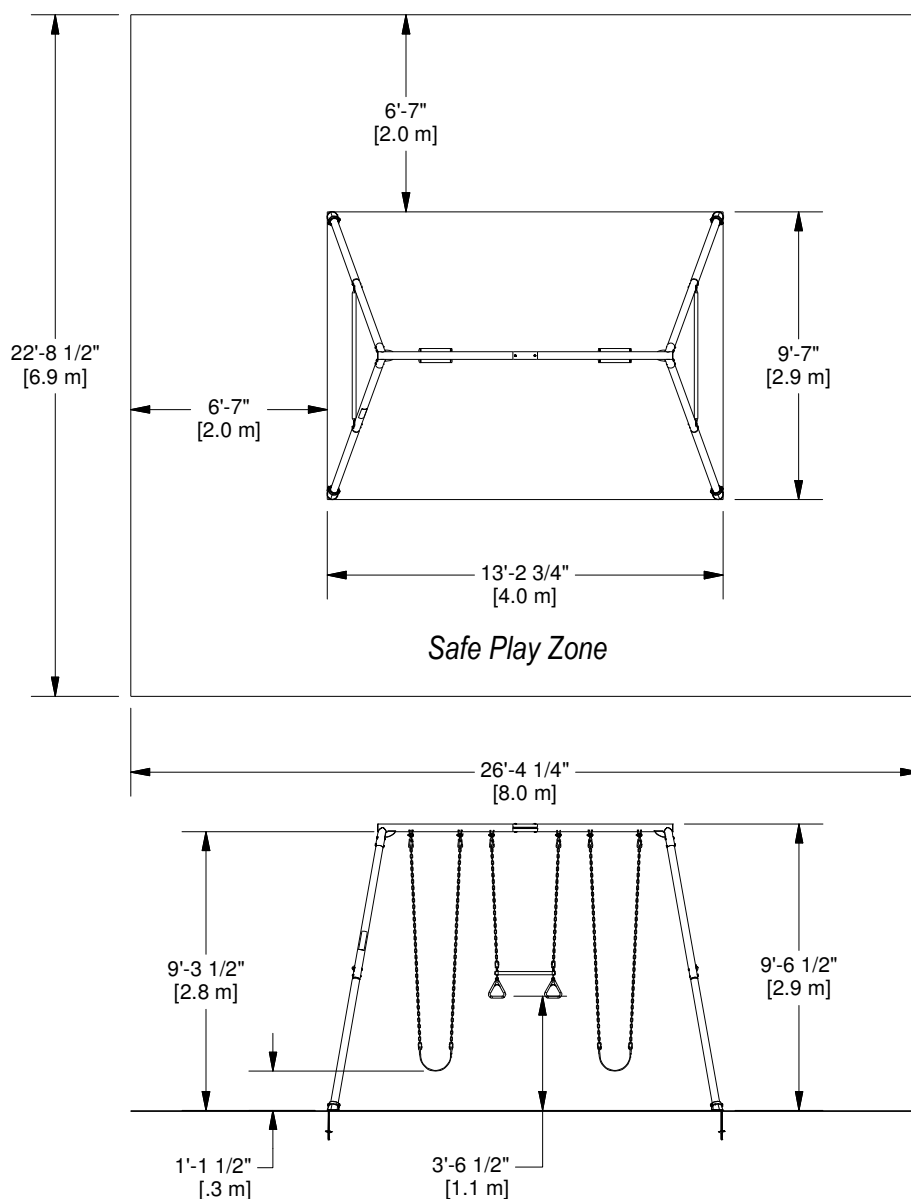

SAFE PLAY HEIGHT: 15'-10 1/2" [4.8 m]
MAXIMUM FALL HEIGHT: 9'-3 1/2" [2.8 m]

General Information:

Your set has been designed and engineered for children only and for residential use only.
A maximum of 150 lbs. per child is recommended for play activities designed for individual use.
A maximum of 120 lbs. per child is recommended for play activities designed for multiple child use.
A maximum of 9 children is recommended for this swing set.

Owner's Manual - Parts Identification

Hardware Components

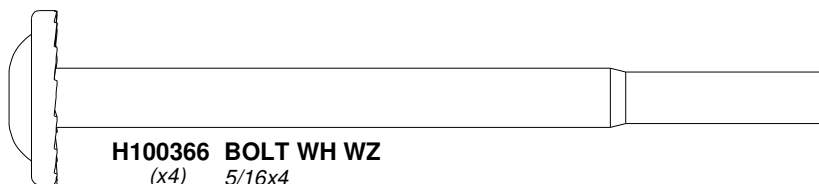

H100366 BOLT WH WZ
(x4) 5/16x4

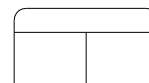

H100819 LOCK NUT WZ
(x6) M12

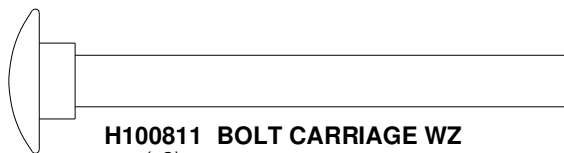

H100811 BOLT CARRIAGE WZ
(x2) 5/16x2 3/4

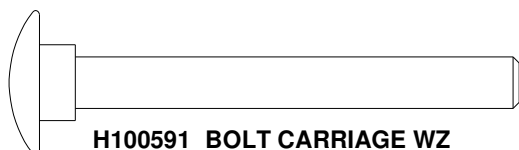

H100591 BOLT CARRIAGE WZ
(x16) 5/16x2 1/2

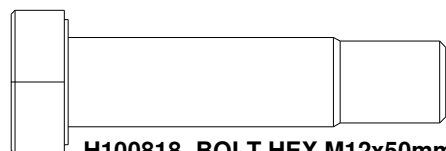

H100818 BOLT HEX M12x50mm WZ
(x6) M12x 50mm

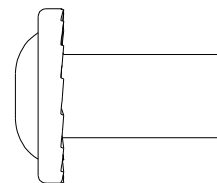

H100499 NUT BARREL WH WZ
(x22) 5/16x7/8



H100114 TORX WRENCH
(x1) T-30



H100147 TORX BIT
(x1) T-30

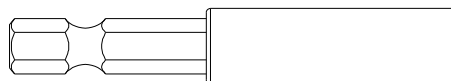

H101100 MAGNETIC DRIVER
(x1)

Owner's Manual - Parts Identification

Accessory Components (Not to Scale)



A4M01925
(x4) **BOTTOM LEG**

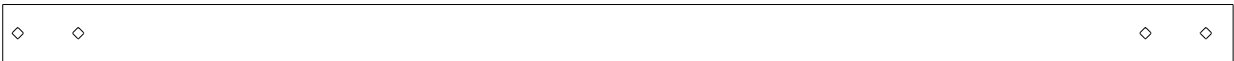

A4M01926
(x4) **TOP LEG**

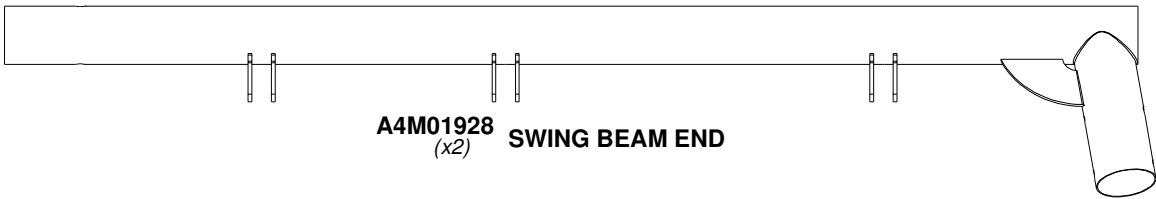

A4M01928
(x2) **SWING BEAM END**

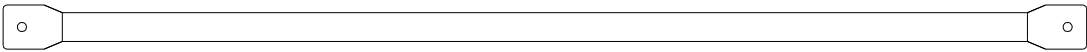

A4M01927
(x2) **SIDE BAR**

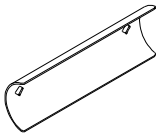

A4M01024
(x2) **METAL
BRACKET
GREEN**

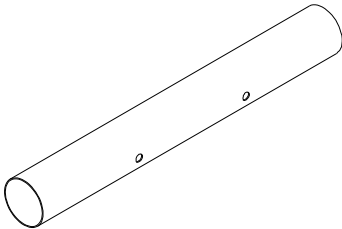

A4M01022
(x1) **TOP BEAM
CONNECTING
TUBE**

Owner's Manual - Parts Identification

Accessory Components (Not to Scale)

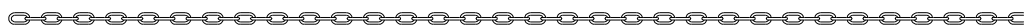

A4M01953
(x4) **CHAIN GREEN 79.75"**

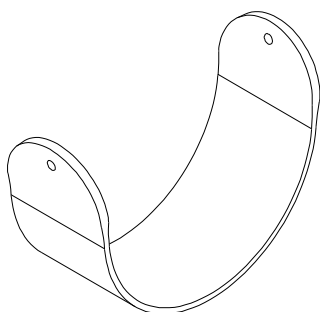

A6P00362
(x2) **26" HD BELT SWING**

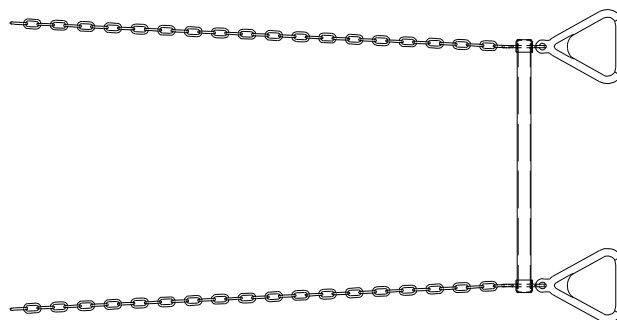

A4M00508
(x1) **6' TRAPEZE ASSEMBLY**

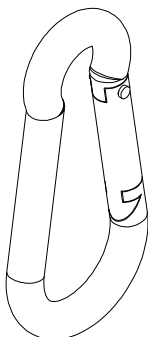

A4M01044
(x6) **CARABINER SD**

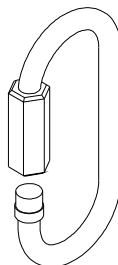

H100242
(x4) **QUICK LINK (LONG) WZ**

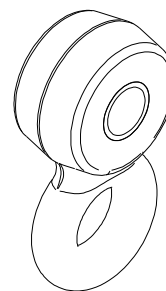

A4M01040
(x6) **DUCTILE HANGER**

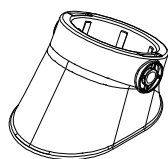

A6P00366
(x4) **SWING SET FOOT**



A100178
(x4) **AUGER GROUND STAKE**



A6P00435
(x1) **WARNING LABEL STICKER**



A6P00375
(x1) **BYD TAG STICKER (SMALL)**

PRE-ASSEMBLY STEP 1 - SORTING PARTS

It is critical for ease of assembly that you take the time to sort and organize the parts and hardware.

METAL PARTS:

- Organize metal parts by the three-digit, alpha-numeric number stamped on each part (ex. P01).
- If there are multiple parts with the same stamped number, stack those pieces together.
- Stamps can be found on the flat surface of the parts or on the end of the parts.
- Allow yourself plenty of room - the parts can take up a significant amount of space.

NOTE: CARTONS ARE NOT ORGANIZED BY PART NUMBER.

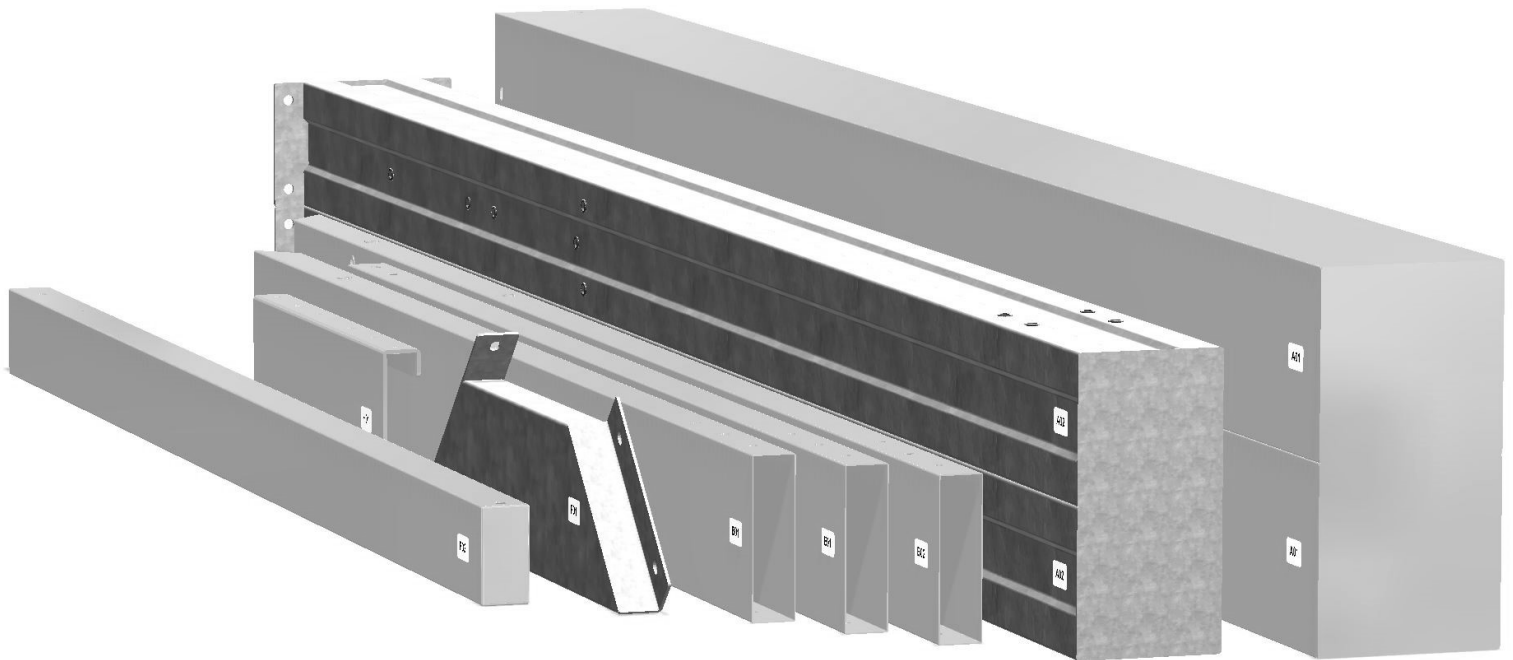

HARDWARE PARTS:

- We recommend that you have a separate table to organize the hardware.
- Hardware bags are printed with a seven-digit, alpha-numeric part number.
- You can organize your hardware by part number or group by hardware type (i.e. bolts, nuts, etc.).
- During assembly you only need to reference the last four digits of the number.

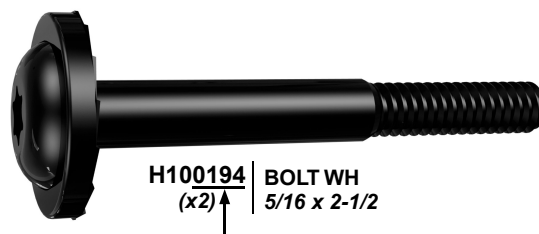

PRE-ASSEMBLY STEP 2 - TOOLS REQUIRED



**Cordless Drill or
Electric Drill**



**Drill Attachments:
Phillips Head**



**1/8", 3/16", 3/8" & 7/16"
Drill Bits**



Phillips Screw Driver



Open End Wrenches 1/2" & 9/16"



**3/8" Drive Ratchet, 1/2" &
9/16" STD Sockets 1/2" & 9/16" Deep
Sockets**



Claw Hammer



Rubber Mallet - Optional



Tape Measure

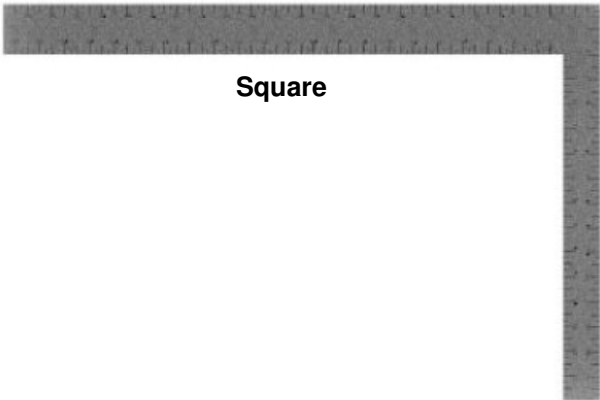

Square



Level 24"

STEP 1 - FORT ASSEMBLY

QTY	PART NUMBER	DESCRIPTION
4	H100499	NUT BARREL WH 5/16x7/8 WZ
4	H100591	BOLT CARRIAGE 5/16x2-1/2 WZ

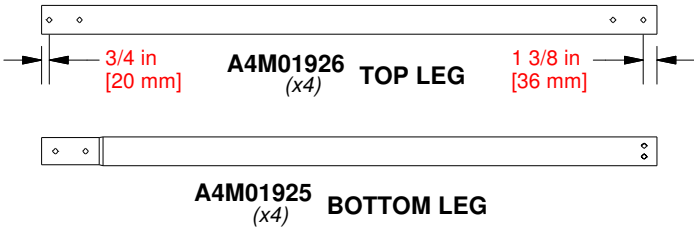

REPEAT THIS STEP 4 TIMES.

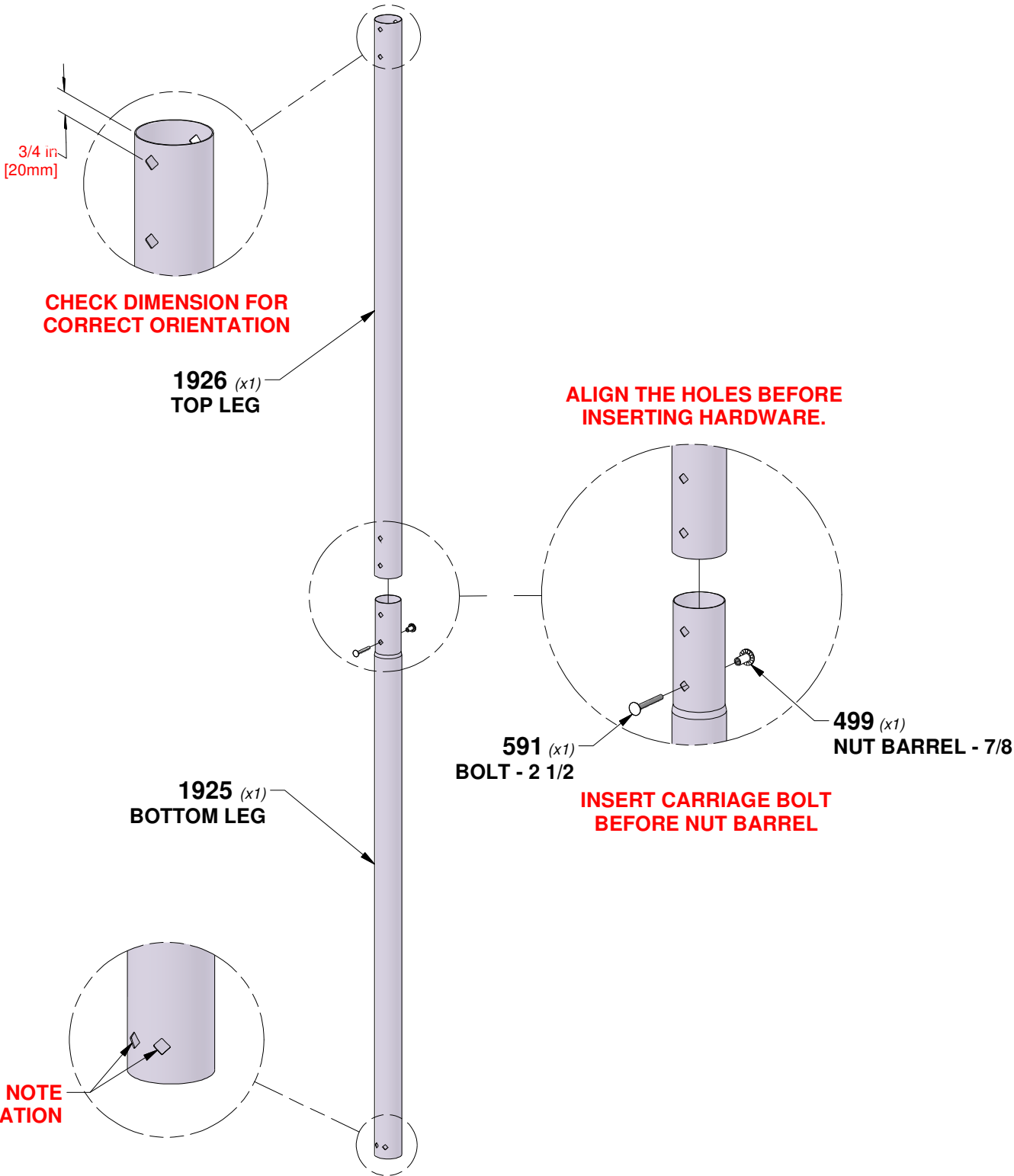

STEP 2 - FORT ASSEMBLY

QTY	PART NUMBER	DESCRIPTION
2	H100499	NUT BARREL WH 5/16x7/8 WZ
2	H100811	BOLT CARRIAGE 5/16x2-3/4 WZ

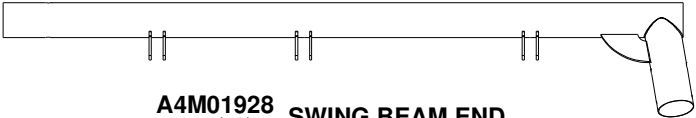

A4M01928 (x2) SWING BEAM END



A4M01022 (x1) TOP BEAM CONNECTING TUBE

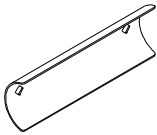

A4M01024 (x2) METAL BRACKET GREEN

NOTE:
INSERT CONNECTING TUBE INTO SWING
BEAM TUBES & ALIGN THE HOLES.

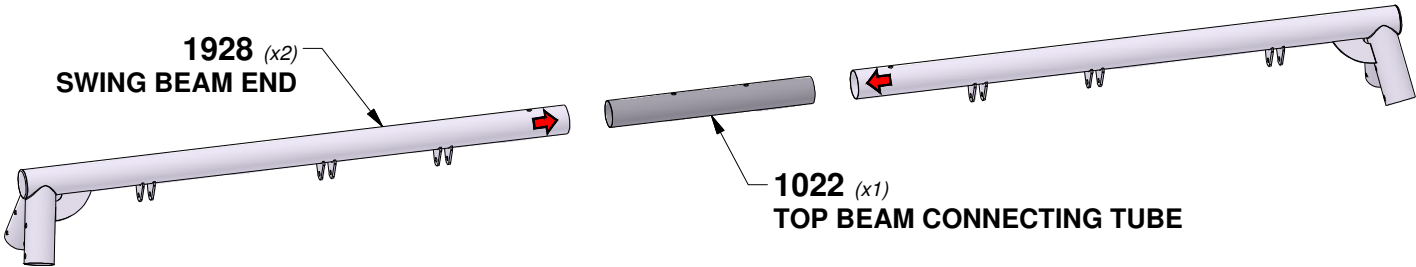

ALIGN ALL HOLES AND
ASSEMBLE USING THE METAL
BRACKETS AS SHOWN.

811 (x2)
BOLT - 2 3/4

1024 (x2)
METAL BRACKET GREEN

499 (x2)
NUT BARREL - 7/8

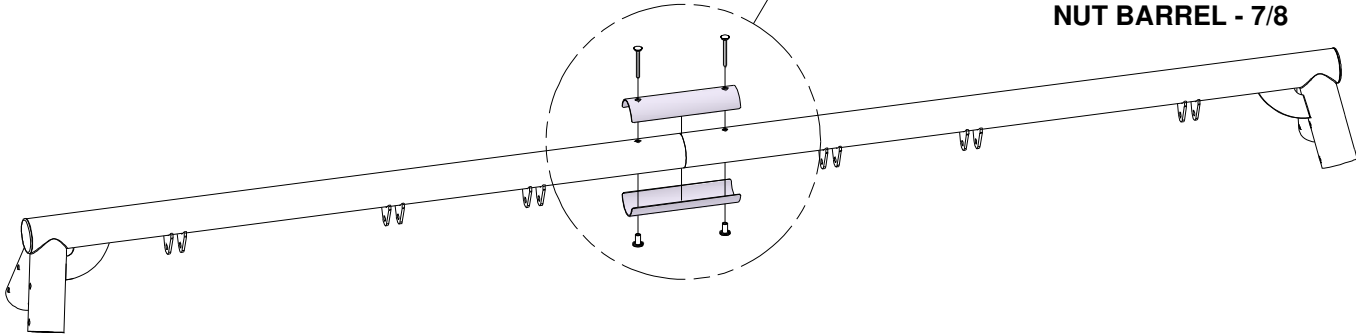

STEP 3 - FORT ASSEMBLY

QTY	PART NUMBER	DESCRIPTION
6	H100818	BOLT HEX M12x50mm WZ
6	H100819	LOCK NUT M12 WZ

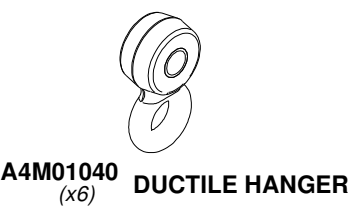
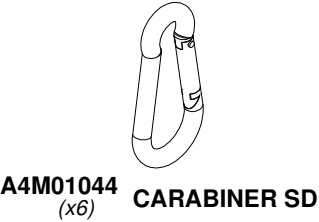

NOTE:
ATTACH CARABINER CLIPS TO DUCTILE
HANGERS, THEN INSTALL & BOLT DUCTILE
HANGERS AS SHOWN.

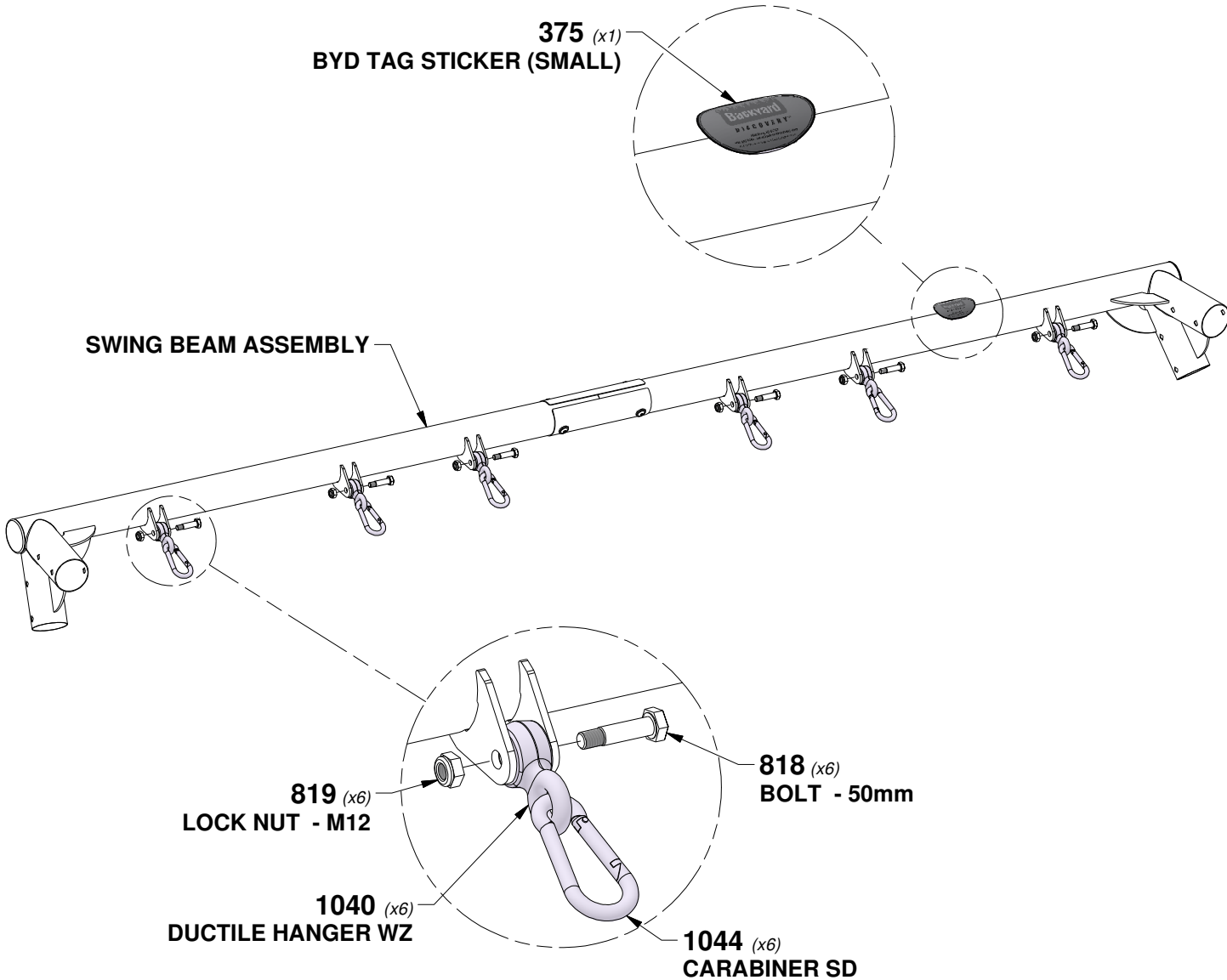

STEP 4 - FORT ASSEMBLY

QTY	PART NUMBER	DESCRIPTION
8	H100499	NUT BARREL WH 5/16x7/8 WZ
8	H100591	BOLT CARRIAGE 5/16x2-1/2 WZ

NOTE:
INSERT LEG ASSEMBLIES INTO SWING BEAM
ASSEMBLY & ALIGN THE HOLES BEFORE
INSERTING HARDWARE.

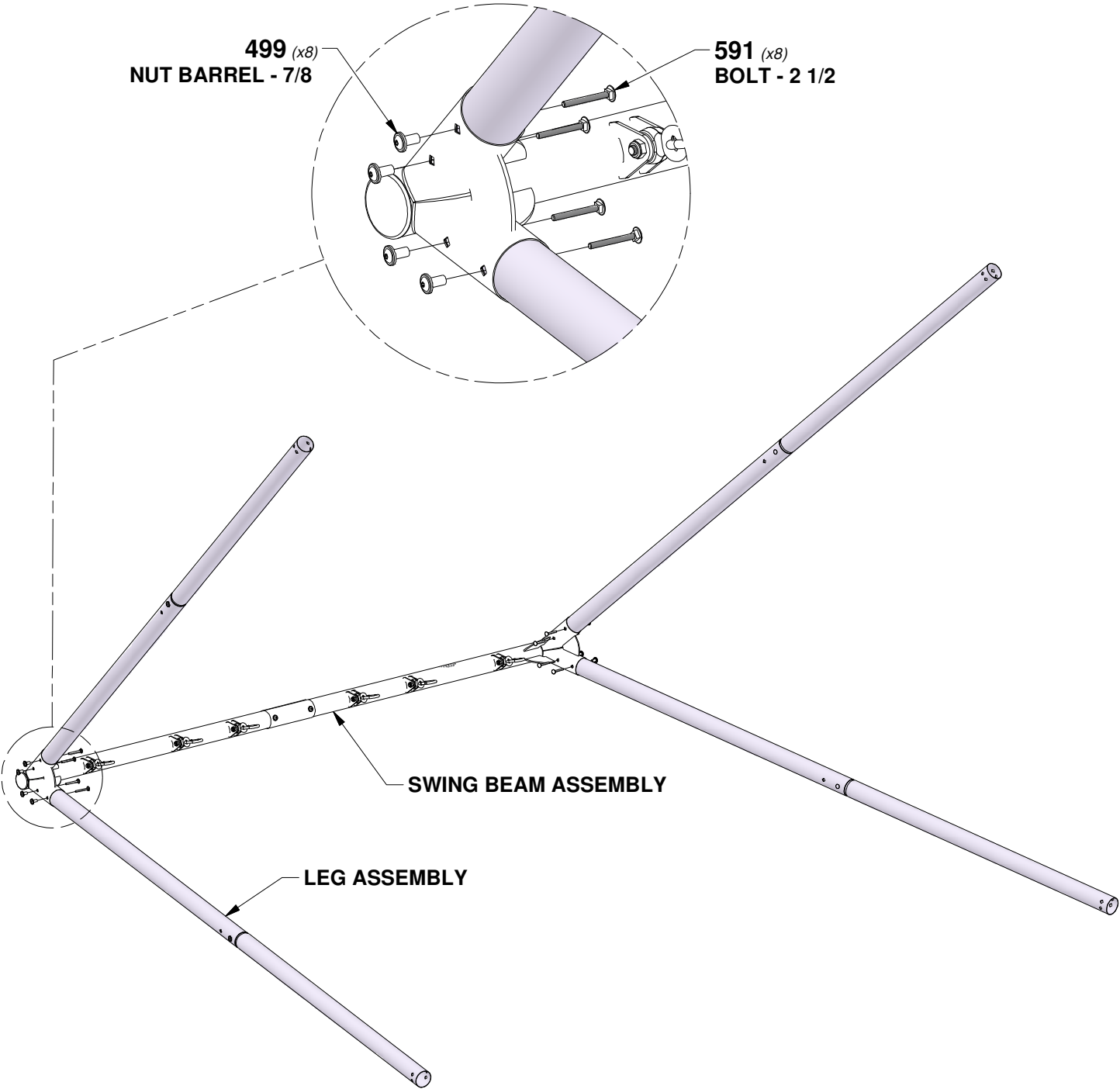

STEP 5 - FORT ASSEMBLY

QTY	PART NUMBER	DESCRIPTION
4	H100499	NUT BARREL WH 5/16x7/8 WZ
4	H100591	BOLT CARRIAGE 5/16x2-1/2 WZ



A4M01927
(x2) **SIDE BAR**

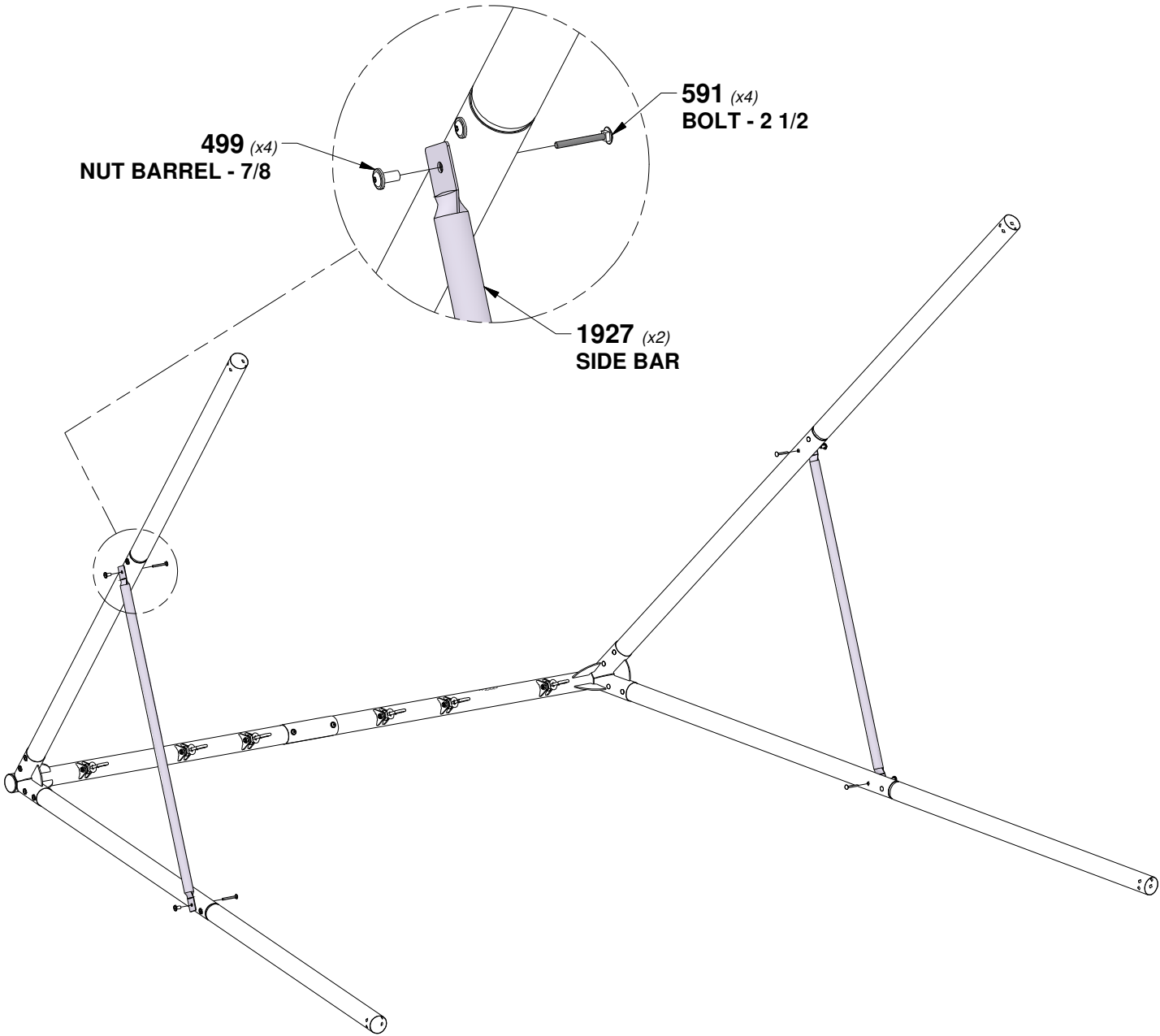

STEP 6 - FORT ASSEMBLY



A4M01953
(x4) **CHAIN GREEN 79.75"**

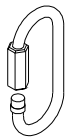

H100242
(x4) **QUICK LINK (LONG) WZ**

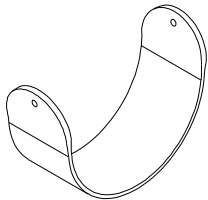

A6P00362
(x2) **26" HD BELT SWING**

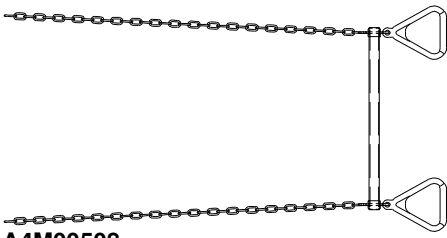

A4M00508
(x1) **6' TRAPEZE ASSEMBLY**

TIP:
INSTALL SWINGS AND TRAPEZE BEFORE
STANDING PLAY SET UP TO AVOID USE
OF A LADDER.

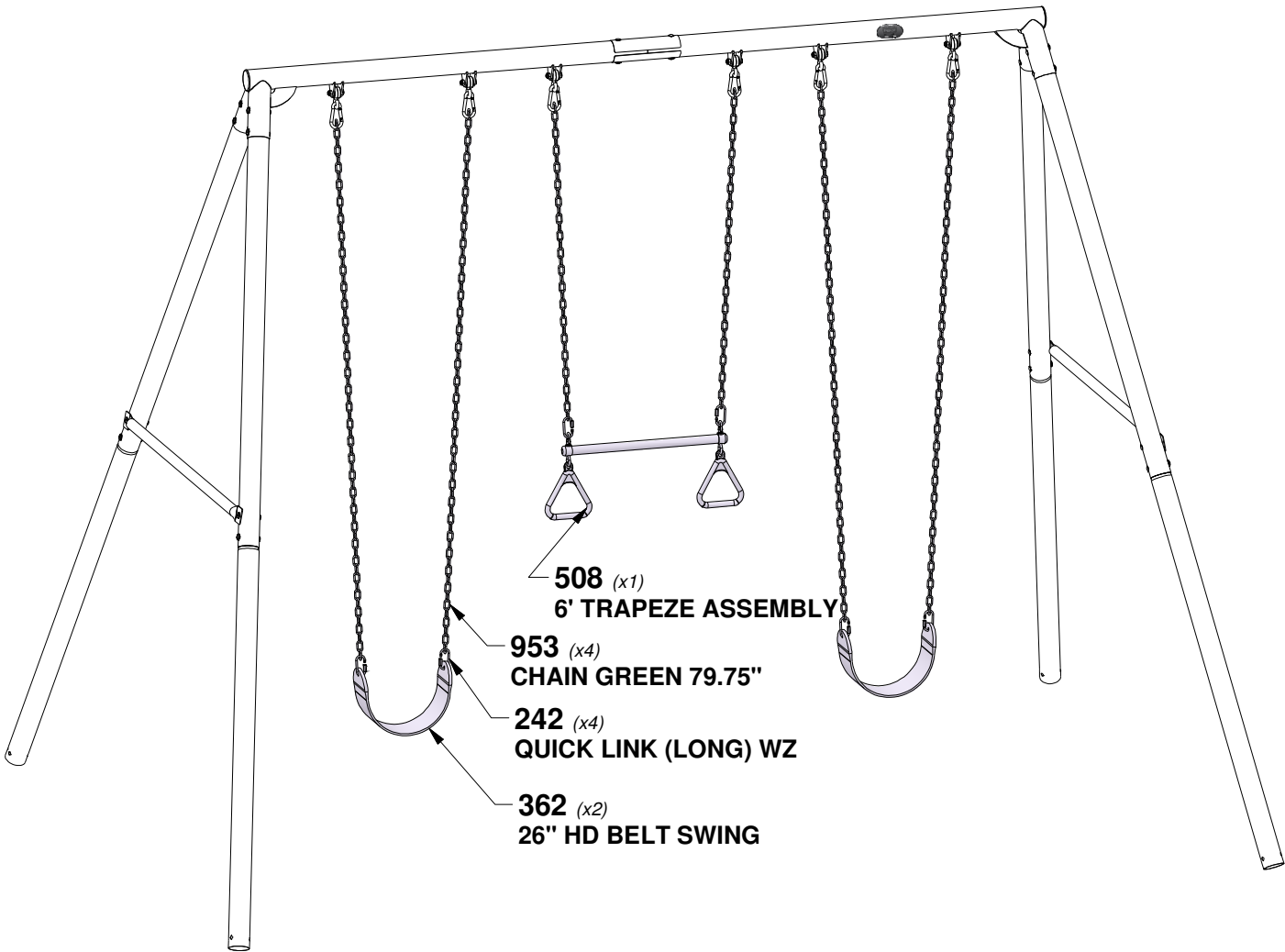
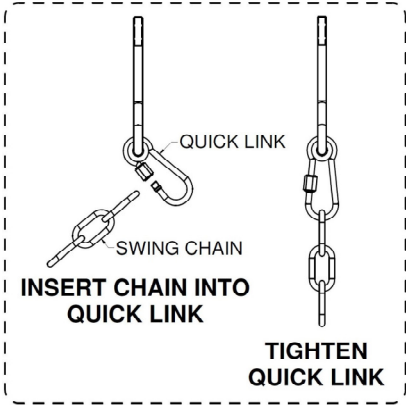
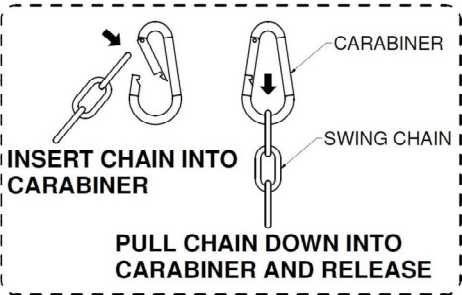

STEP 7 - FORT ASSEMBLY

QTY	PART NUMBER	DESCRIPTION
4	H100278	WASHER FLAT 5/16 WZ
4	H100366	BOLT WH 5/16x4 WZ
4	H100499	NUT BARREL WH 5/16x7/8 WZ



A6P00366 (x4) SWING SET FOOT

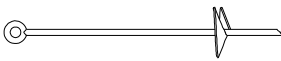

A100178 (x4) AUGER GROUND STAKE



A6P00435 (x1) WARNING LABEL STICKER

NOTE:
CENTER & PLACE THE WARNING LABEL IN THE
APPROXIMATE LOCATION SHOWN BELOW.

