



Manufactured by:
Backyard Discovery
3305 Airport Drive, Pittsburg, KS 66762
800-856-4445

Basepoint Business Centre: Rivermead Drive, Westlea, Swindon SN5 7EX Phone: 0800-118-2476

J.P. Coenstraat 7, The Bridge, The Hague, 2595 WP, Netherlands Phone: 08005678990

LITTLE DURANGO

SWING SET

MODEL: # 2101043



WARNING

Adult Assembly Required.

The assembly manual must be retained since it contains important information
Not suitable for children under 36 months due to small parts.

FOR DOMESTIC USE ONLY. INTENDED FOR OUTDOOR USE.



Please visit www.backyarddiscovery.com

For the most up to date assembly manual, to register your product, or to order replacement parts

Para obtener instrucciones en español, visite www.backyarddiscovery.com



**EASY STEP-BY-STEP
3D INTERACTIVE INSTRUCTIONS**
DOWNLOAD THE FREE APP



Made in China

INS-2101043-LITTLE DURANGO-ENG 7-28-23



Place the set on level ground, not less than 6'-7" [2 m] from any structure or obstruction such as a fence, garage, house, overhanging branches, laundry lines, or electrical wires.

- While assembling unit, take time before and after each phase to make sure fort is level. If fort is not level, assembly will be difficult and improper assembly may result. Extra care must be taken to insure the fort is square.
- The safe play area refers to a zone extending 6'-7" (2 m) beyond the play product on all sides, including the space above the play product.

SAFE PLAY AREA DIAGRAM

Ground Dimension

9.1 ft [2.8m] x 8.1 ft [2.5m]

Safe Play Area

22.2 ft [6.8m] x 21.3 ft [6.5m]

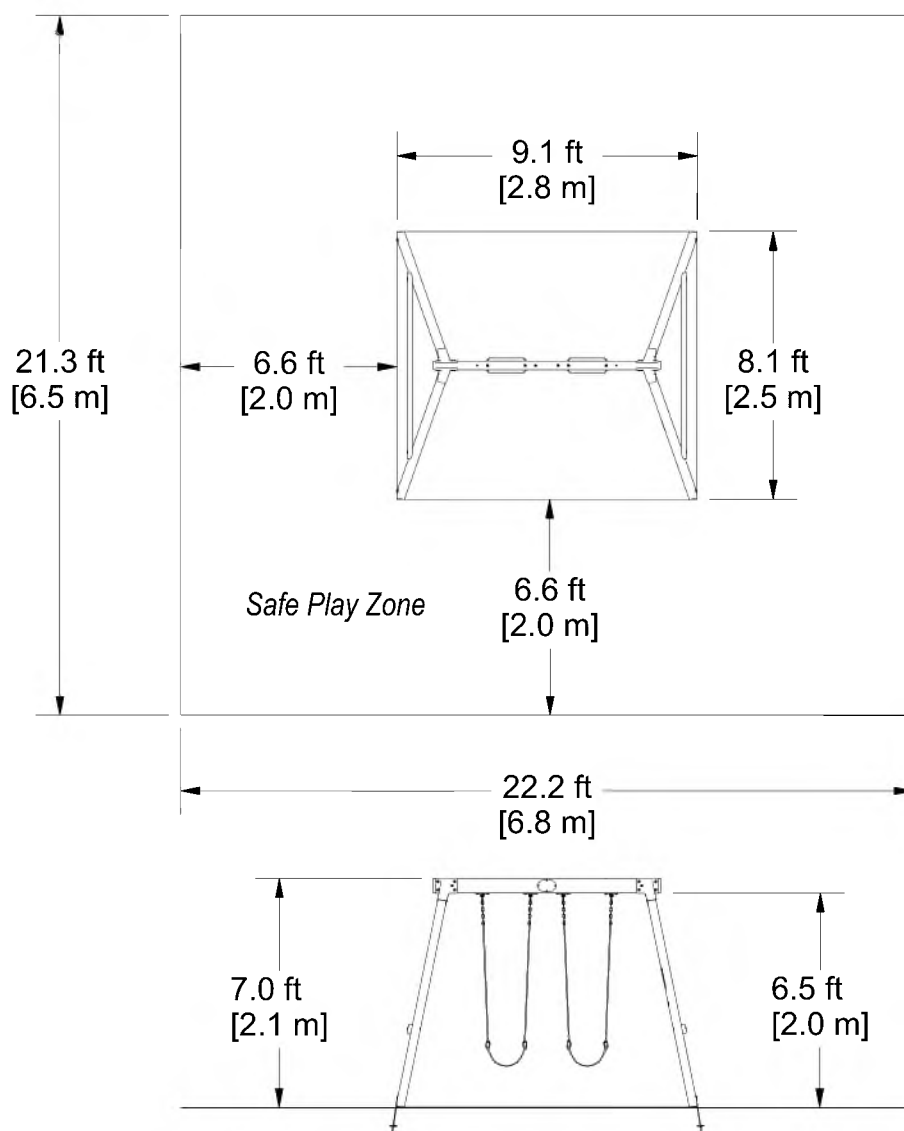

SAFE PLAY HEIGHT: 13.5 ft [4.1 m]
MAXIMUM FALL HEIGHT: 6.5 ft [2.0m]

General Information:

Your set has been designed and engineered for children only and for residential use only.
A maximum of 150 lbs. per child is recommended for play activities designed for individual use.
A maximum of 120 lbs. per child is recommended for play activities designed for multiple child use.
A maximum of 2 children is recommended for this swing set.



Wood Components (Not to Scale)



B2 | POST - W2A03240
(1) | 2 7/8"x2 7/8"x90 3/4" (72x72x2305)



B1 | POST - W4L15376
(3) | 2 7/8"x2 7/8"x90 3/4" (72x72x2305)



A1 | SWING BEAM - W4L15377
(1) | 3 1/4"x5 1/4"x83" (81x134x2108)



E1 | BRACE - W4L15378
(2) | 1 3/8"x3 3/8"x68" (34x86x1727)



Hardware Components

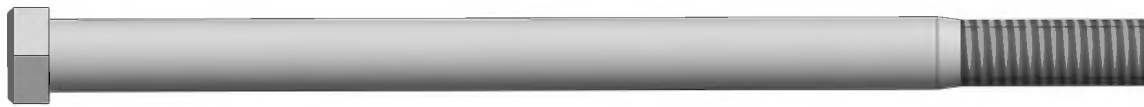

H100056 | BOLT HEX
(9) | 3/8x5 3/4

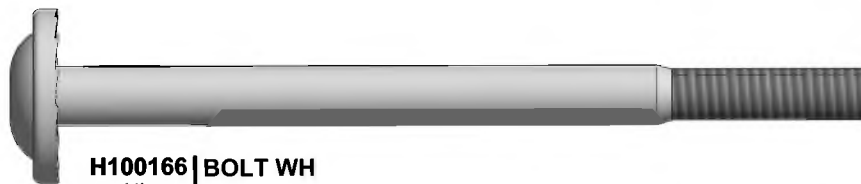

H100166 | BOLT WH
(4) | 5/16x4-1/4

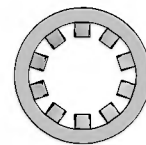

H100107 | WASHER LOCK INT
(9) | 10x18

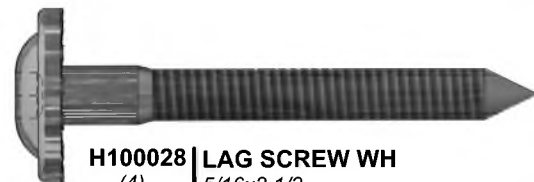

H100028 | LAG SCREW WH
(4) | 5/16x2 1/2



H100030 | WASHER LOCK EXT
(4) | 8x19



H100014 | BOLT WH
(11) | 5/16x2 1/2

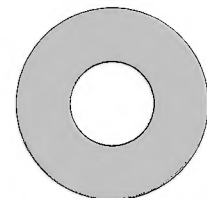

H100102 | WASHER FLAT
(9) | 11x25



H100012 | BOLT WH
(9) | 5/16x2

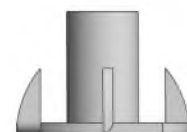

H100074 | T-NUT
(4) | 5/16



H100006 | NUT BARREL WH
(20) | 5/16x1 1/2



H100128 | SCREW PWH
(7) | 8x5/8

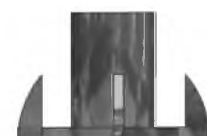

H100073 | T-NUT
(9) | 3/8



Accessory Components (Not to Scale)



A100314
(1) | "A" REVISION TAG



A6P00054
(2) | SWING SEAT GREEN 22"



A100164
(1) | BYD ID TAG (LARGE) AGES 3-10



A4M00505
(4) | SWING HANGER



A100069
(4) | QUICK LINK



A100178
(4) | AUGER GROUND STAKE

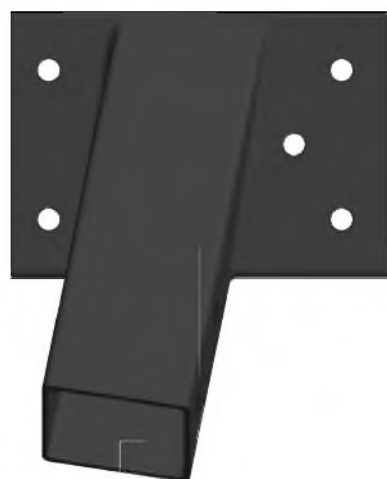

A4M01299
(2) | Y-Bracket (Left)



A4M01300
(2) | Y-Bracket (Right)



A100042
(2) | T-40 TORX BIT



A100041
(2) | T-40 TORX WRENCH

A100087
(4) | ROPE-CHAIN GREEN 51.25"

PRE-ASSEMBLY STEP 1 - SORTING PARTS

It is critical for ease of assembly that you take the time to sort and organize the wood and hardware.

WOOD PARTS:

- Organize wood parts by the three-digit, alpha-numeric number stamped on each board (ex. P01).
- If there are multiple boards with the same stamped number, stack those pieces together.
- Stamps can be found on the flat surface of the boards or on the end of the boards.
- Allow yourself plenty of room - the wood pieces can take up a significant amount of space.

NOTE: CARTONS ARE NOT ORGANIZED BY BOARD NUMBER.

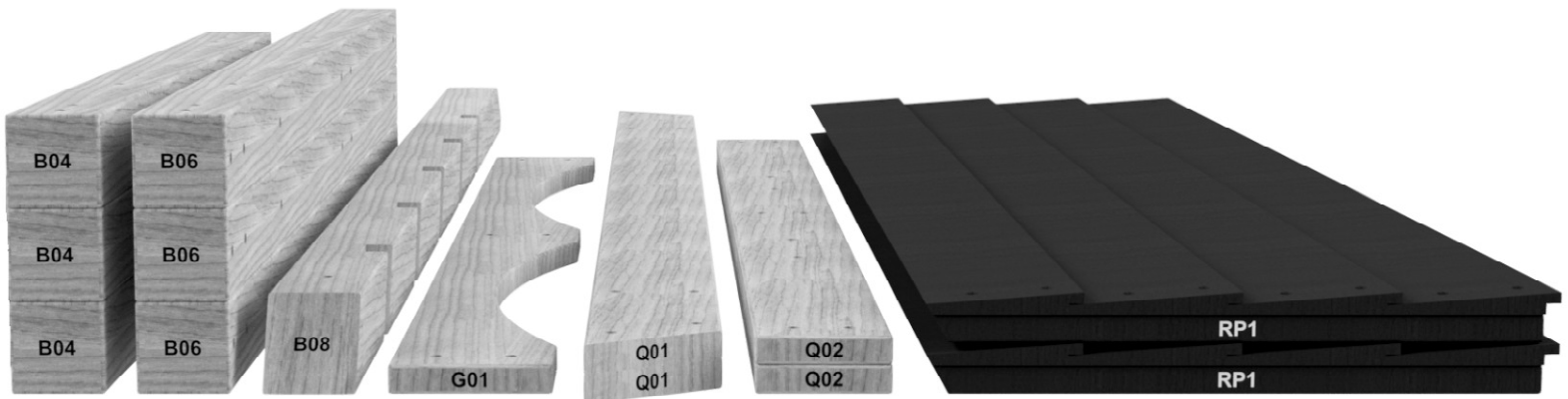

HARDWARE PARTS:

- We recommend that you have a separate table to organize the hardware.
- Hardware bags are printed with a seven-digit, alpha-numeric part number.
- You can organize your hardware by part number or group by hardware type (i.e. bolts, nuts, etc.).
- During assembly you only need to reference the last four digits of the number.

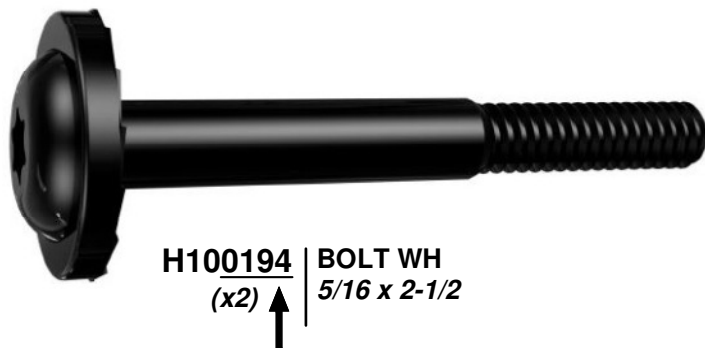

PRE-ASSEMBLY STEP 2 - TOOLS REQUIRED



**Cordless Drill or
Electric Drill**



**Drill Attachments:
Phillips Head**



**1/8", 3/16", 3/8" & 7/16"
Drill Bits**



Phillips Screw Driver



Open End Wrenches 1/2" & 9/16"



**3/8" Drive Ratchet, 1/2" &
9/16" STD Sockets 1/2" & 9/16" Deep
Sockets**



Claw Hammer



Rubber Mallet - Optional



Tape Measure

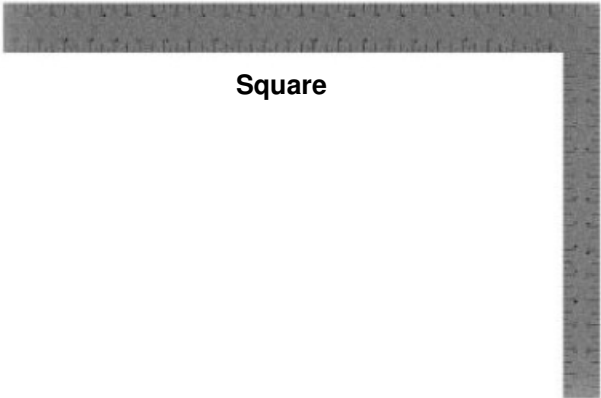

Square





Level 24"

PRE-ASSEMBLY STEP 3 - CHOOSE YOUR ASSEMBLY METHOD



There are several types of assembly instructions available to you.

1. **Printed Assembly Manual** included with your set
2. **BILT APP** - 3D interactive instructions
3. **Combination of the Printed Manual and BILT APP** (Note: Step numbers can differ between the two methods)



Scan for easy 3D instructions

Download the BILT app before you begin



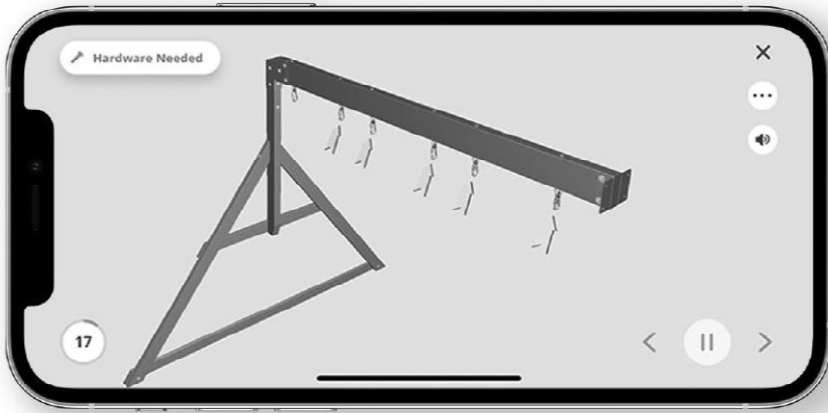



ASSEMBLY

STEP 1



A1 | SWING BEAM - W4L15377
(1) | 3 1/4"x5 1/4"x83" (81x134x2108)

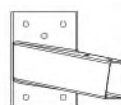

A4M01299 | Y-Bracket (Left)
(2)

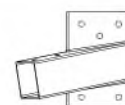

A4M01300 | Y-Bracket (Right)
(2)

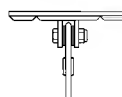

A4M00505 | SWING HANGER
(4)



A100164 | BYD ID TAG (LARGE) AGES 3-10
(1)



H100056 | BOLT HEX
(8) | 3/8x5 3/4



H100014 | BOLT WH
(10) | 5/16x2 1/2



H100006 | NUT BARREL WH
(10) | 5/16x1 1/2



H100073 | T-NUT
(8) | 3/8



H100128 | SCREW PWH
(4) | 8x5/8



H100107 | WASHER LOCK INT
(8) | 10x18



H100102 | WASHER FLAT
(8) | 11x25

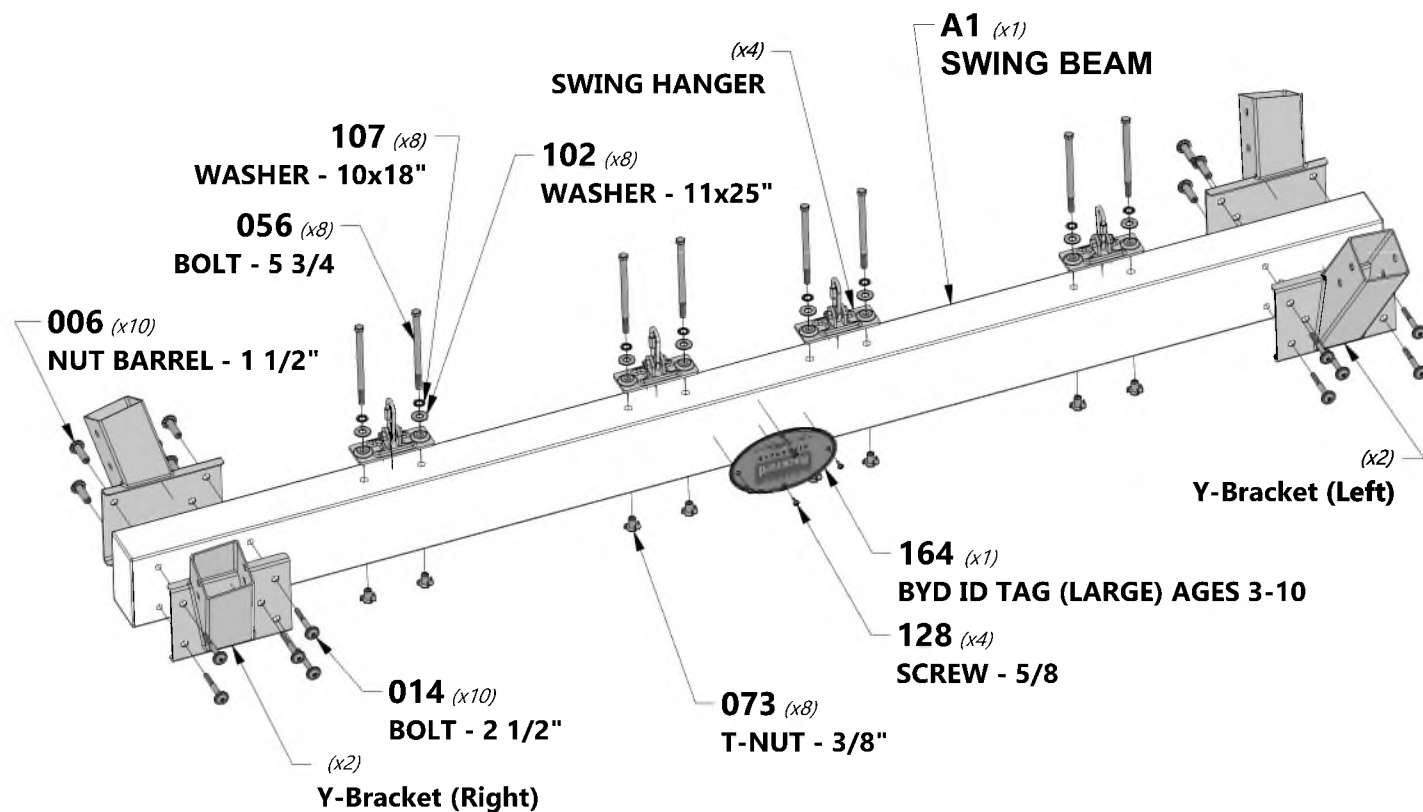

NOTE:
INSTALL BYD ID TAG IN THE
CENTER OF SWING BEAM.



ASSEMBLY

STEP 2

B1 | POST - W4L15376
(3) | 2 7/8"x2 7/8"x90 3/4" (72x72x2305)

B2 | POST - W2A03240
(1) | 2 7/8"x2 7/8"x90 3/4" (72x72x2305)

H100012 | BOLT WH
(8) | 5/16x2



H100006 | NUT BARREL WH
(8) | 5/16x1 1/2



NOTE:
COMPLETE THIS STEP 4 TIMES

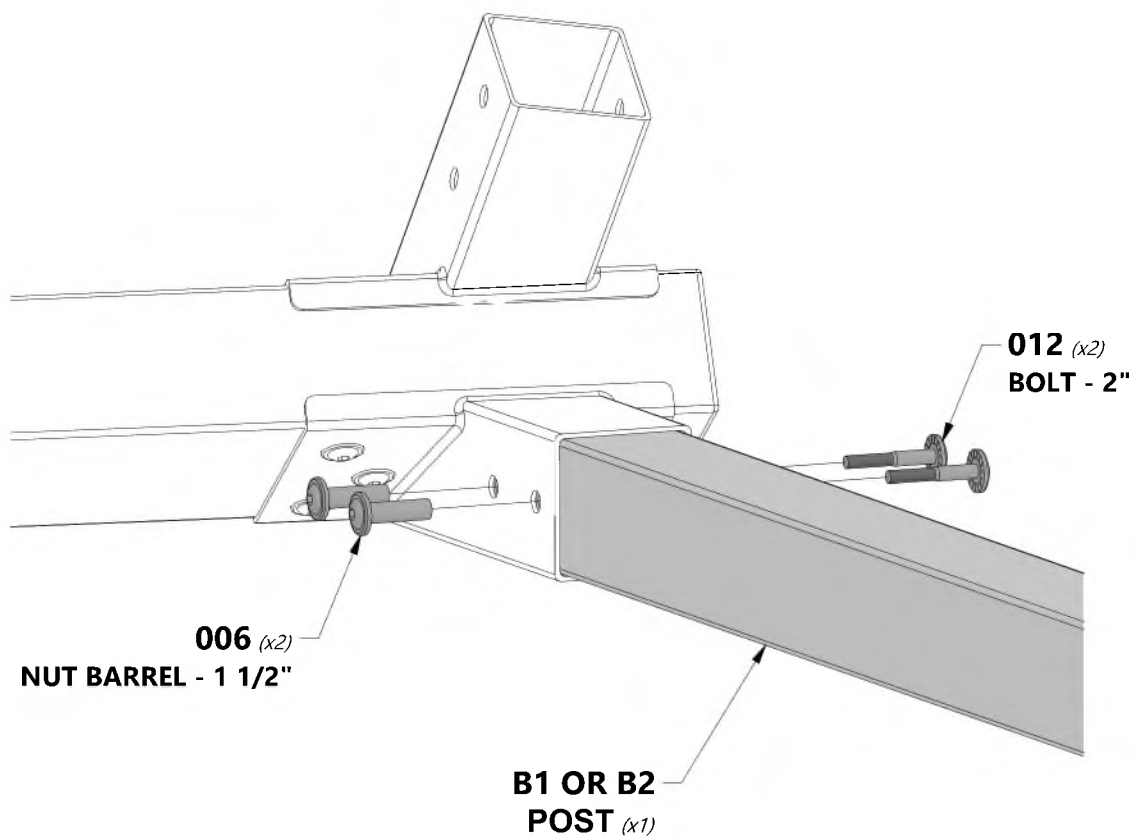

TIP:
FOR EASE OF ASSEMBLY INSTALL
POSTS IN BOTTOM BRACKETS FIRST.





ASSEMBLY

STEP 3



E1 | BRACE - W4L15378
(2) | 1 3/8"x3 3/8"x68" (34x86x1727)



H100166 | BOLT WH
(4) | 5/16x4-1/4



H100030 | WASHER LOCK
(4) | EXT
8x19



H100074 | T-NUT
(4) | 5/16



NOTE:
COMPLETE THIS STEP 2 TIMES

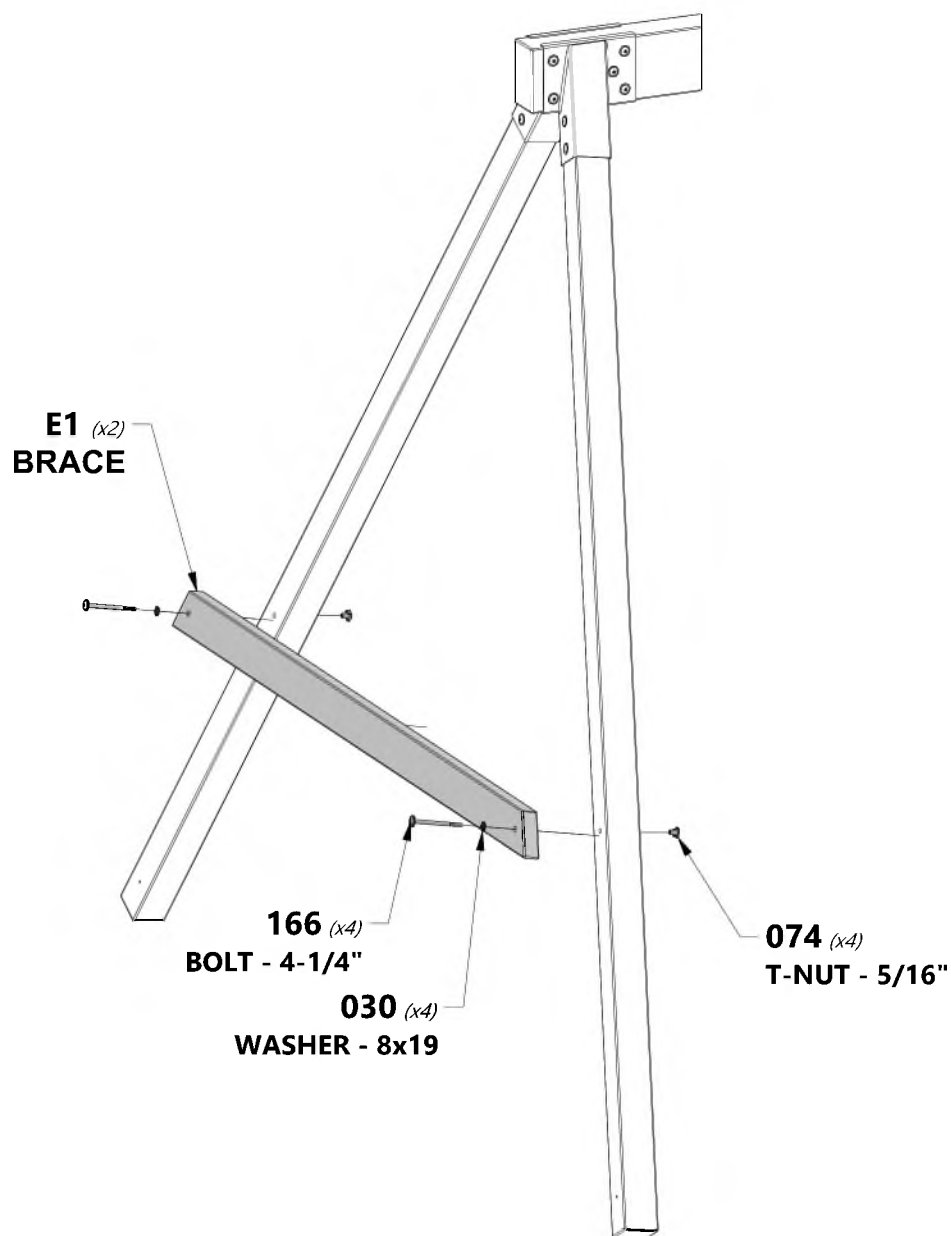



ASSEMBLY

STEP 4



A100087
(4) **ROPE-CHAIN GREEN 51.25"**

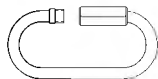

A100069
(4) **QUICK LINK**



A6P00054
(2) **SWING SEAT GREEN 22"**



NOTE:

WHEN HANGING YOUR SWINGS, IT IS REQUIRED TO ONLY TRIM AROUND THE SPECIFIC CHAIN LOOP THAT ALLOWS THE BOTTOM OF THE SWING SEAT, (WHEN SITTING ON IT) TO BE NO LOWER THAN (35CM) 13 7/8 INCHES FROM THE GROUND.

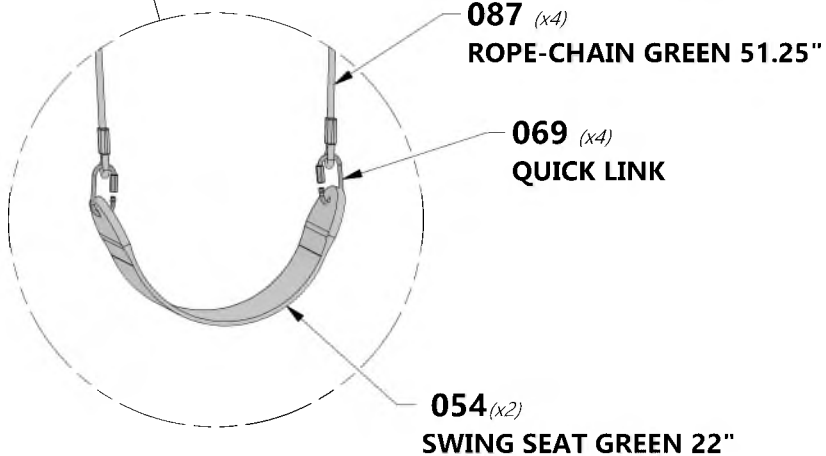
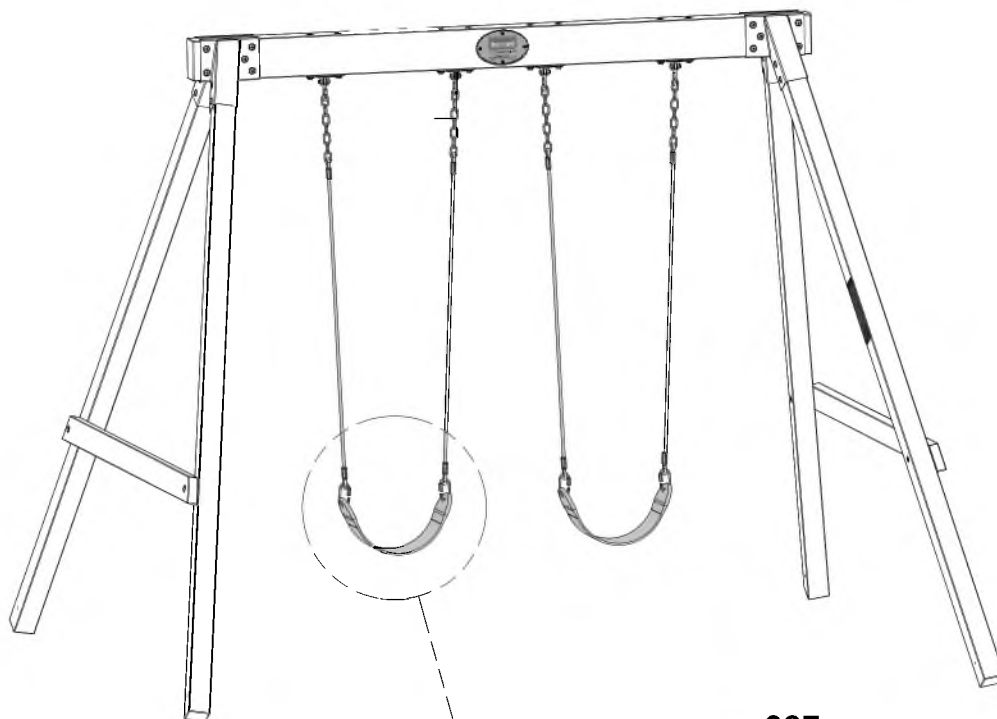
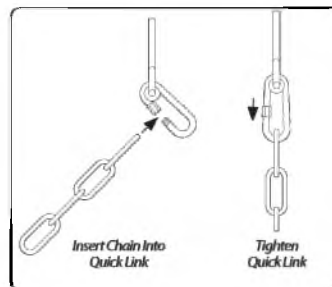



ASSEMBLY

STEP 5



A100178
(4) | **AUGER GROUND STAKE**



A100314
(1) | **"A" REVISION TAG**



H100028
(4) | **LAG SCREW WH**
5/16x2 1/2



H100128
(2) | **SCREW PWH**
8x5/8

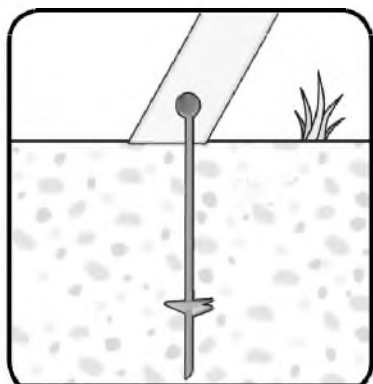

Screw auger into ground at a 90° angle in the indicated locations.



NOTE:
FAILURE TO USE GROUND
STAKES CAN VOID WARRANTY
& CAUSE INJURY!

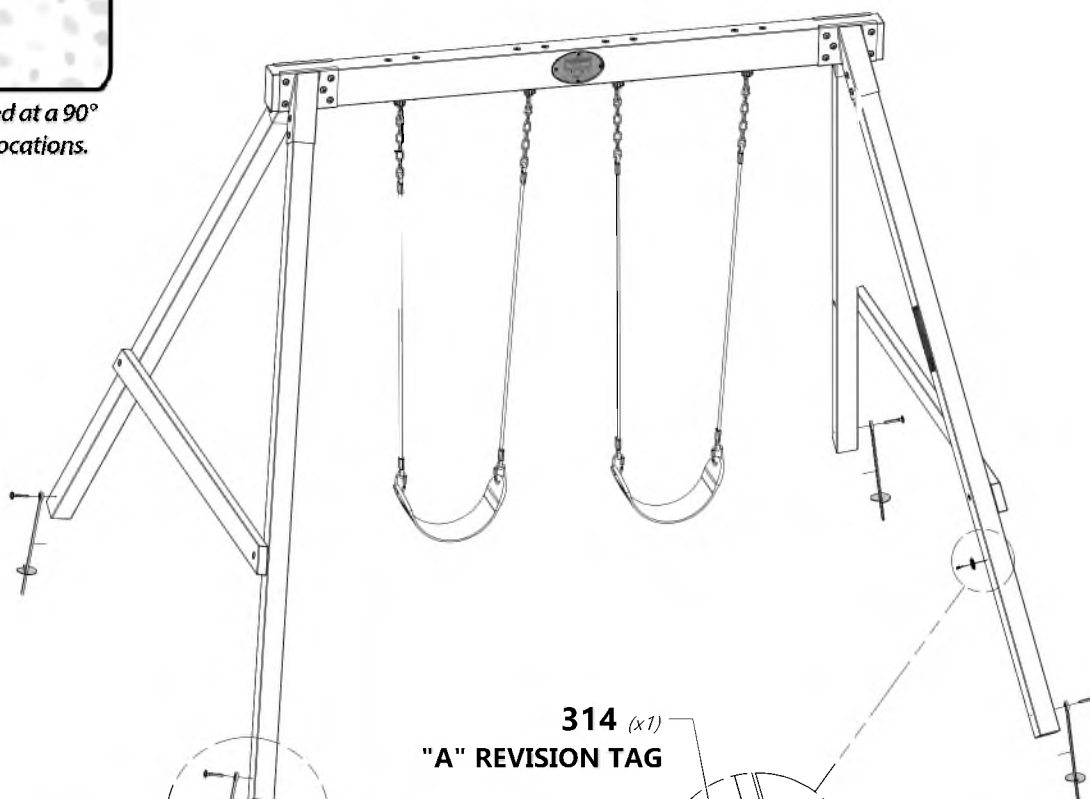

028 (x4)
LAG SCREW - 2 1/2"

314 (x1)
"A" REVISION TAG

128 (x2)
SCREW - 5/8

LOCATE APPROXIMATELY 2FT (910mm)
FROM BOTTOM OF POST

178 (x4)
AUGER GROUND STAKE