



MANUFACTURED BY:
Backyard Discovery
3305 Airport Drive, Pittsburg, KS 66762
800-856-4445

Basepoint Business Centre: Rivermead Drive, Westlea, Swindon SN5 7EX Phone: 0800-118-2476
J.P. Coenstraat 7, The Bridge, The Hague, 2595 WP, Netherlands Phone: 0800-567-8990

TUBE SLIDE

LEFT EXIT SLIDE

Model # 9198012B

The assembly manual must be retained
since it contains important information



WARNING

Adult Assembly Required.

Not suitable for children under 36 months due to small parts.

FOR DOMESTIC USE ONLY. INTENDED FOR OUTDOOR USE.



Please visit www.backyarddiscovery.com

For the most up to date assembly manual, to register your set, or to order replacement parts

Para obtener instrucciones en español, visite www.backyarddiscovery.com



**EASY STEP-BY-STEP
3D INTERACTIVE INSTRUCTIONS**

DOWNLOAD THE FREE APP



Made in China

INS-9198012B-A-TUBE SLIDE LH EXIT-ENG 04-10-24

Owner's Manual - Basic Setup Dimensions & Assembly Notes

Place the set on level ground, not less than 6'-7" [2 m] from any structure or obstruction such as a fence, garage, house, overhanging branches, laundry lines, or electrical wires.

- While assembling unit, take time before and after each phase to make sure fort is level. If fort is not level, assembly will be difficult and improper assembly may result. Extra care must be taken to insure the fort is square.
 - The safe play area refers to a zone extending 6'-7" (2 m) beyond the play product on all sides, including the space above the play product.
-

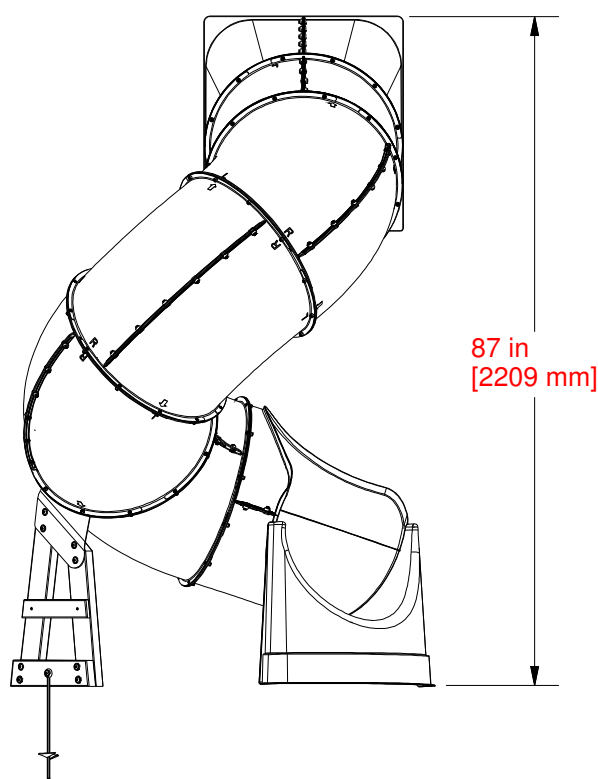
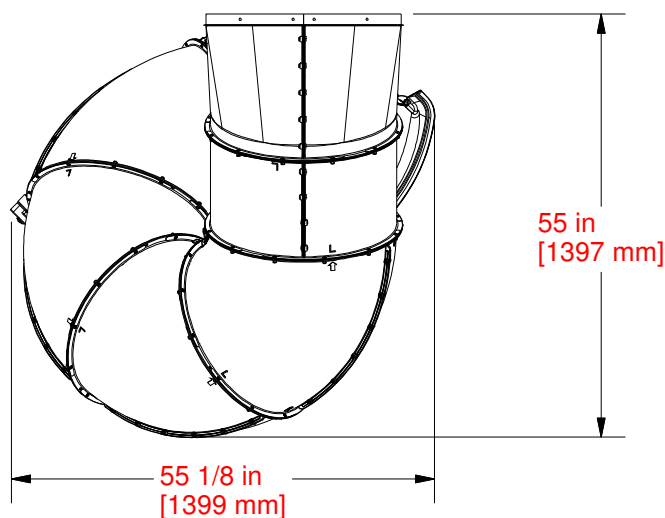

Owner's Manual - Parts Identification

Wood Components (Not to Scale)



E85 | UPRIGHT - W4L12970
(x1) | 1 3/8"x3 3/8"x19 7/8" (36x86x505)



E86 | UPRIGHT - W4L12971
(x1) | 1 3/8"x3 3/8"x24 1/2" (36x86x623)



E87 | GROUND BOARD - W4L17063
(x1) | 1 3/8"x3 3/8"x14 3/8" (36x86x366)



N87 | SAFETY BOARD - W4L13334
(x1) | 5/8"x2 3/8"x12" (16x60x306)

Owner's Manual - Parts Identification

Hardware Components

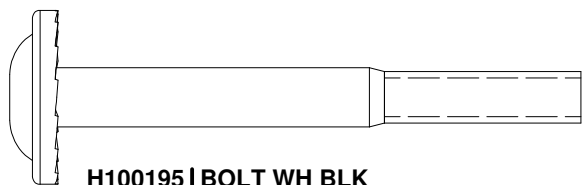

H100195 | BOLT WH BLK
(x4) | 5/16x2-3/4

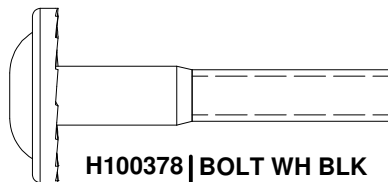

H100378 | BOLT WH BLK
(x1) | 5/16x1 3/4

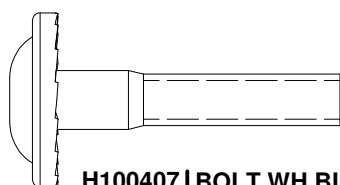

H100407 | BOLT WH BLK
(x4) | 5/16x1 1/2

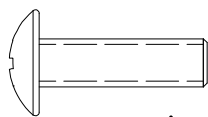

H100795 | BOLT PTH WZ
(x2) | 1/4x7/8

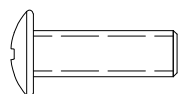

H100769 | BOLT PTH WZ
(x133) | 1/4x3/4

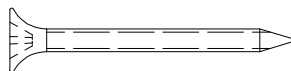

H100200 | SCREW PFH BLK
(x2) | 8x1 1/2

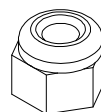

H100148 | NUT LOCK WZ
(x135) | 1/4

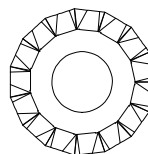

H100198 | WASHER LOCK EXT BLK
(x4) | 8x19

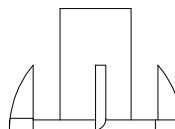

H100379 | T-NUT BLK
(x9) | 5/16

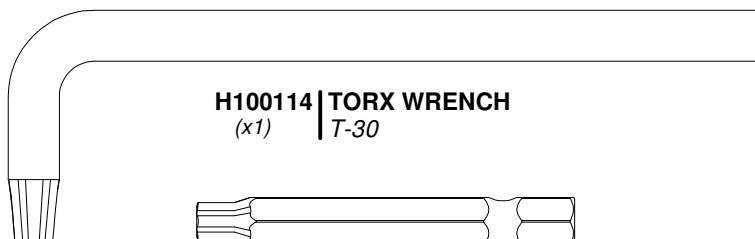

H100114 | TORX WRENCH
(x1) | T-30

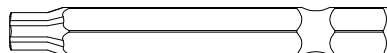

H100147 | TORX BIT
(x1) | T-30

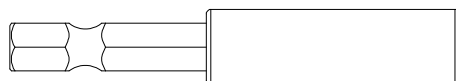

H101100 | MAGNETIC DRIVER
(x1)

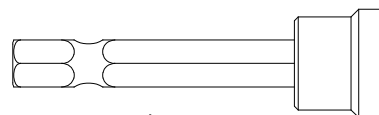

H100764 | SCREW SETTER
(x1)

Owner's Manual - Parts Identification

Accessory Components (Not to Scale)

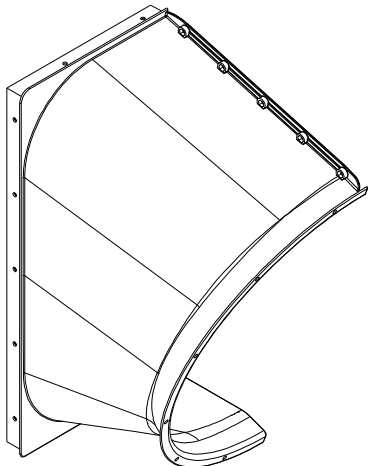

A6P00302-2
(x1) | **SLIDE ENTRANCE LEFT**

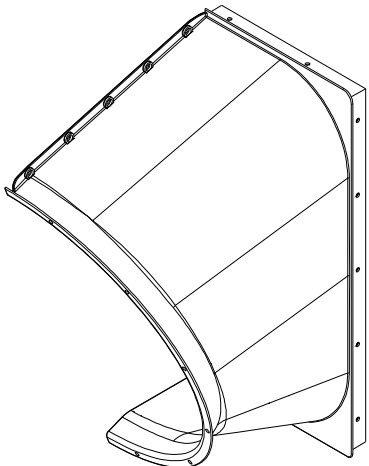

A6P00302-1
(x1) | **SLIDE ENTRANCE RIGHT**

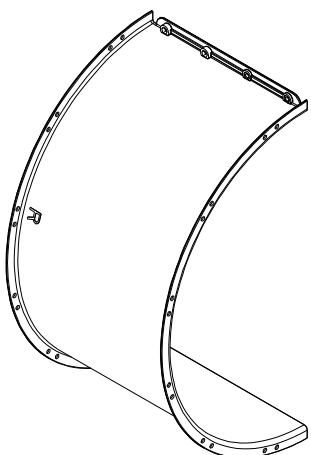

A6P00302-3
(x2) | **STRAIGHT TUBE**

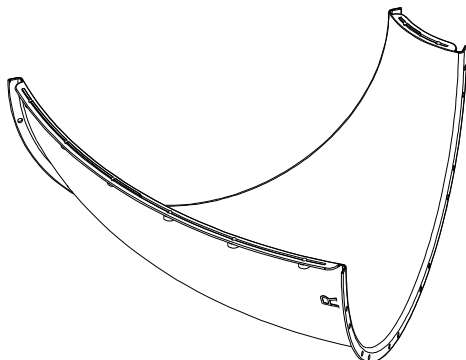

A6P00302-4
(x9) | **SLIDE ELBOW**

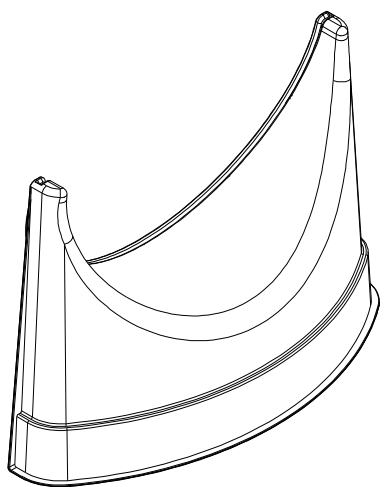

A6P00302-6L
(x1) | **EXIT SUPPORT**

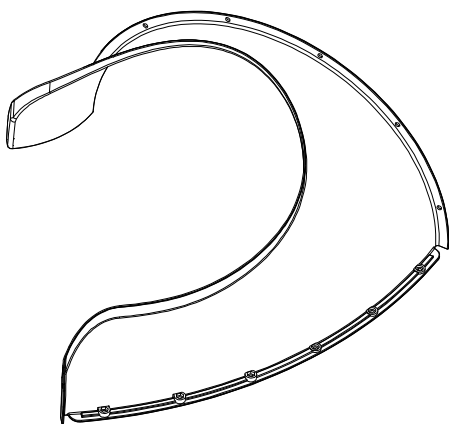

A6P00302-5L
(x1) | **EXIT TOP**

Owner's Manual - Parts Identification

Accessory Components (Not to Scale)



A100178
(x1) | **AUGER GROUND STAKE**

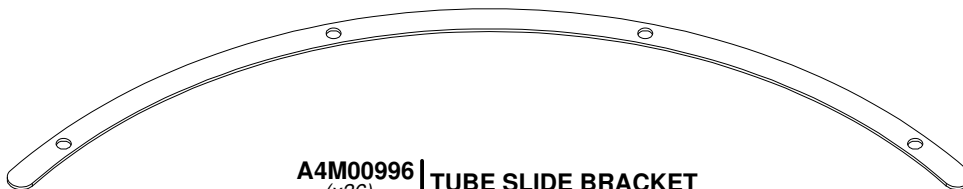

A4M00996
(x36) | **TUBE SLIDE BRACKET**

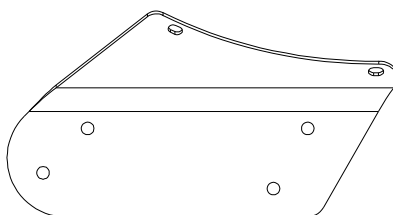

A4M01088
(x1) | **TUBE SLIDE BRACKET - LH**

PRE-ASSEMBLY STEP 1 - SORTING PARTS

It is critical for ease of assembly that you take the time to sort and organize the wood and hardware.

WOOD PARTS:

- Organize wood parts by the three-digit, alpha-numeric number stamped on each board (ex. P01).
- If there are multiple boards with the same stamped number, stack those pieces together.
- Stamps can be found on the flat surface of the boards or on the end of the boards.
- Allow yourself plenty of room - the wood pieces can take up a significant amount of space.

NOTE: CARTONS ARE NOT ORGANIZED BY BOARD NUMBER.

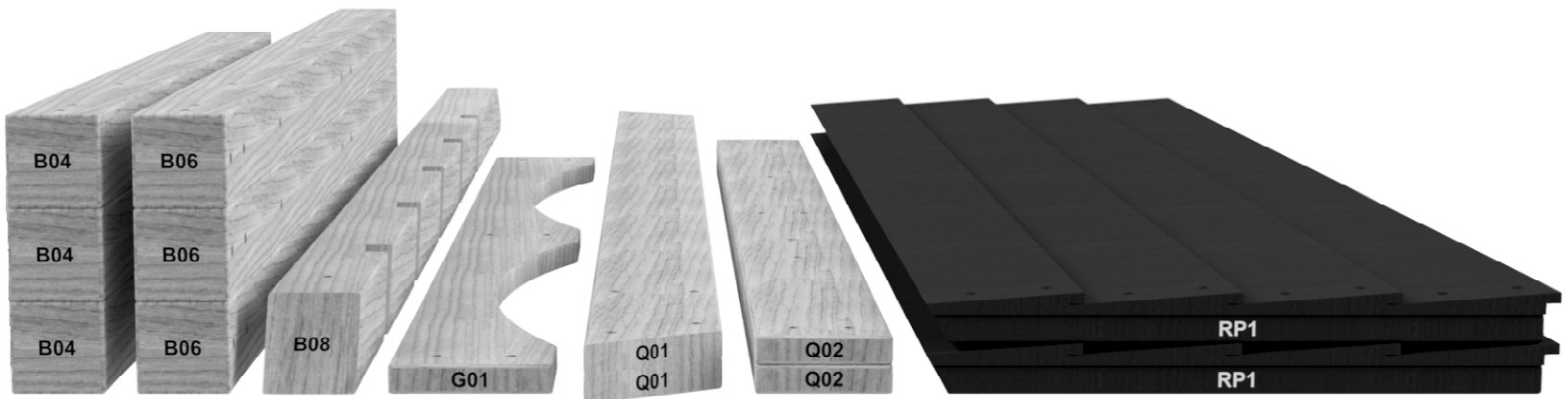

HARDWARE PARTS:

- We recommend that you have a separate table to organize the hardware.
- Hardware bags are printed with a seven-digit, alpha-numeric part number.
- You can organize your hardware by part number or group by hardware type (i.e. bolts, nuts, etc.).
- During assembly you only need to reference the last four digits of the number.

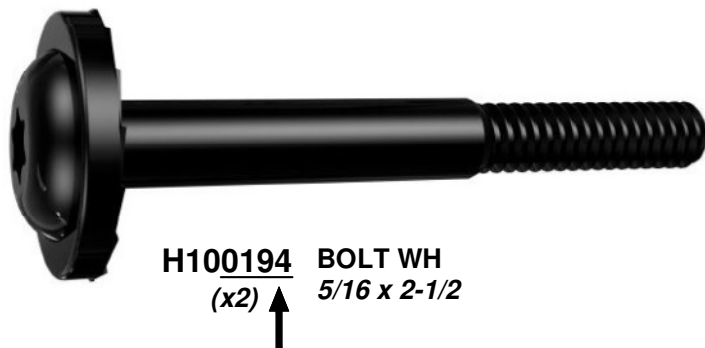

PRE-ASSEMBLY STEP 2 - TOOLS REQUIRED



Cordless Drill or
Electric Drill



Drill Attachments:
Phillips Head



1/8", 3/16", 3/8" & 7/16"
Drill Bits



Phillips Screw Driver



Open End Wrenches 1/2" & 9/16"



3/8" Drive Ratchet, 1/2" &
9/16" STD Sockets 1/2" & 9/16"
Deep Sockets



Claw Hammer



Rubber Mallet - Optional



Tape Measure

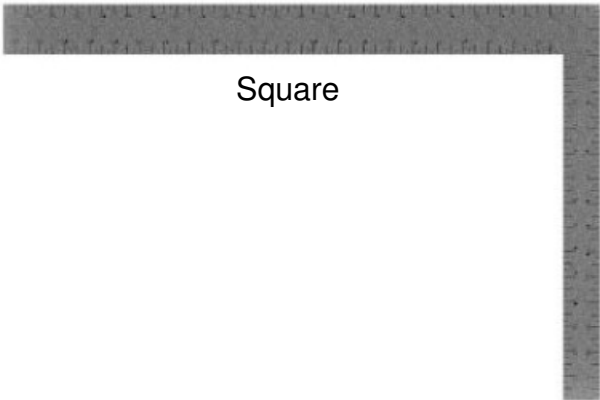

Square





Level 24"

PRE-ASSEMBLY STEP 3 - CHOOSE YOUR ASSEMBLY METHOD



There are several types of assembly instructions available to you.

1. Printed Assembly Manual included with your set
2. BILT APP - 3D interactive instructions
3. Combination of the Printed Manual and BILT APP (Note: Step numbers can differ between the two methods)



Scan for easy 3D instructions

Download the BILT app
before you begin



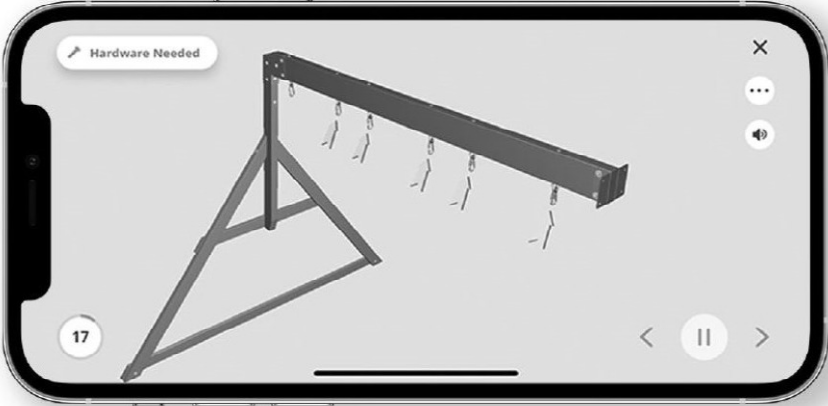

STEP 1 - SLIDE ASSEMBLY

QTY	PART NUMBER	DESCRIPTION
8	H100148	NUT LOCK 1/4
8	H100769	BOLT PTH 1/4x3/4

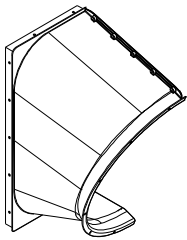

A6P00302-2
(x1) | SLIDE ENTRANCE LEFT

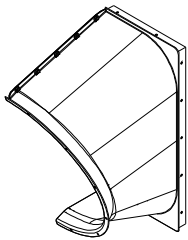

A6P00302-1
(x1) | SLIDE ENTRANCE RIGHT

TIP:
LAYING THE PARTS ON THEIR FLAT END
MAKES ASSEMBLY EASIER.

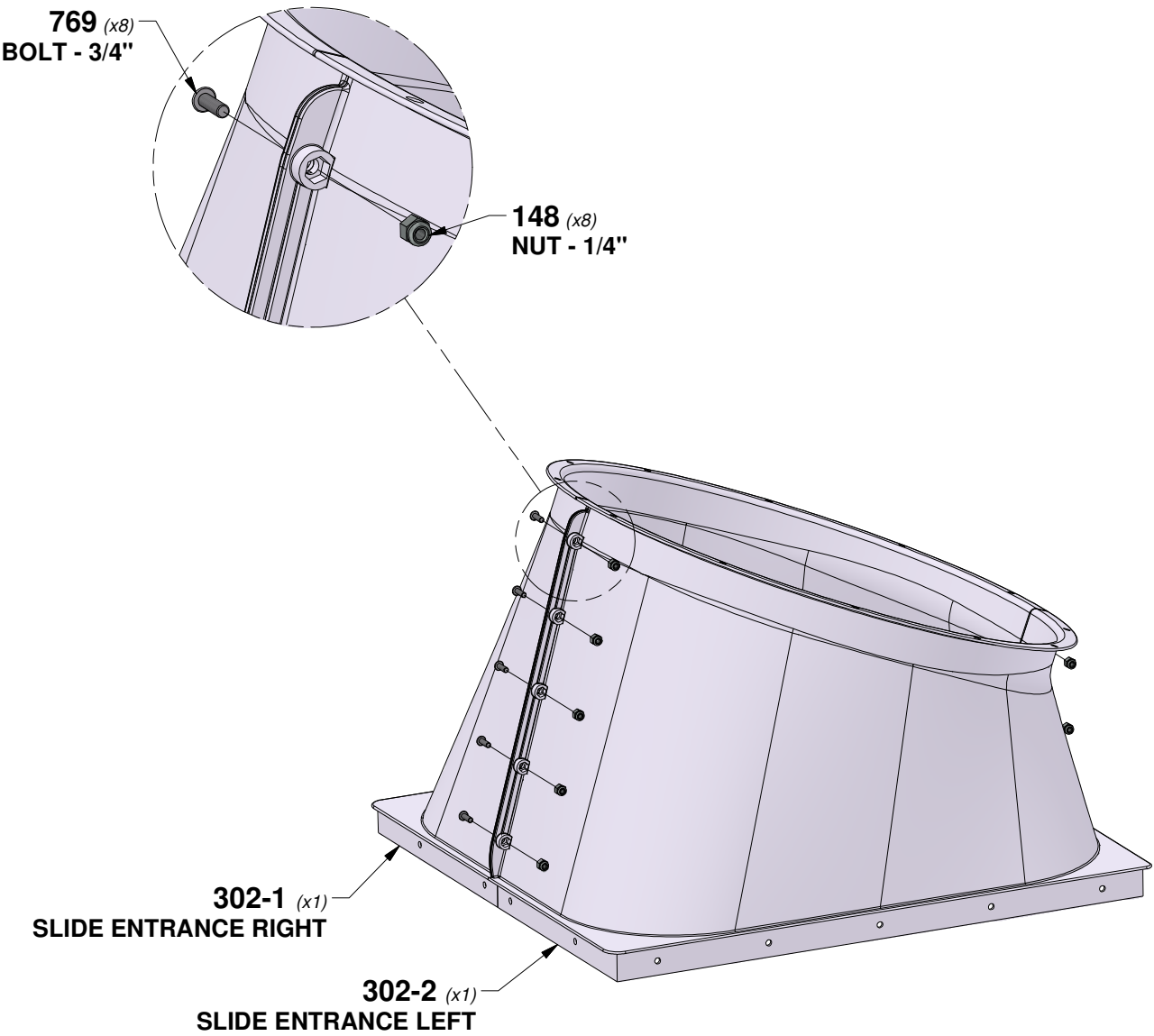

STEP 2 - SLIDE ASSEMBLY

QTY	PART NUMBER	DESCRIPTION
8	H100148	NUT LOCK 1/4
8	H100769	BOLT PTH 1/4x3/4

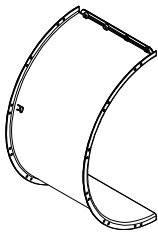

A6P00302-3
(x2) STRAIGHT TUBE

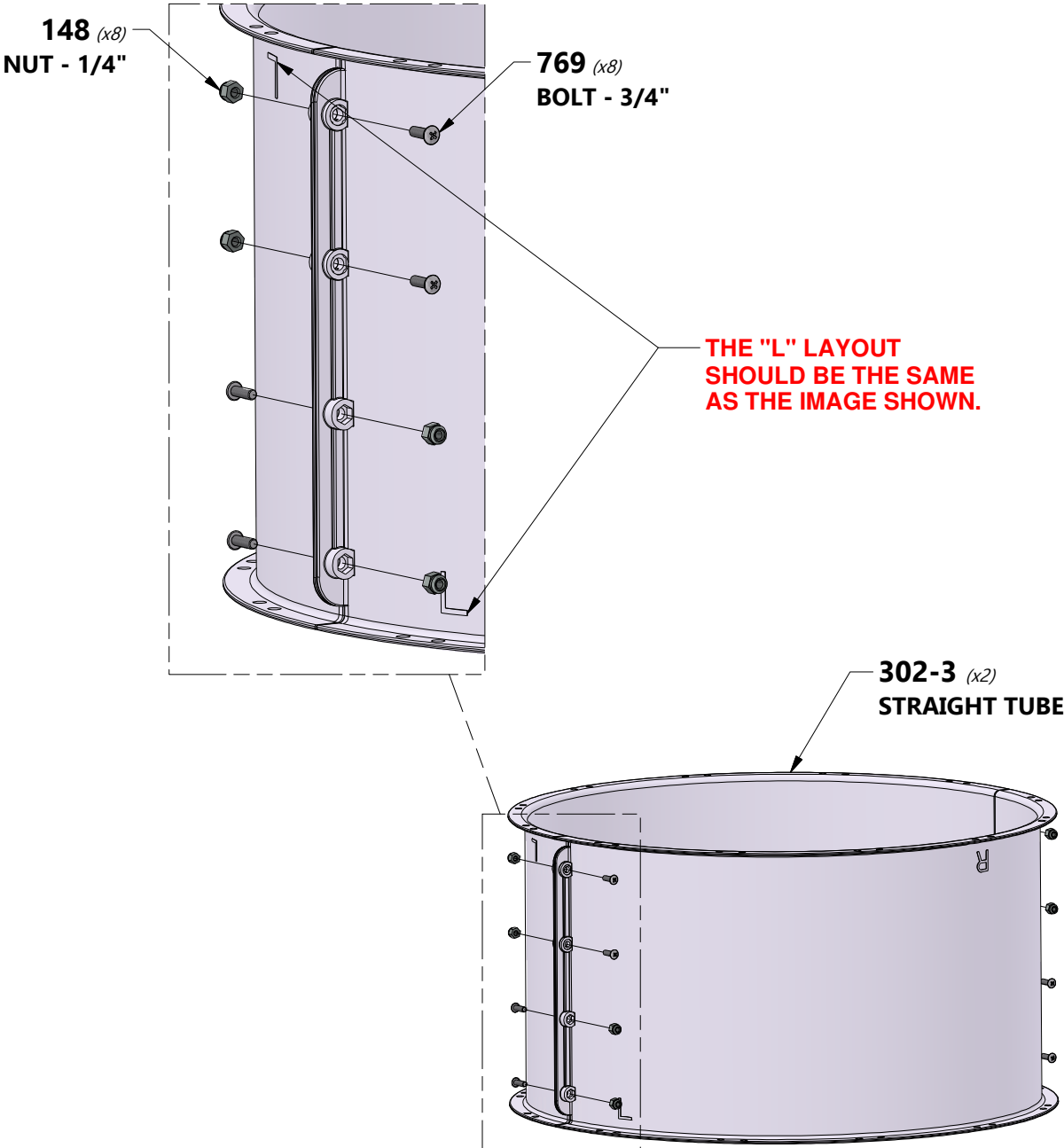

STEP 3 - SLIDE ASSEMBLY

QTY	PART NUMBER	DESCRIPTION
32	H100148	NUT LOCK 1/4
32	H100769	BOLT PTH 1/4x3/4

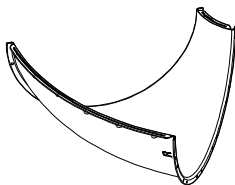

A6P00302-4
(x8) **SLIDE ELBOW**

NOTE:
REPEAT THIS STEP (3) MORE TIMES.

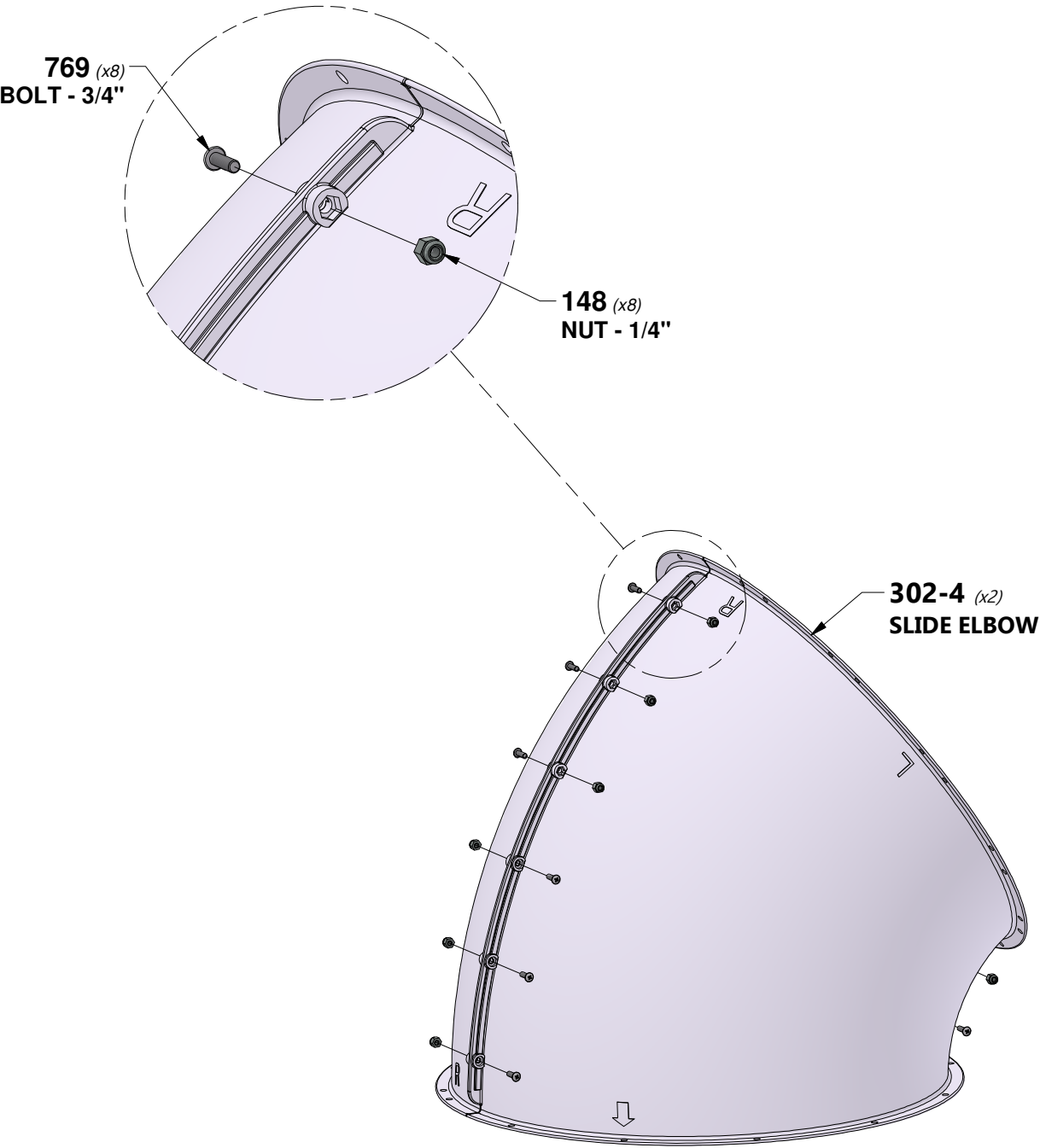

STEP 4 - SLIDE ASSEMBLY

QTY	PART NUMBER	DESCRIPTION
8	H100148	NUT LOCK 1/4
8	H100769	BOLT PTH 1/4x3/4

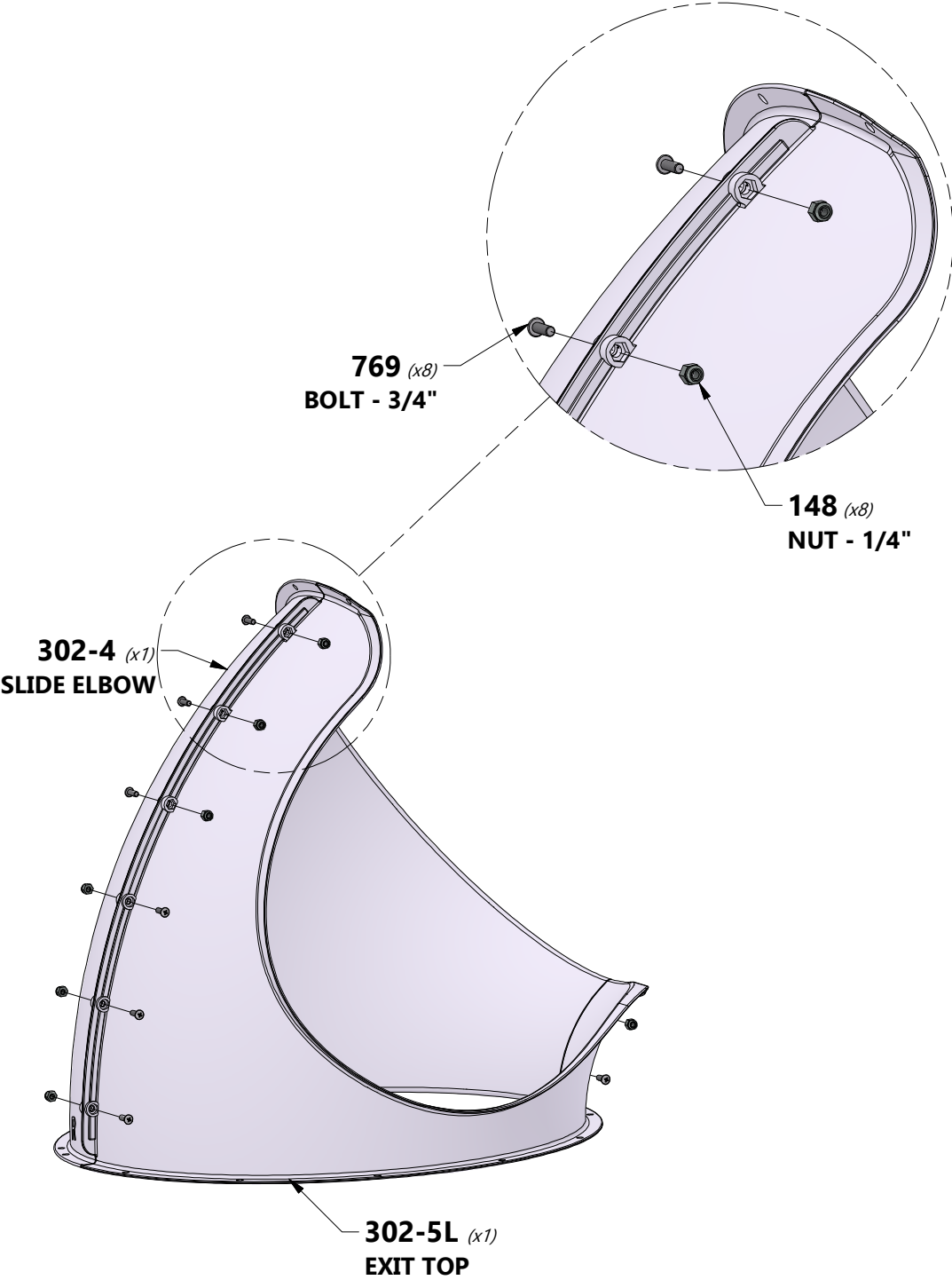
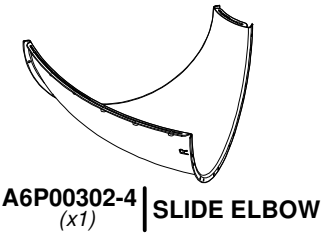

STEP 5 - SLIDE ASSEMBLY

QTY	PART NUMBER	DESCRIPTION
5	H100148	NUT LOCK 1/4
7	H100769	BOLT PTH 1/4x3/4

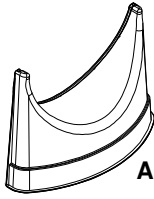

A6P00302-6L
(x1) EXIT SUPPORT

- **RECOMMENDED BOLT ASSEMBLY ORDER, FROM TOP LEFT AS YOU ALIGN HOLES.**
- **MAKE SURE THE EXIT SUPPORT IS ALIGNED WITH THE SLIDE ELBOW AS SHOWN BELOW.**
- **USE A SCREW DRIVER TO ALIGN HOLES.**
- **WHEN REMOVING SPACER, BEGIN ALIGNMENT OF TUBE SLIDE OPENING FOR EASIER ASSEMBLY.**

FRONT VIEW

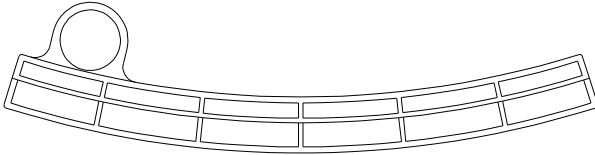
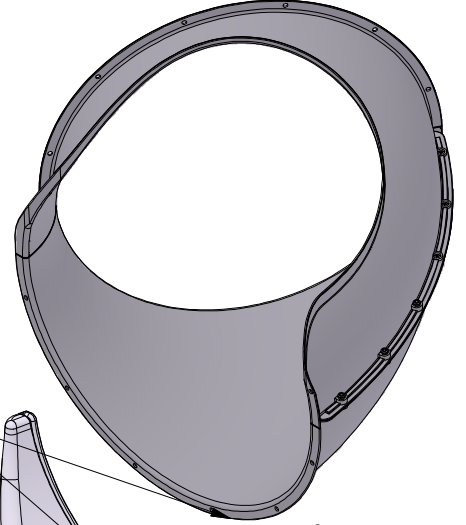

TUBE SLIDE SPACER

**SLIDE INTO GROOVE
ON EXIT SUPPORT.**

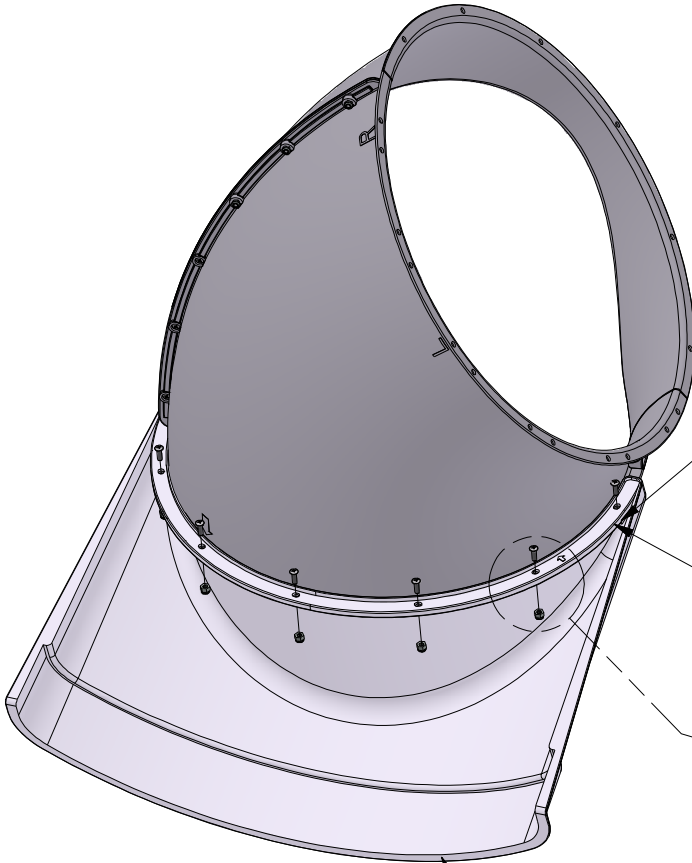
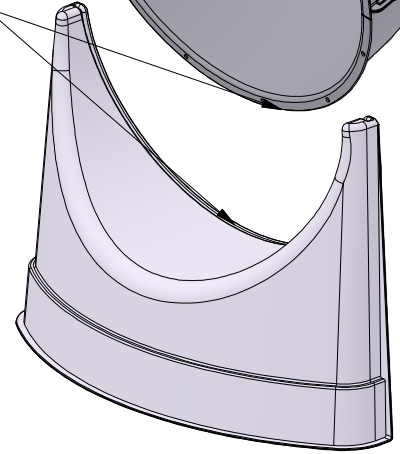

BACK VIEW

302-6L (x2)
EXIT SUPPORT

**FACTORY INSTALLED
NUT. (BOTH CORNERS)**

**START ALIGNMENT
OF HOLES FROM
THE TOP LEFT.**

769 (x7)
BOLT - 3/4"

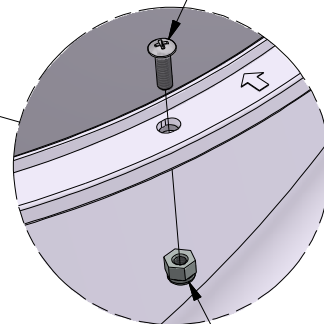

148 (x5)
NUT - 1/4"

REFERENCE

IMPORTANT: BRACKET CONFIGURATION ASSEMBLY & PLACEMENT.

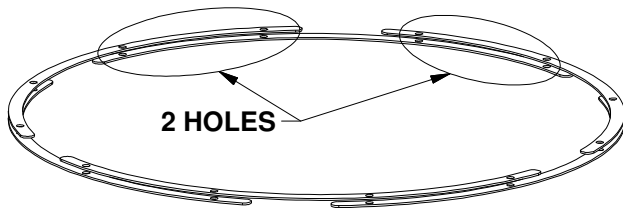

CONFIGURATION 'A' DIAGRAM

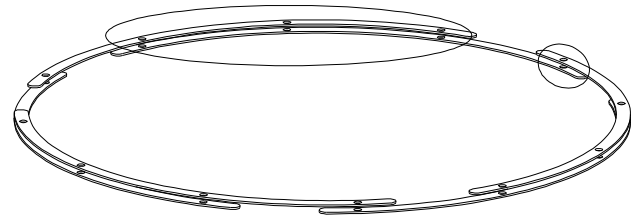

CONFIGURATION 'B' DIAGRAM

TIP:
PAY CLOSE ATTENTION TO THE ALIGNMENT MARKINGS ON EACH SLIDE SECTION. THE MARKINGS WILL AID YOU IN POSITIONING THE METAL SLIDE BRACKETS CORRECTLY.

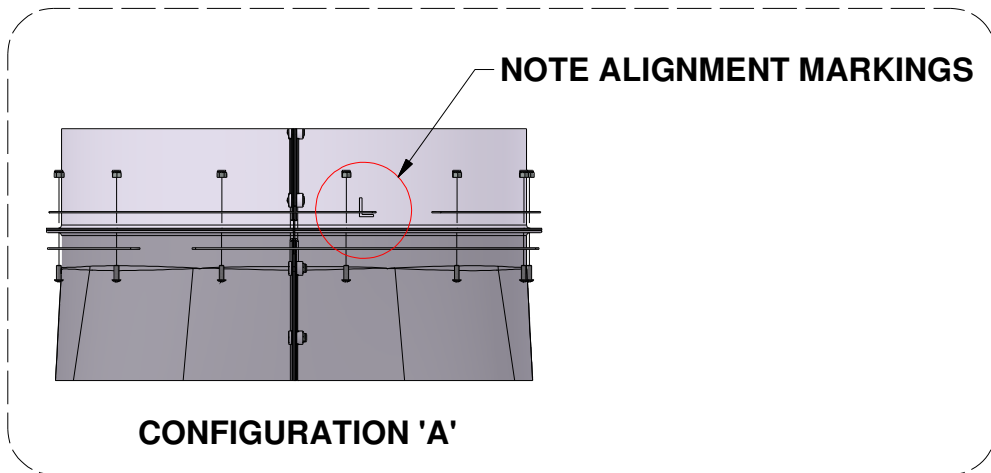

CONFIGURATION 'A'

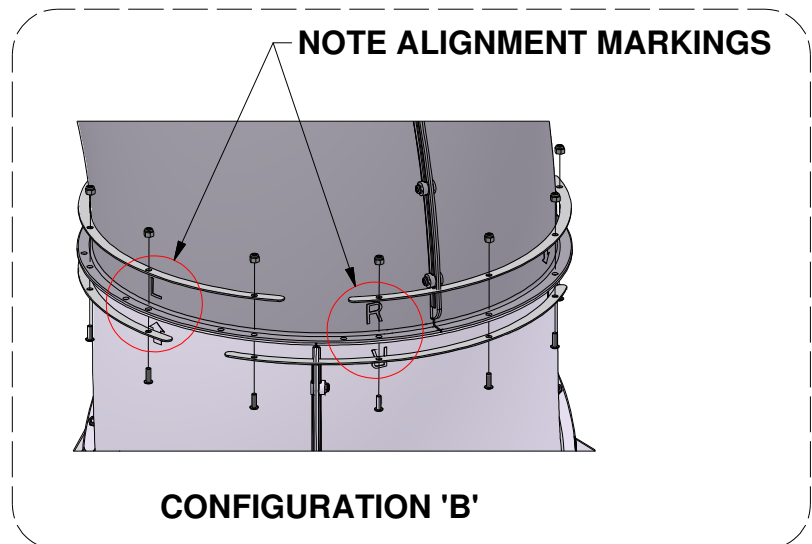

CONFIGURATION 'B'

STEP 6 - SLIDE ASSEMBLY

QTY	PART NUMBER	DESCRIPTION
12	H100148	NUT LOCK 1/4
12	H100769	BOLT PTH 1/4x3/4

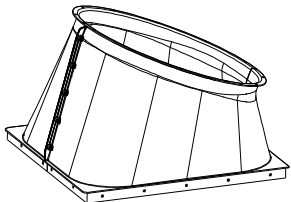

ENTRANCE ASSEMBLY

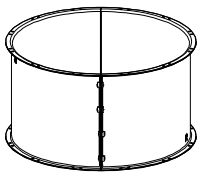

STRAIGHT TUBE ASSEMBLY

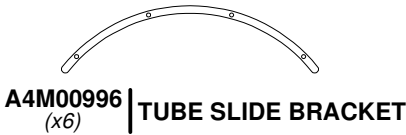

A4M00996 (x6) TUBE SLIDE BRACKET

TIP:
USE A SCREW DRIVER TO ALIGN HOLES.

**THIS SECTION ASSEMBLY USES
BRACKET CONFIGURATION 'A'
SHOWN ON REFERENCE PAGE.**

NOTE HOLE ORIENTATION

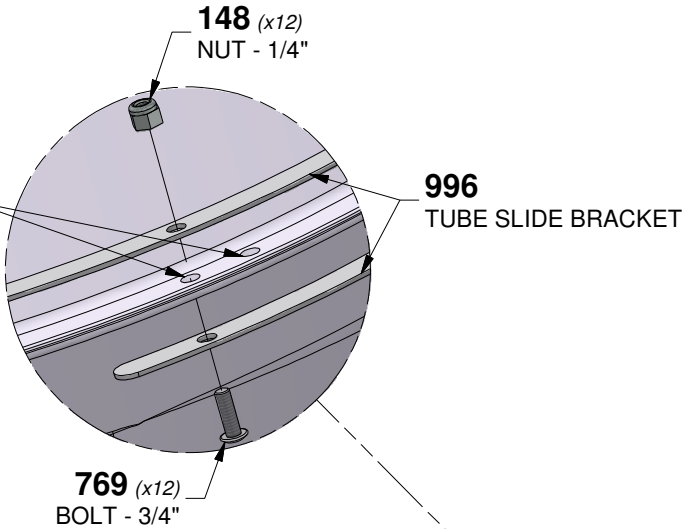

**NOTE THE "R" AND "L" MARKINGS TO AID
IN POSITIONING THE METAL BRACKETS**

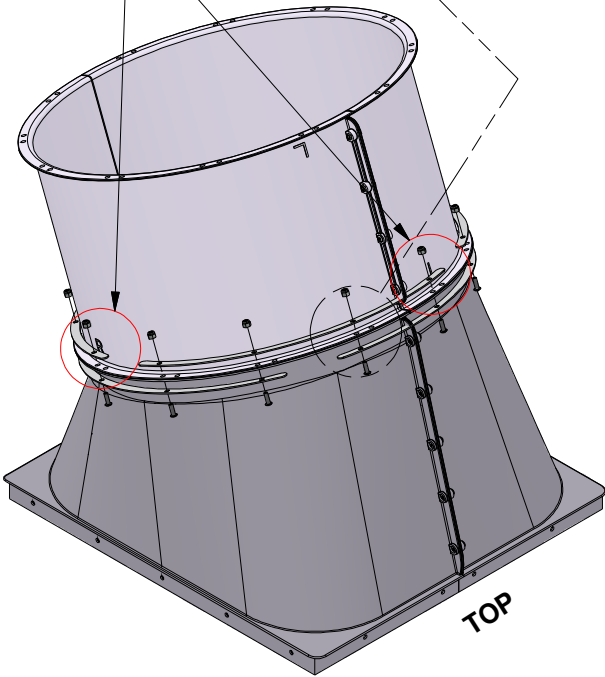
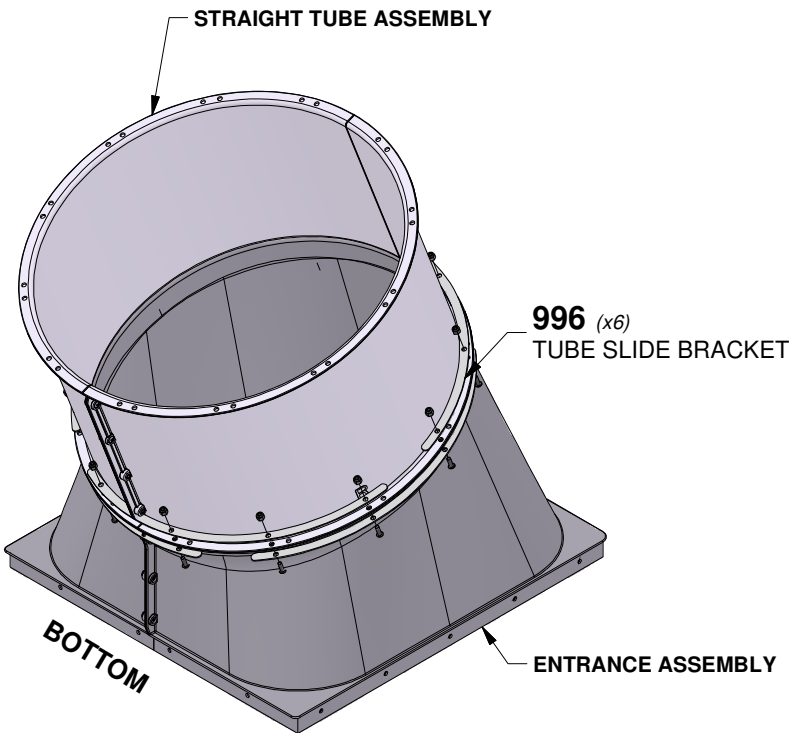

STEP 7 - SLIDE ASSEMBLY

QTY	PART NUMBER	DESCRIPTION
12	H100148	NUT LOCK 1/4"
12	H100769	BOLT PTH 1/4x3/4"

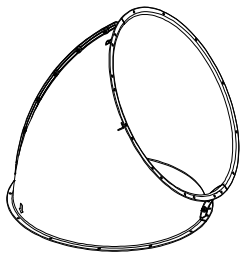

A4M00996 (x6) | TUBE SLIDE BRACKET

ELBOW TUBE ASSEMBLY

- ALIGN THE 'L' AND THE 'ARROW' TO ACHIEVE THE PROPER POSITION WHEN ASSEMBLING THE SLIDE.
- NOTE THIS SECTION ASSEMBLY USES CONFIGURATION 'A' SHOWN ON THE REFERENCE PAGE.

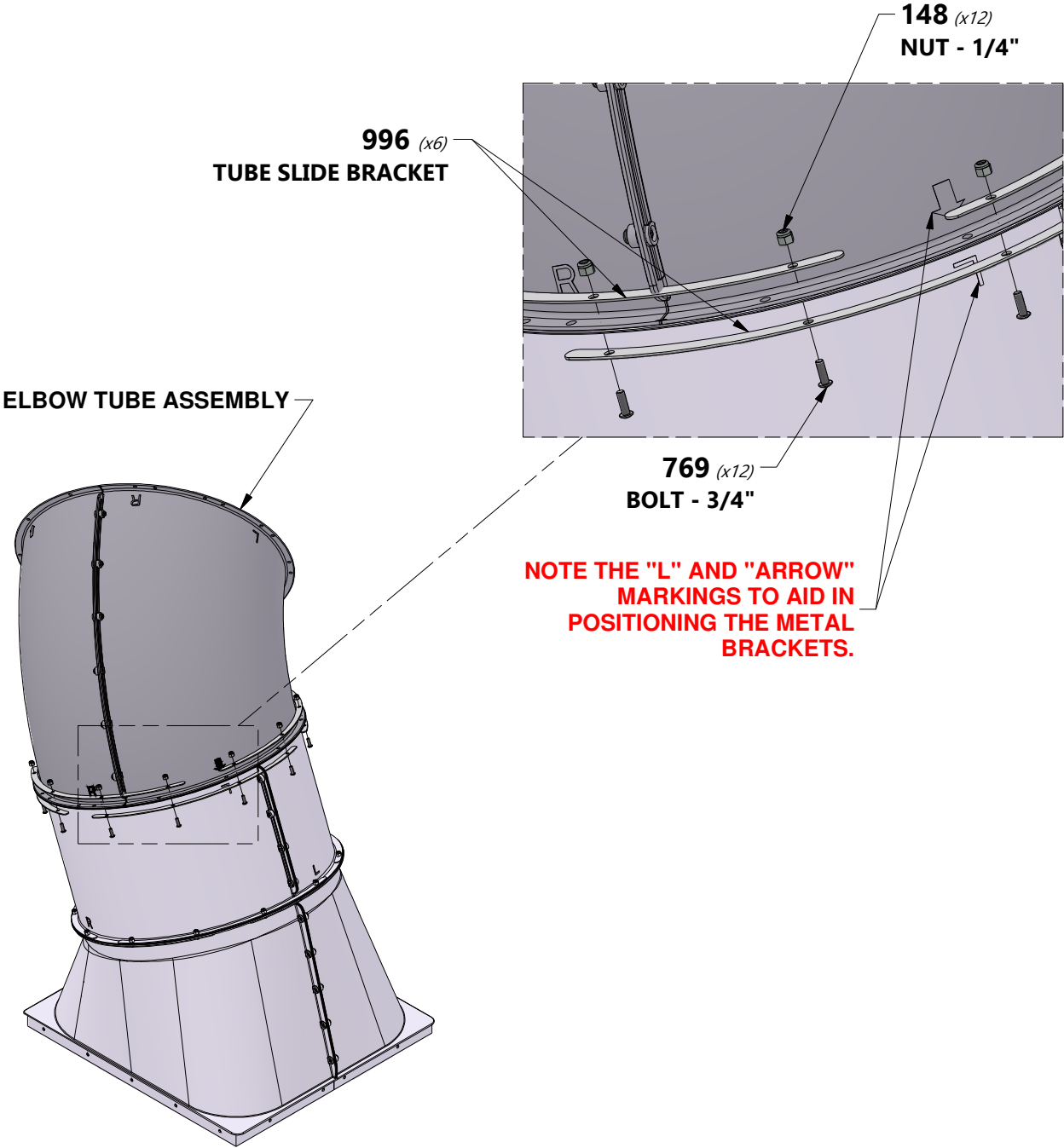

STEP 8 - SLIDE ASSEMBLY

QTY	PART NUMBER	DESCRIPTION
12	H100148	NUT LOCK 1/4
12	H100769	BOLT PTH 1/4x3/4



ELBOW TUBE ASSEMBLY

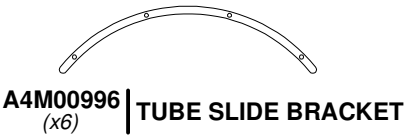

- **ALIGN THE 'L' AND THE 'ARROW' TO ACHIEVE THE PROPER POSITION WHEN ASSEMBLING THE SLIDE.**
- **NOTE THIS SECTION ASSEMBLY USES CONFIGURATION 'B' SHOWN IN THE REFERENCE PAGE.**

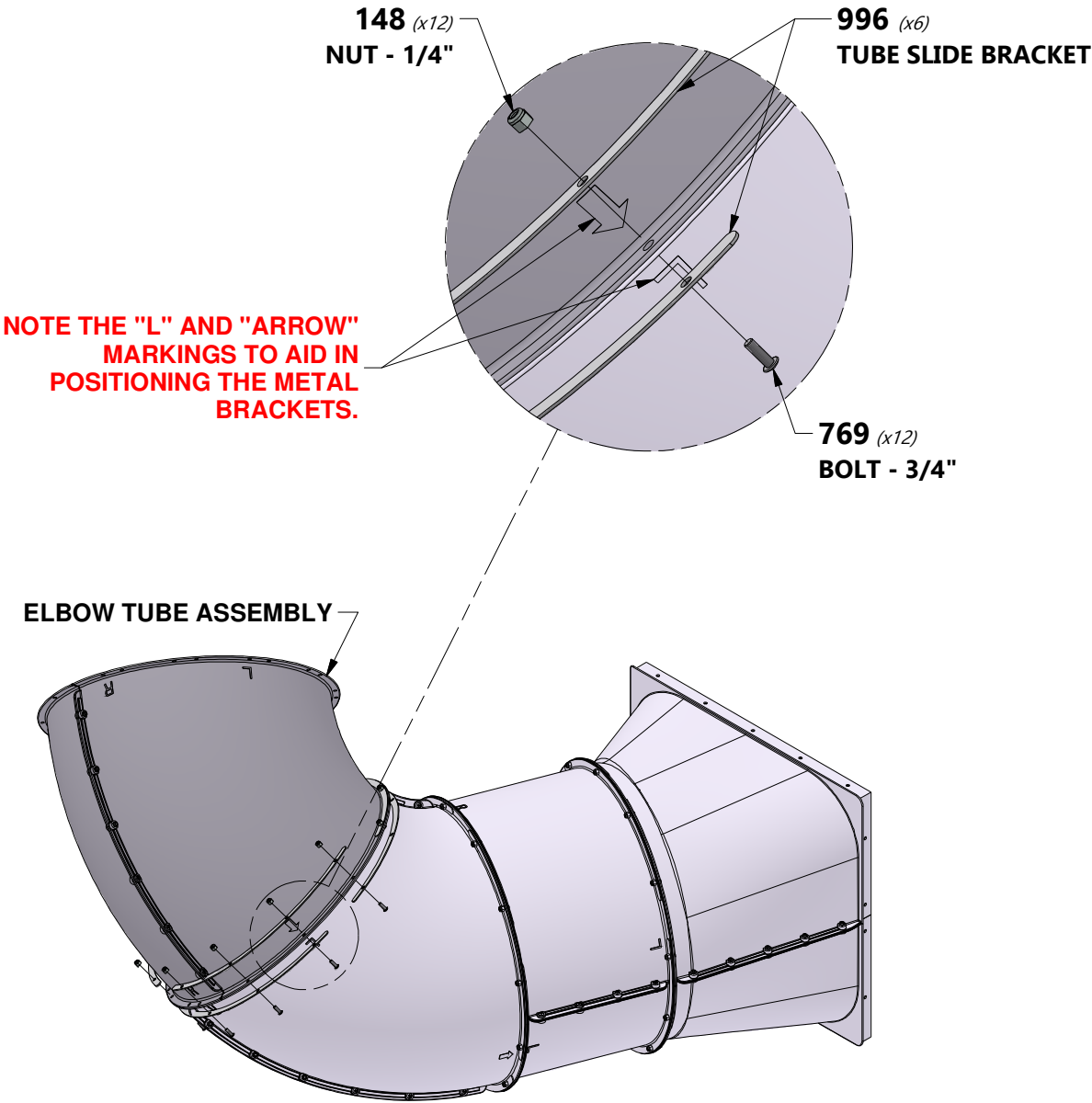

STEP 9 - SLIDE ASSEMBLY

QTY	PART NUMBER	DESCRIPTION
12	H100148	NUT LOCK 1/4
12	H100769	BOLT PTH 1/4x3/4



ELBOW TUBE ASSEMBLY

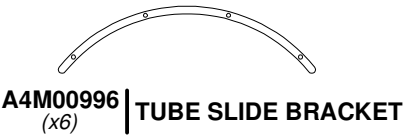

- **ALIGN THE 'L' AND THE 'ARROW' TO ACHIEVE THE PROPER POSITION WHEN ASSEMBLING THE SLIDE.**
- **NOTE THIS SECTION ASSEMBLY USES CONFIGURATION 'B' SHOWN IN THE REFERENCE PAGE.**

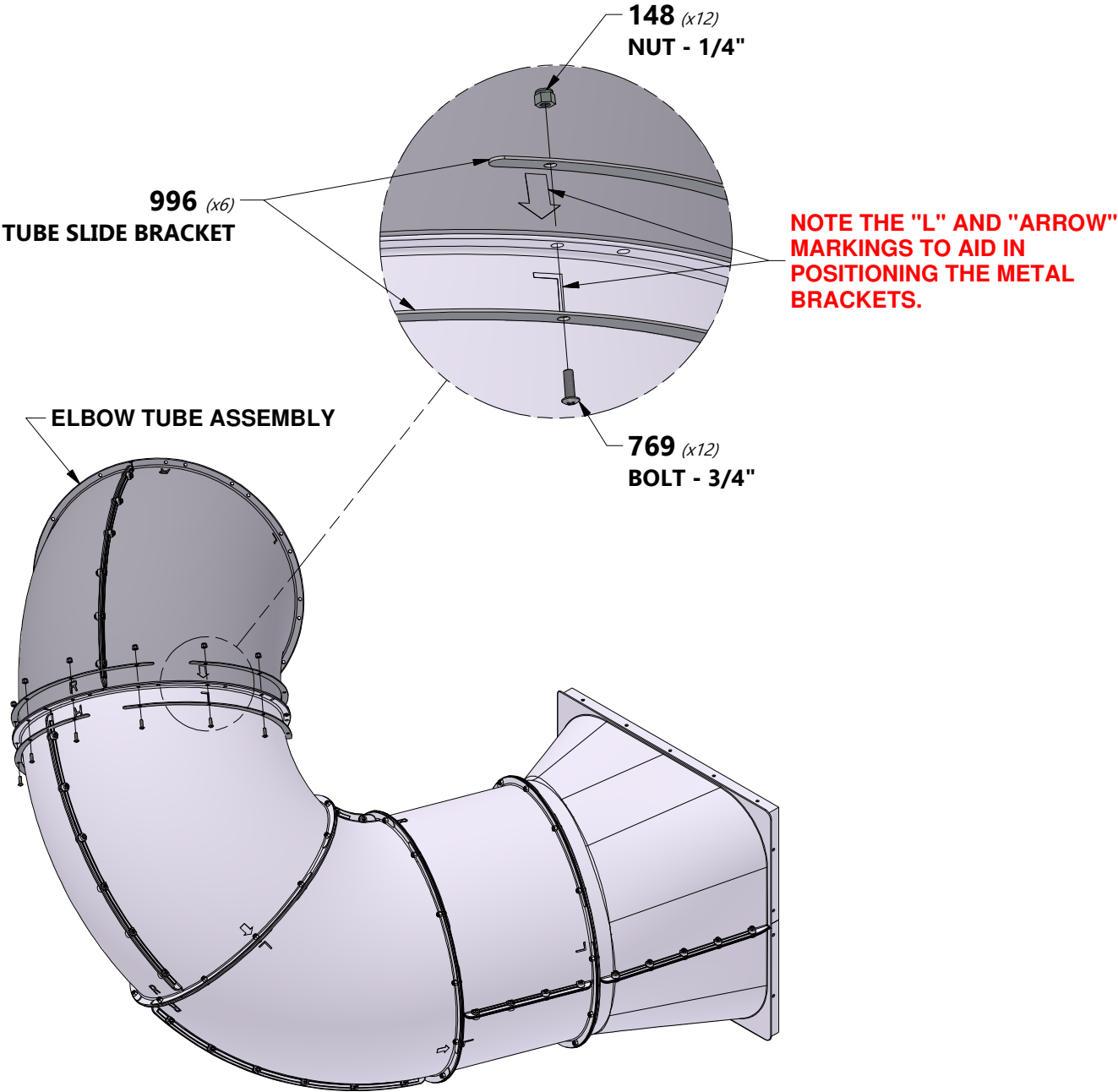

STEP 10 - SLIDE ASSEMBLY

QTY	PART NUMBER	DESCRIPTION
12	H100148	NUT LOCK 1/4
10	H100769	BOLT PTH 1/4x3/4
2	H100795	BOLT PTH 1/4x7/8



ELBOW TUBE ASSEMBLY

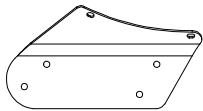
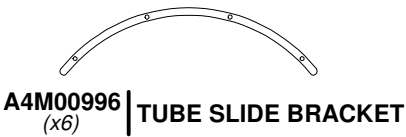

A4M01088 (x1) | TUBE SLIDE BRACKET - LH

- **ALIGN THE 'L' AND THE 'ARROW' TO ACHIEVE THE PROPER POSITION WHEN ASSEMBLING THE SLIDE.**
- **NOTE THIS SECTION ASSEMBLY USES CONFIGURATION 'B' SHOWN IN THE REFERENCE PAGE.**
- **NOTE THE BOLTS USED TO ASSEMBLE THE SLIDE BRACKET ARE 7/8", NOT 3/4".**

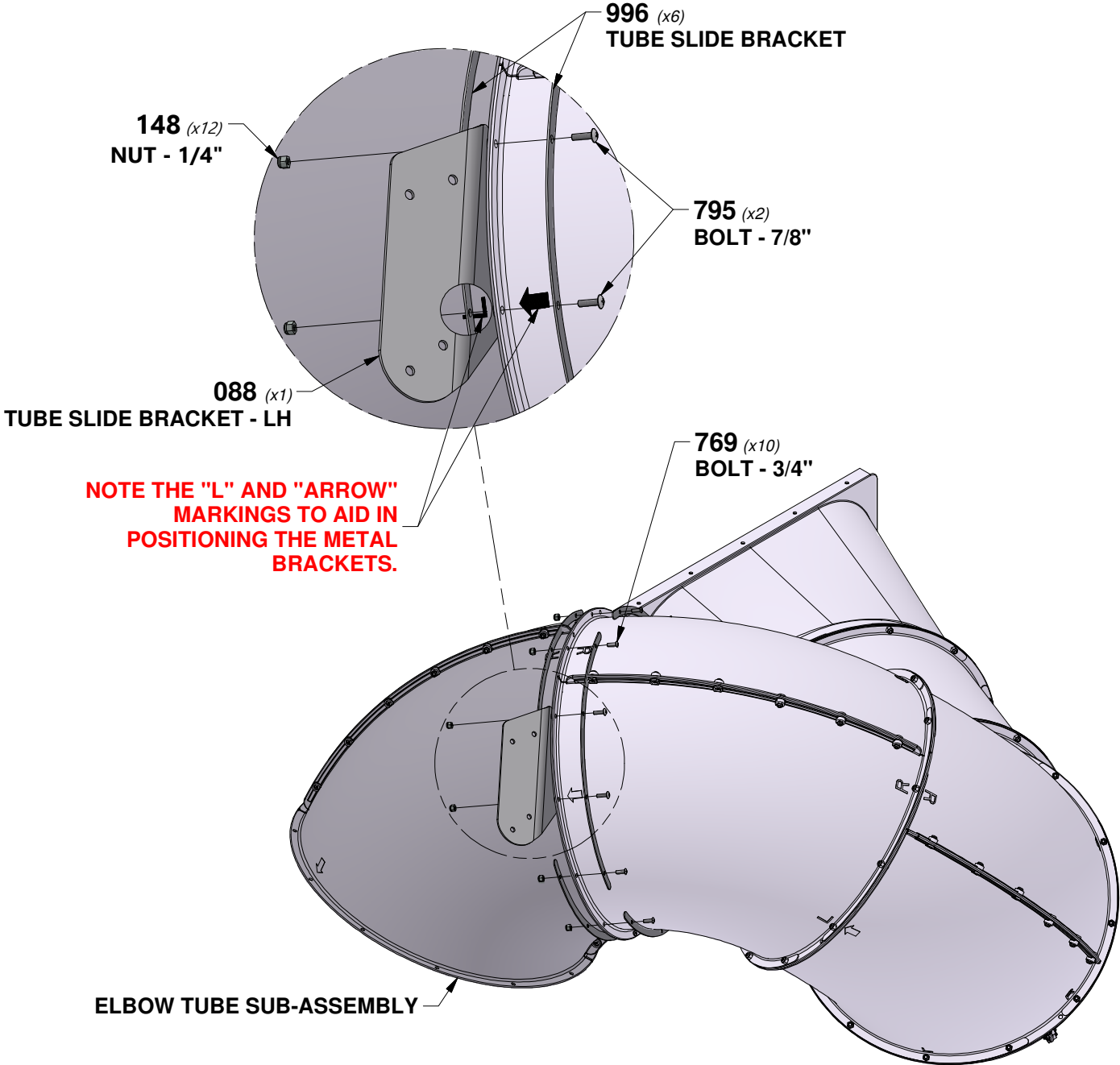

STEP 11 - SLIDE ASSEMBLY

QTY	PART NUMBER	DESCRIPTION
12	H100148	NUT LOCK 1/4
12	H100769	BOLT PTH 1/4x3/4

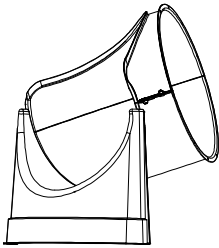

EXIT ASSEMBLY

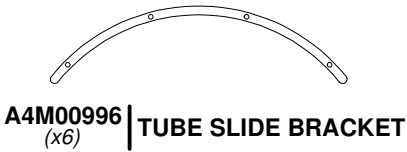

A4M00996 (x6) | TUBE SLIDE BRACKET

- ALIGN THE 'L' AND THE 'ARROW' TO ACHIEVE THE PROPER POSITION WHEN ASSEMBLING THE SLIDE.
- NOTE THIS SECTION ASSEMBLY USES CONFIGURATION 'B' SHOWN IN THE REFERENCE PAGE.

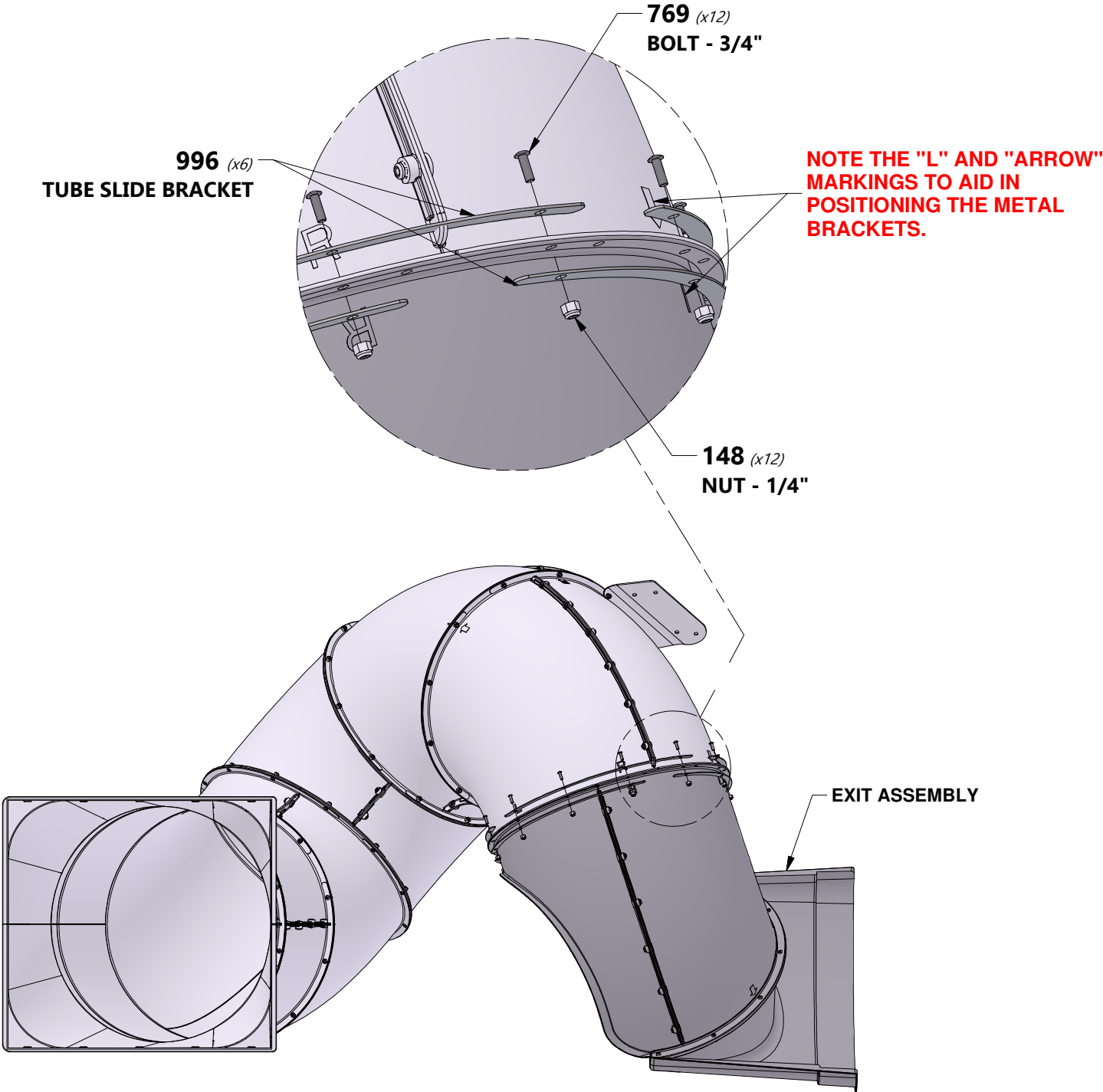

STEP 12 - SLIDE ASSEMBLY



E85 | UPRIGHT - W4L12970
(x1) 1 3/8"x3 3/8"x19 7/8" (36x86x505)



E86 | UPRIGHT - W4L12971
(x1) 1 3/8"x3 3/8"x24 1/2" (36x86x623)



E87 | GROUND BOARD - W4L17063
(x1) 1 3/8"x3 3/8"x14 3/8" (36x86x366)



N87 | SAFETY BOARD - W4L13334
(x1) 5/8"x2 3/8"x12" (16x60x306)

QTY	PART NUMBER	DESCRIPTION
4	H100195	BOLT WH 5/16x2-3/4 BLK
4	H100198	WASHER LOCK EXT 8x19 BLK
2	H100200	SCREW PFH 8x1-1/2 BLK
4	H100379	T-NUT 5/16 BLK

TIP:
INSTALL T-NUTS IN WOOD FIRST

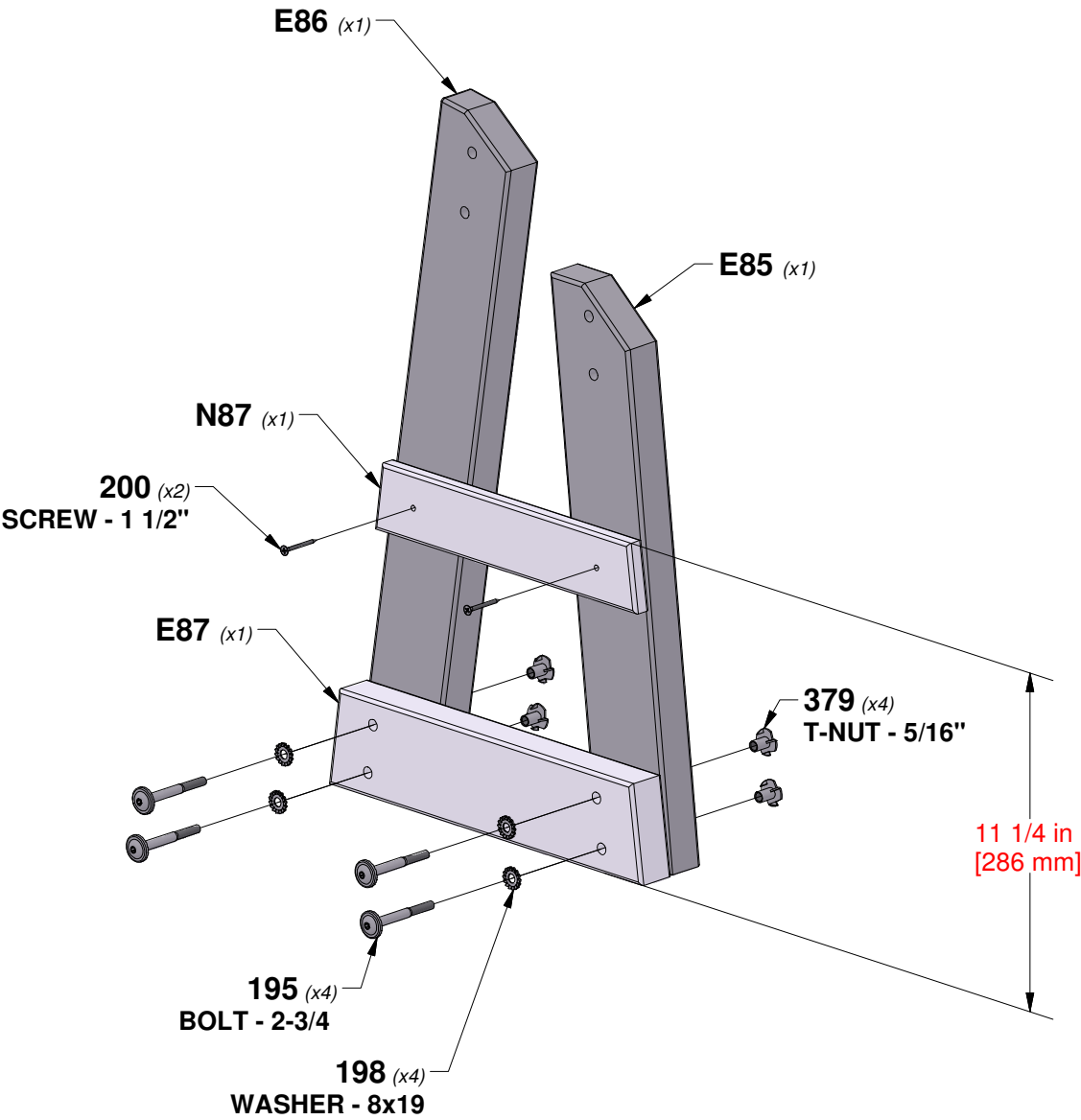

STEP 13 - SLIDE ASSEMBLY

QTY	PART NUMBER	DESCRIPTION
4	H100379	T-NUT 5/16 BLK
4	H100407	BOLT WH 5/16x1 1/2 BLK

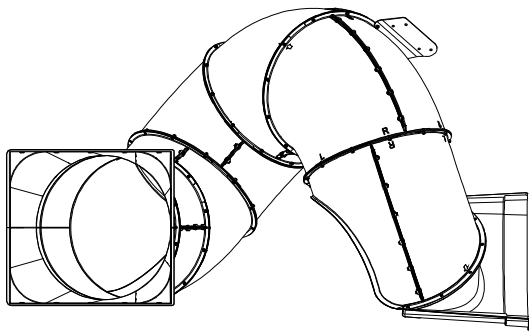

TUBE SLIDE ASSEMBLY

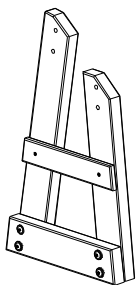

SLIDE BRACE ASSEMBLY

TIP:
INSTALL T-NUTS IN WOOD FIRST

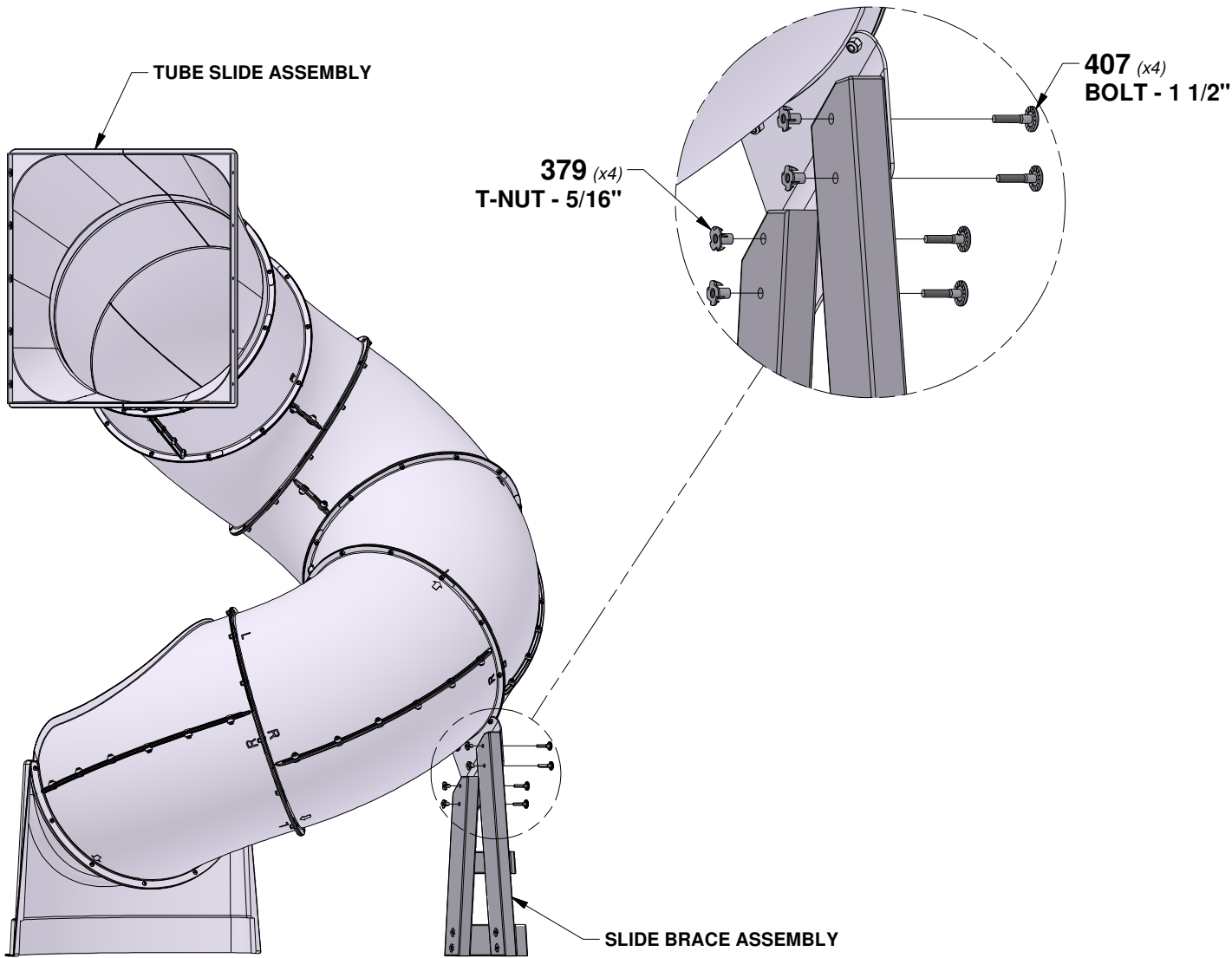

STEP 14 - SLIDE ASSEMBLY

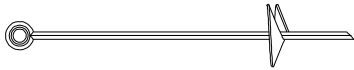

A100178
(x1) | **AUGER GROUND STAKE**

QTY	PART NUMBER	DESCRIPTION
1	H100378	BOLT WH 5/16x1 3/4 BLK
1	H100379	T-NUT 5/16 BLK

TIP:
INSTALL T-NUTS IN WOOD FIRST

TWIST GROUND STAKE INTO GROUND AT LOCATION SHOWN, USING GROUND STAKE AS A GUIDE, DRILL (1) 3/8" [10 mm] HOLE FOR HARDWARE.

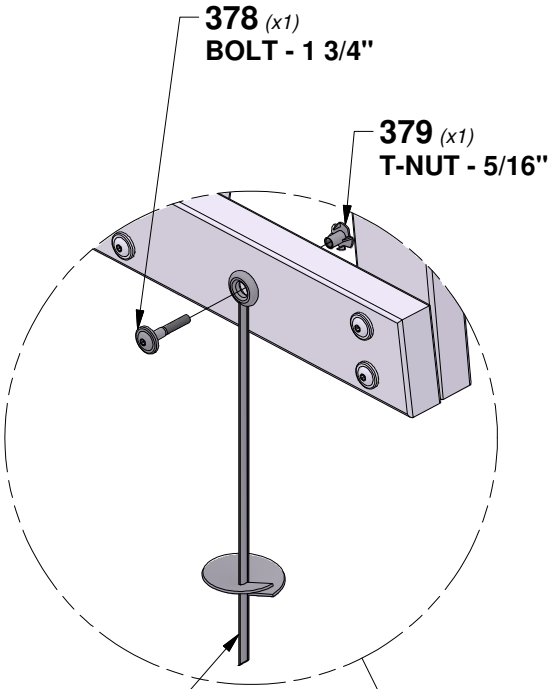

178 (x1)
AUGER GROUND STAKE

